

Euromas II

Enclosure, polycarbonate



EM 238

Order no.: 62238000

* = Available on request.

Characteristics

Colour of enclosure group

Light grey

Protection class

IP 65

Enclosure Material

ABS, PC (UV stabilised); seal made of CR; for details see Technical Information

Scope of delivery

Lid and base, self-tapping coarse-pitch thread lid screws made of V2A

Dimensions

Dimensions

160 x 120 x 92 mm

Product drawing

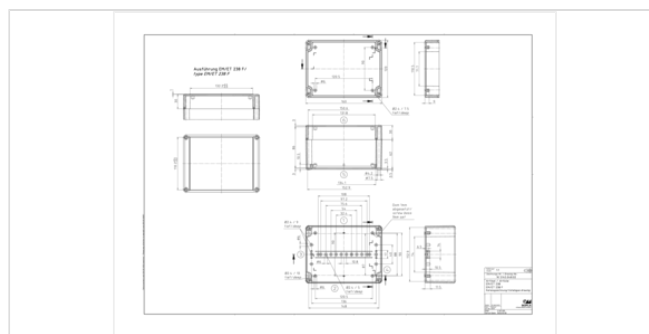

Technical documentation / Downloads

Technical drawings

3D product data in STEP format: 62238000 EM-238.stp (1.5 MB)

Drawing for mechanical processing: 62238000 EM-238-G.dxf (843.2 KB)

Milling contours are shown here as a DXF file. (Sub D, USB, HDMI, cable glands, ...)

Product drawing in PDF format: 62238000 EM-238.pdf (90.4 KB)

Product drawing in DXF format: 62238000 EM-238.dxf (950.9 KB)

Product information

euromas-ii en.pdf (1.0 MB)

Important!

To compensate for pressure when temperatures change and cause moisture in the enclosure, we recommend that you use a pressure compensation element.

» Additional information

Matching accessories



Rubber feet

22009000 GF

Polyurethane, 65-75 Shore

Black



Mast mounting, stainless steel V2A, uncoated

96500122 MH 122

96500167 MH 167



DIN rails DIN EN 60715 TH 15, galvanised steel

22151501 TS 15.150.1

For EM/ET 220, EM/ET 229-231, EM/ET 238, B 1808., B 1813..



DIN rails DIN EN 60715 G 32, galvanised steel

22321501 TS 32.150.1

For EM/ET 220, EM/ET 229-231, EM/ET 238, B 1808., B 1813..



DIN rails DIN EN 60715 TH 35, galvanised steel

22351501 TS 35.150.1

For EM/ET 220, EM/ET 229-231, EM/ET 238, B 1808., B 1813..

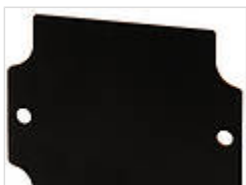

Mounting panels, laminated paper

22001100 M

For EM/ET 238, M/T 238, M/T 246



Wall brackets, screw-on at rear

22010000 EM-WL



Screw covers

22080000 EM-SA

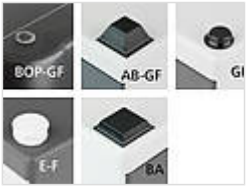

Universal rubber feet for stability of the enclosures on all surfaces

35800300 BOP-GF

Polyurethane, 65-75 Shore

Transparent



Screws (SHR) and distance bolts (DIBLZ) for mounting bosses in plastic enclosures

59006219 SHR Z KA30x6

SD = 3.0 / ND = 2.4-2.6 / KD = 5.3