

SHIELDED SMD POWER INDUCTORS / SRI TYPE

FEATURES

- ◆ Excellent solder ability and high heat resistance for flow soldering.
- ◆ For large current circuits due to its low DC resistance.
- ◆ Excellent in terminal strength due to its high performance ferrite core material and solder ability.



APPLICATIONS

- ◆ LCD TV & Notebook
- ◆ DC/DC converter
- ◆ Power supplies for portable communication equipment

ORDERING CODE

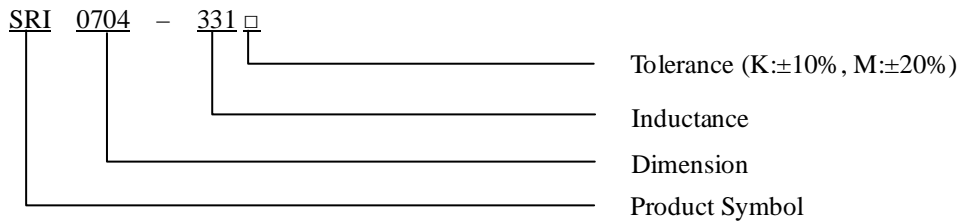

DIMENSIONS (UNIT: mm)

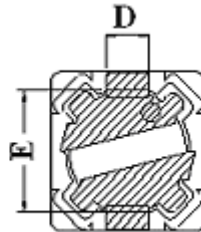
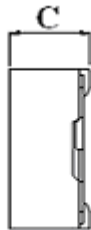
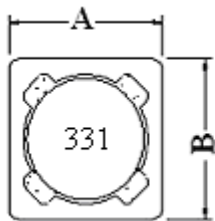

A	7.3 ± 0.3	m/m
B	7.3 ± 0.3	m/m
C	4.5 (MAX)	m/m
D	2.0 (REF)	m/m
E	5.0 (REF)	m/m



CORE MASTER ENTERPRISE CO., LTD.

<http://www.coremaster.com.tw>

SHIELDED SMD POWER INDUCTORS / SRI TYPE

ELECTRICAL CHARACTERISTICS FOR SRI0704

Part No.	Inductance (uH)	RDC (Ω)	IDC (A)
SRI0704-1R0 □	1.0	0.015	9.00
SRI0704-1R2 □	1.2	0.025	8.00
SRI0704-1R5 □	1.5	0.026	8.00
SRI0704-1R8 □	1.8	0.028	7.00
SRI0704-2R2 □	2.2	0.030	6.20
SRI0704-2R7 □	2.7	0.035	5.50
SRI0704-3R3 □	3.3	0.038	4.70
SRI0704-4R7 □	4.7	0.047	3.50
SRI0704-6R2 □	6.2	0.050	3.40
SRI0704-6R8 □	6.8	0.050	3.40
SRI0704-7R0 □	7.0	0.052	3.30
SRI0704-7R7 □	7.7	0.053	3.10
SRI0704-100 □	10	0.055	3.00
SRI0704-150 □	15	0.081	2.50
SRI0704-180 □	18	0.100	2.00
SRI0704-220 □	22	0.110	1.95
SRI0704-270 □	27	0.128	1.50
SRI0704-330 □	33	0.250	1.20
SRI0704-390 □	39	0.300	1.10
SRI0704-470 □	47	0.320	1.00
SRI0704-560 □	56	0.350	1.00
SRI0704-680 □	68	0.380	0.90
SRI0704-101 □	100	0.610	0.85
SRI0704-121 □	120	0.850	0.85
SRI0704-151 □	150	0.880	0.75
SRI0704-171 □	170	1.300	0.74
SRI0704-181 □	180	1.350	0.70
SRI0704-221 □	220	1.400	0.62
SRI0704-271 □	270	1.500	0.55
SRI0704-331 □	330	1.500	0.50



CORE MASTER ENTERPRISE CO., LTD.

<http://www.coremaster.com.tw>

SHIELDED SMD POWER INDUCTORS / SRI TYPE

ELECTRICAL CHARACTERISTICS FOR SRI0704

Part No.	Inductance (uH)	RDC (Ω)	IDC (A)
SRI0704-391 □	390	1.800	0.48
SRI0704-471 □	470	2.600	0.40
SRI0704-561 □	560	2.700	0.40
SRI0704-681 □	680	3.700	0.38
SRI0704-821 □	820	4.500	0.32
SRI0704-102 □	1000	5.000	0.22
SRI0704-152 □	1500	5.100	0.22

* 100uH 以上 Test Frequency : 1KHZ/1V

* 100uH 以下 Test Frequency : 100KHZ/0.1V



CORE MASTER ENTERPRISE CO., LTD.

<http://www.coremaster.com.tw>