

DETAILS

Product Number	FCN14386_ANGELINA-XW
Family	ANGELINA
Type	RefPack
Color	white
Diameter	82 mm
Height	36.24 mm
Style	round
Optic Material	HRPC
Holder Material	PC
Fastening	screw
Status	ready
ROHS Compliant	Yes
Date Updated	26/05/2014

OPTICAL PROPERTIES

LED	Viewing Angle	Light Beam	Efficiency	cd/lm	Connector
CXA15xx	94 deg	Wide	94 %	0.530	LEDiL: LEDiL
CXA1816/CXA1820/CXA1850	94 deg	Wide	94 %	0.500	LEDiL: LEDiL



H G F E D C B A

4

4

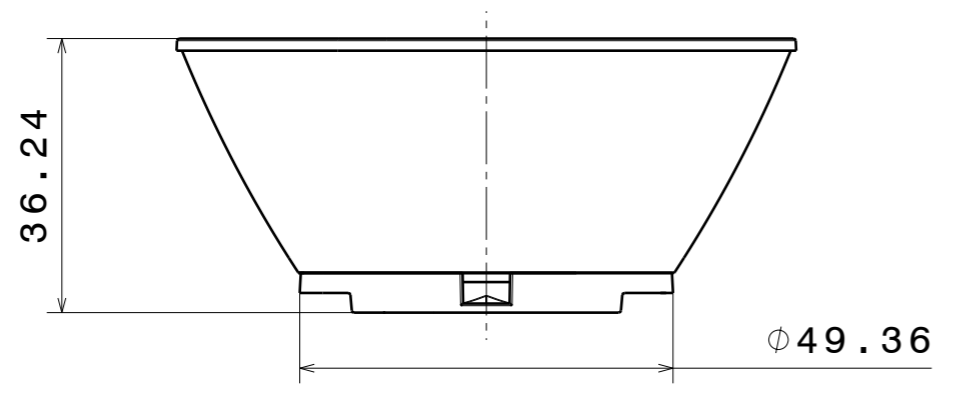

Reflector

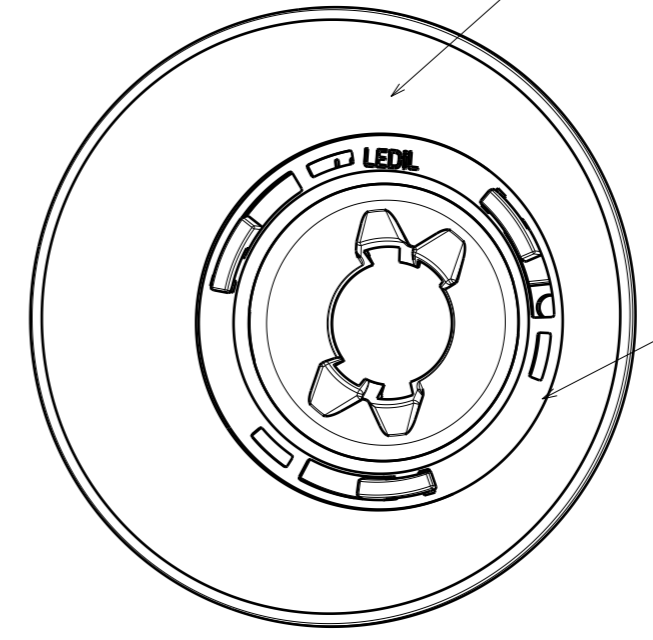

Socket

3

3

LED position

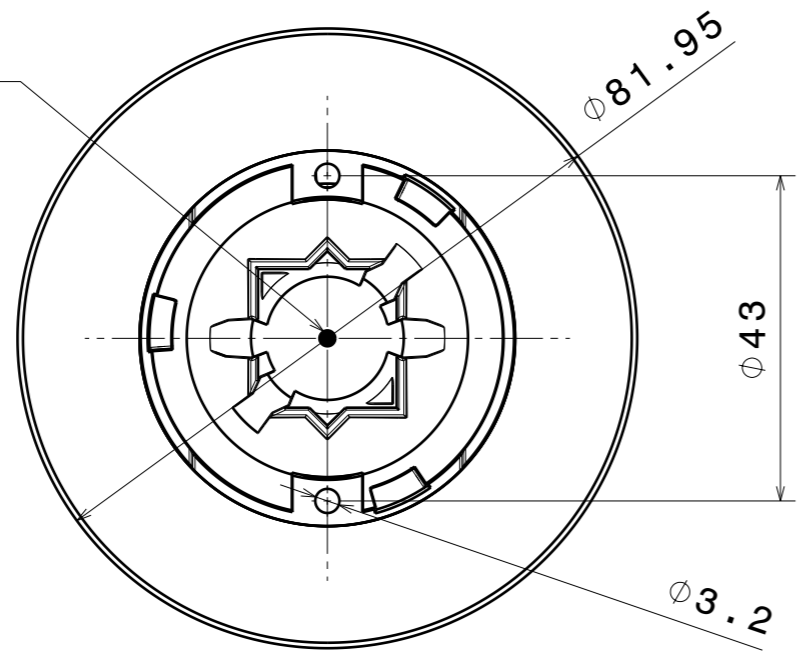

2

2

INDEX	PART NO	MATERIAL	COLOUR
1	Socket	PC	White
2	Reflector	PC	White

Tolerances if not otherwise shown
 According to DIN ISO 2768-1
 Linear measures: class C
 According to DIN ISO 2768-2
 Form and position: class L

LEDiL LediL Oy
 Salorankatu 10
 FIN 24240 SALO
 Finland

THIRD ANGLE PROJECTION:

DRAWING TITLE
FCN14386_ANGELINA-XW

This drawing is the property of LEDiL Oy. It may not be reproduced, copied or communicated without a written agreement with LEDiL Oy.

SIZE	PART NUMBER
A3	FCN14386

SCALE	1:1	WEIGHT	-	SHEET	1/1
-------	-----	--------	---	-------	-----

H G B A

1

1

Luminaire: LEDil Oy FCN14386_ANGELINA-XW_(CXA1507) Efficiency=94%
Lamps: 1 x Cree CXA1507 (CXA1507-30F-F4-N0H-00000) 212lm @ 50mA CCT=3100K P=1.7W I=50mA

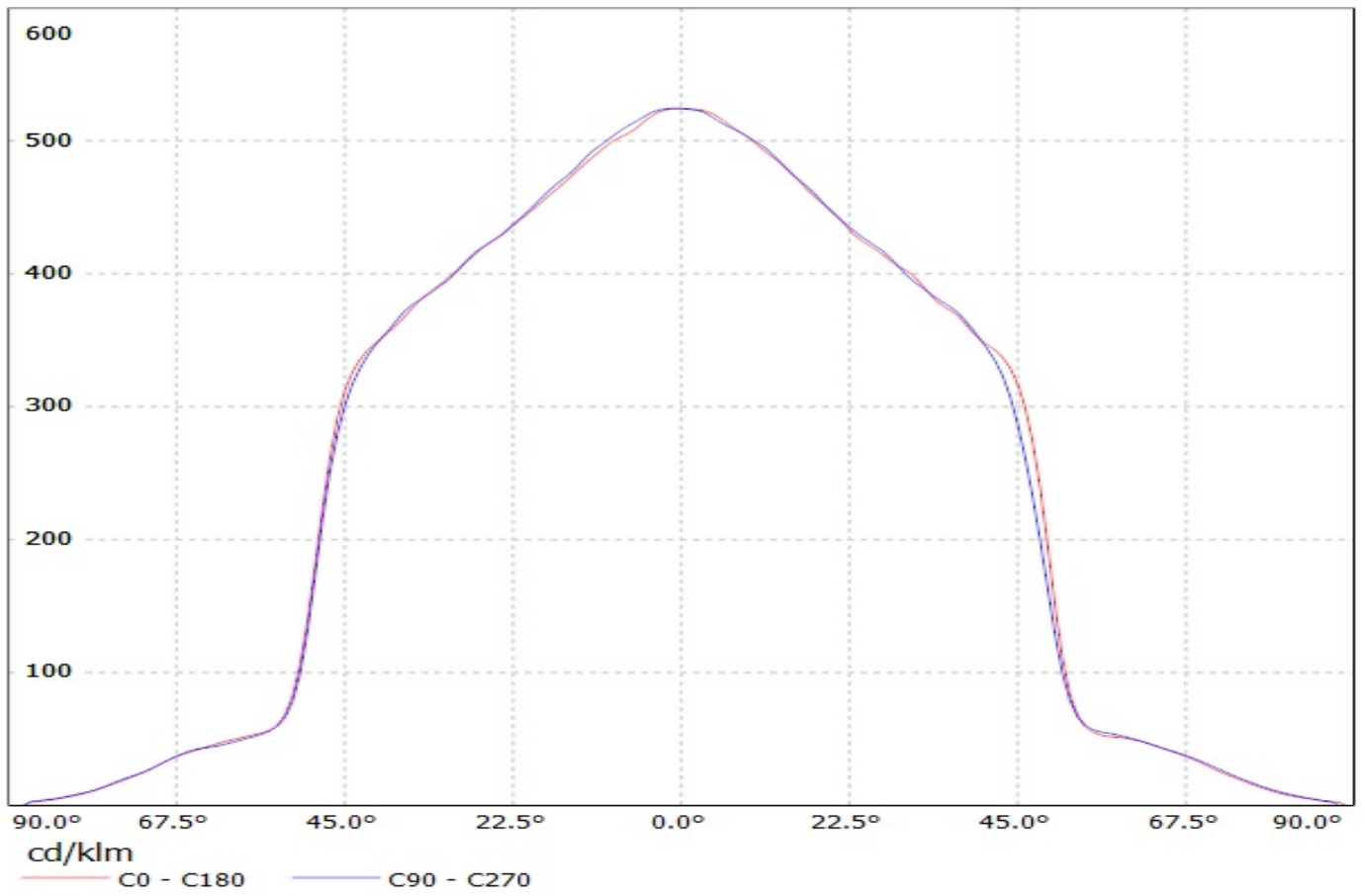

Luminaire: LEDil Oy FCN14386_ANGELINA-XW_(CXA1816) Efficiency=94%
Lamps: 1 x Cree CXA1816 (988lm @ 250mA) CCT=3200K P=8.8W I=250mA

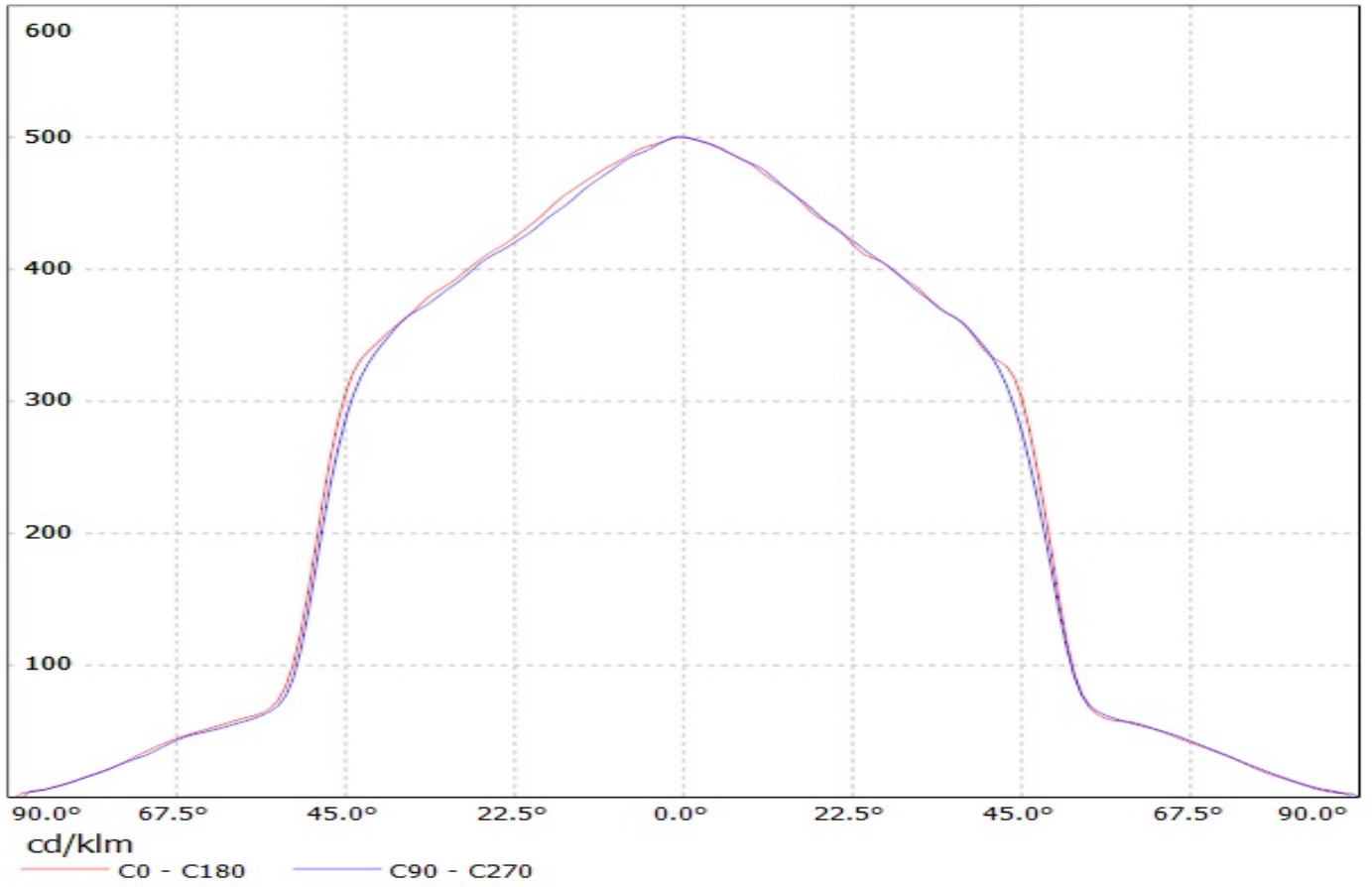

Luminaire: LEDil Oy FCN14386_ANGELINA-XW_(CXA1507) Efficiency=94%
Lamps: 1 x Cree CXA1507 (CXA1507-30F-F4-N0H-00000) 212lm @ 50mA CCT=3100K P=1.7W I=50mA

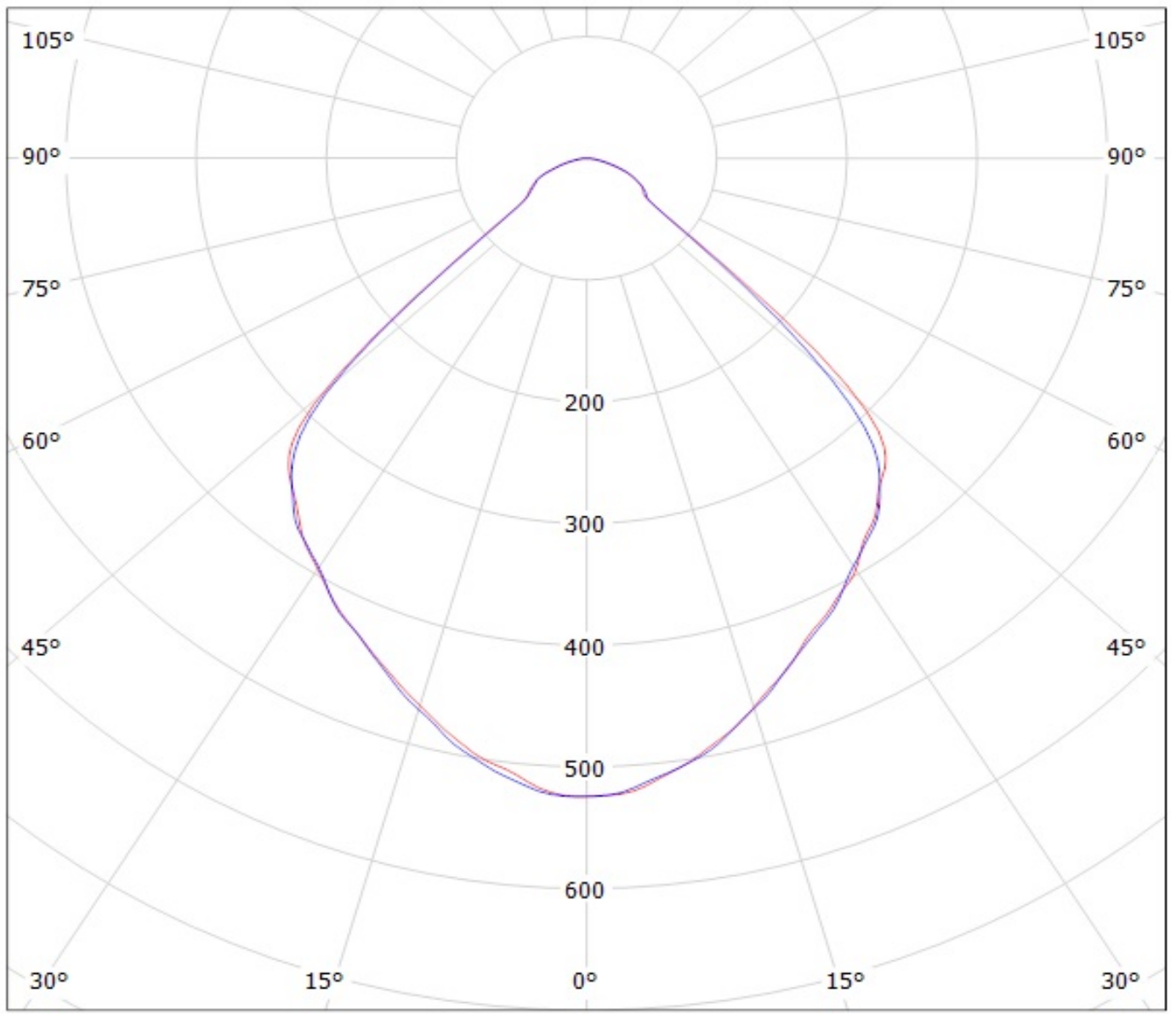

cd/klm
— C0 - C180 — C90 - C270

Luminaire: LEDil Oy FCN14386_ANGELINA-XW_(CXA1816) Efficiency=94%
Lamps: 1 x Cree CXA1816 (988lm @ 250mA) CCT=3200K P=8.8W I=250mA

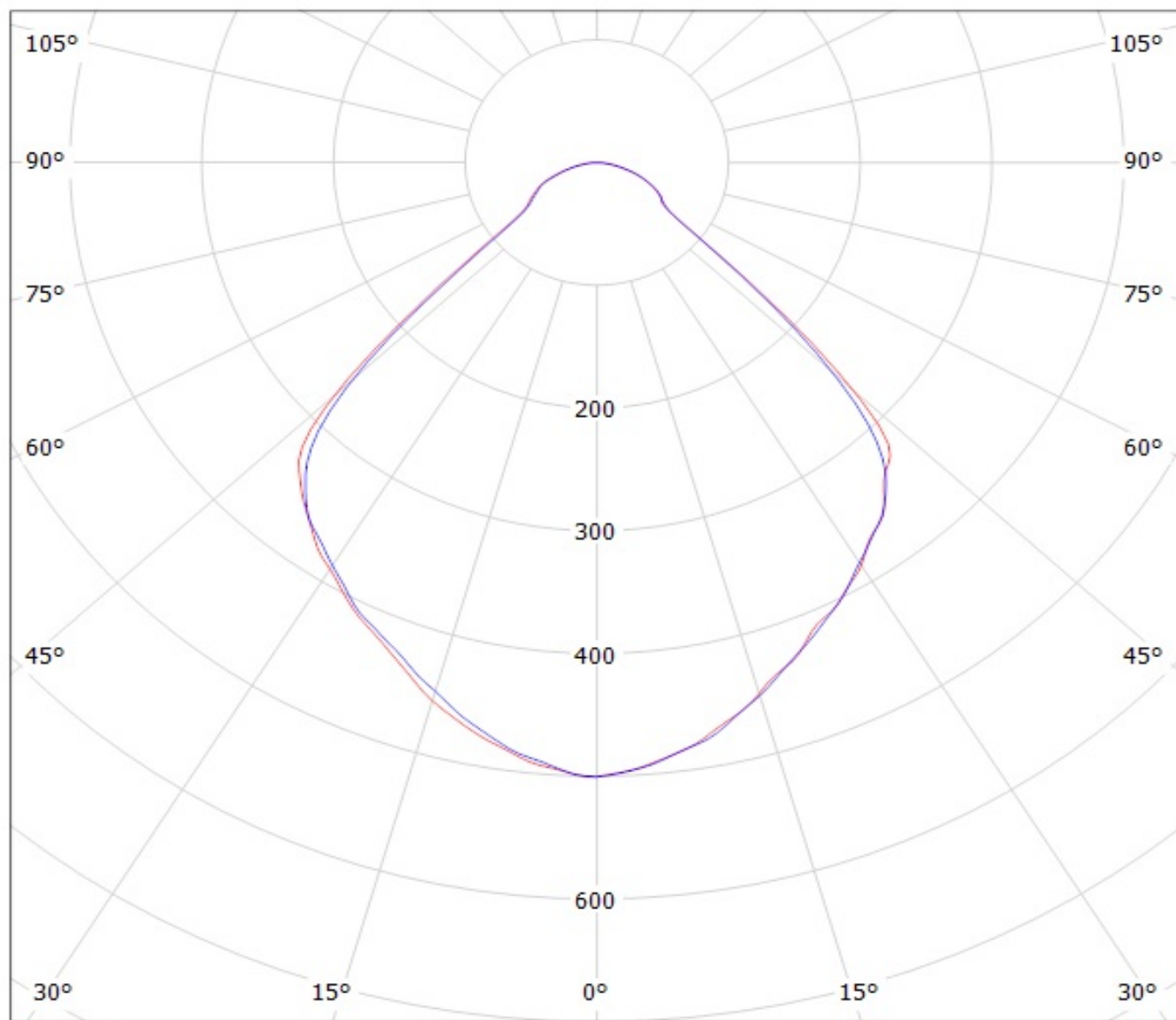

cd/klm

— C0 - C180

— C90 - C270

NOTE: The typical divergence will be changed by different color, chip size and chip position tolerance. The typical total divergence is the full angle measured where the luminous intensity is half of the peak value.

GENERAL INFORMATION

- Product series especially designed & optimized for series of LEDs.
- Special care taken to make light distribution as uniform as possible.
- Reflector is made of aluminium coated PC (120 degrees of Celcius / 248 degrees of Fahrenheit) with protective lacquer (short term 100 degrees of Celcius / 212 degrees of Fahrenheit).

Note! Due to use of high power COB's with this product, special attention to proper thermal design is highly recommended. LEDiL has no liability for direct, indirect or consecutive damages arising from the LEDiL products being used outside of the recommended temperature range.