



ZIPPY TECHNOLOGY CORP.



10F, NO.50, MIN CHYUAN ROAD,  
SHIN-TIEN CITY, TAIPEI COUNTY,  
TAIWAN, R.O.C

TEL: 886-2-2918-8512 / 886-2-2918-0603  
FAX: 886-2-2915-5765 / 886-22916-0215  
[Http://www.zippy.com.tw](http://www.zippy.com.tw)

### APPROVED DATA SHEET



-----  
**Model: 1000490075(RE-12S-A2BA-1-Z)**  
=====

ISSUED DATE: AUG.17.2011  
APPROVED NO.: 1000490075.E  
PAGE: 1/5

The undersigned guarantee of the model switches is meets the following specifications.

#### 1.Operation Characteristics

Operating Force (OF) : Max. 700 gf

#### 2. Specifications

- Initial Contact Resistance : Max. 50 mΩ . ( Measured by ohm meter –Open Voltage<1VDC, Driver current -100mA )  
Before measure the switch contact resistance, please press the switch three times on and off.
- Initial Dielectric Strength : 1,000VAC(50-60HZ)/minute between contacts.  
3,000VAC(50-60HZ)/minute between Live-parts and dead metal parts.
- Insulation Resistance : Min. 100 MΩ ( 500 VDC/ minute ) between Live-parts and dead metal parts.
- Circuit Arrangement : SPST ( Single pole single throw )
- Rating : 12A 250VAC
- Service Life : Min. 10,000 operations.
- Rating Load : Resistive Load.
- Operating Frequency : 10~30 operations per minute.
- Safety Certificate : UL, CSA, ENEC14
  
- Mechanical Service Life : Min. 10,000 operations.
- Operating Frequency : Max. 30 operations per minute.



10F, NO.50, MIN CHYUAN ROAD,  
SHIN-TIEN CITY, TAIPEI COUNTY,  
TAIWAN, R.O.C

TEL: 886-2-2918-8512 / 886-2-2918-0603  
FAX: 886-2-2915-5765 / 886-22916-0215  
[Http://www.zippy.com.tw](http://www.zippy.com.tw)

## APPROVED DATA SHEET



-----  
**Model: 1000490075(RE-12S-A2BA-1-Z)**  
=====

ISSUED DATE: AUG.17.2011  
APPROVED NO.: 1000490075.E  
PAGE: 2/5

### 3. Environments

Operating Temperature	:	-25°C ~ 85°C(With no icing)
Storage Temperature	:	-25°C ~ 85°C(With no icing)
Storage Humidity	:	at 40°C, Max. 85% R.H
Vibration Resistance	:	10~55Hz, displacement 0.75mm(p-p)
Shock Resistance	:	Destruction: 1,000 m/s <sup>2</sup> {approx. 100G} max. Malfunction: 300 m/s <sup>2</sup> {approx. 30G} max.
Soldering by hand	:	260°C maximum within 5 seconds.
Soldering bath	:	260°C maximum within 5 seconds.

Note: The button need to print “” mark

ZIPPY TECHNOLOGY CORP.

卓妍蓁

-----  
PREPARED

沈俊榮

-----  
CHECKED

陳立業

-----  
APPROVED

# Dimensions drawing

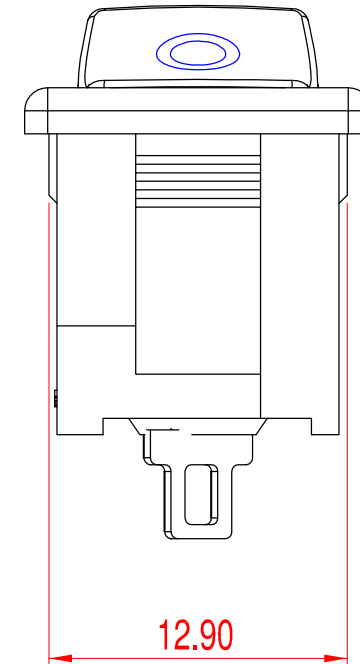
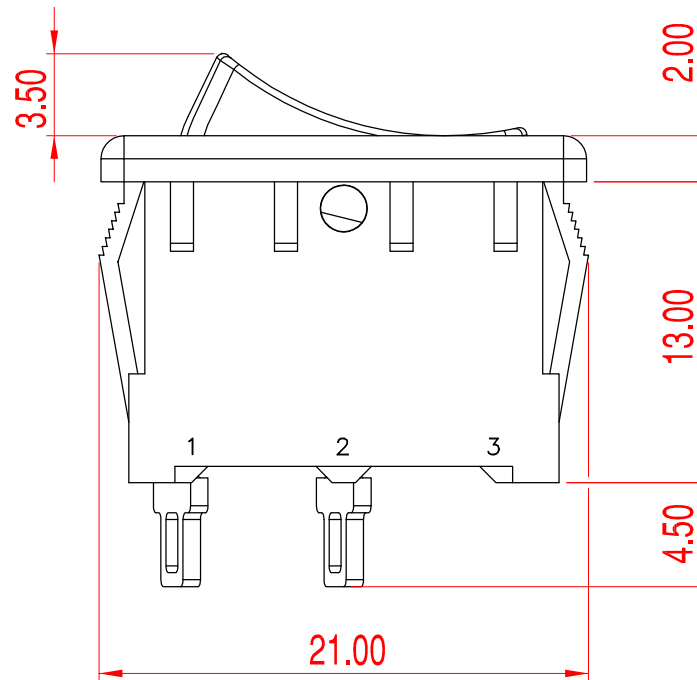
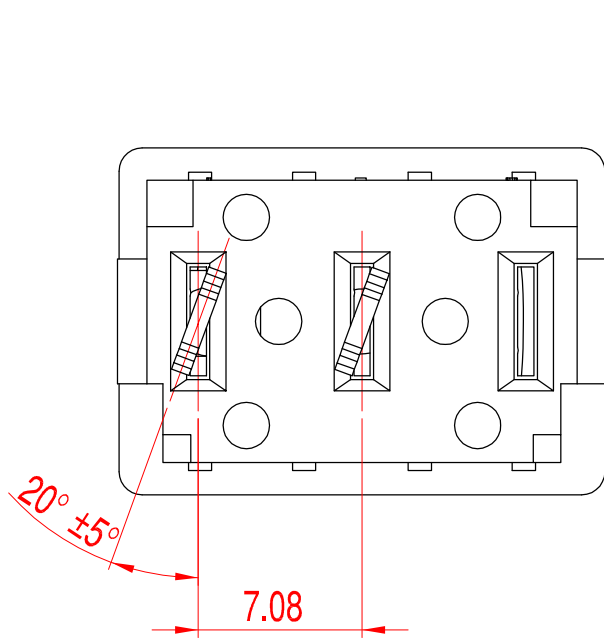
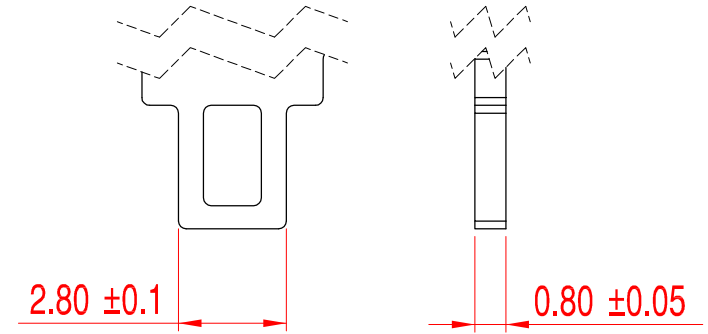
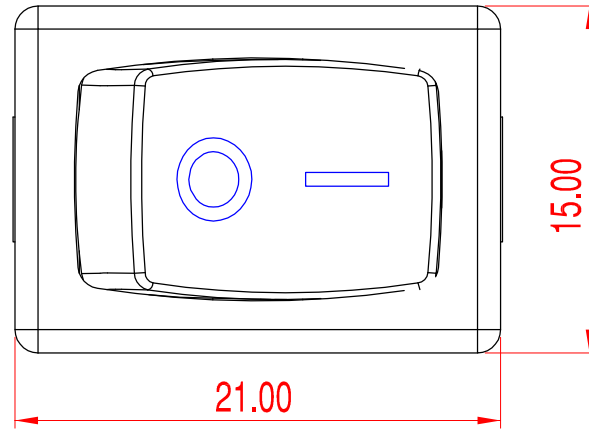

Tolerance	
± 0.4	

VIEW		SIZE	A4	UNIT	mm
DATE	AUG-17-2011	VER.	1.7	FILE NAME	RE-A2A-1
APPROVAL	李金龍	CONFIRM	陳立業	DESIGN	陳京凡

# Marking drawing

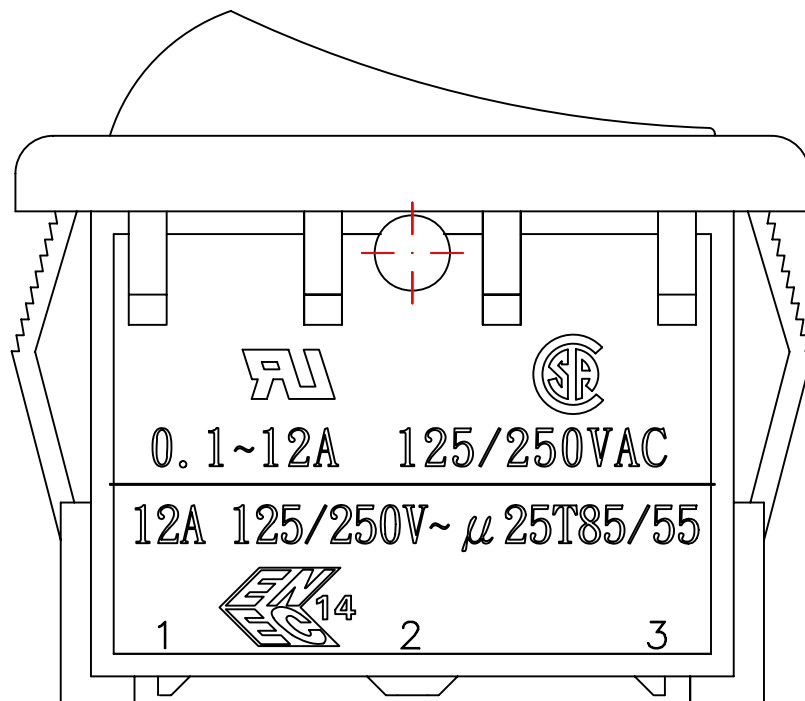

△	DATE	APPROVAL	DESIGN	ENGINEERING CHANGE DESCRIPTION	VIEW	SIZE	A4	UNIT	mm	
新巨企業股份有限公司				<b>ZIPPY</b> TECHNOLOGY CORP.	DATE	JUN-30-2008	VER	1.0	FILE NAME	RE-12
					APPROVAL	陳立業	CONFIRM	張哲維	DESIGN	林佩貞

# Button print drawing

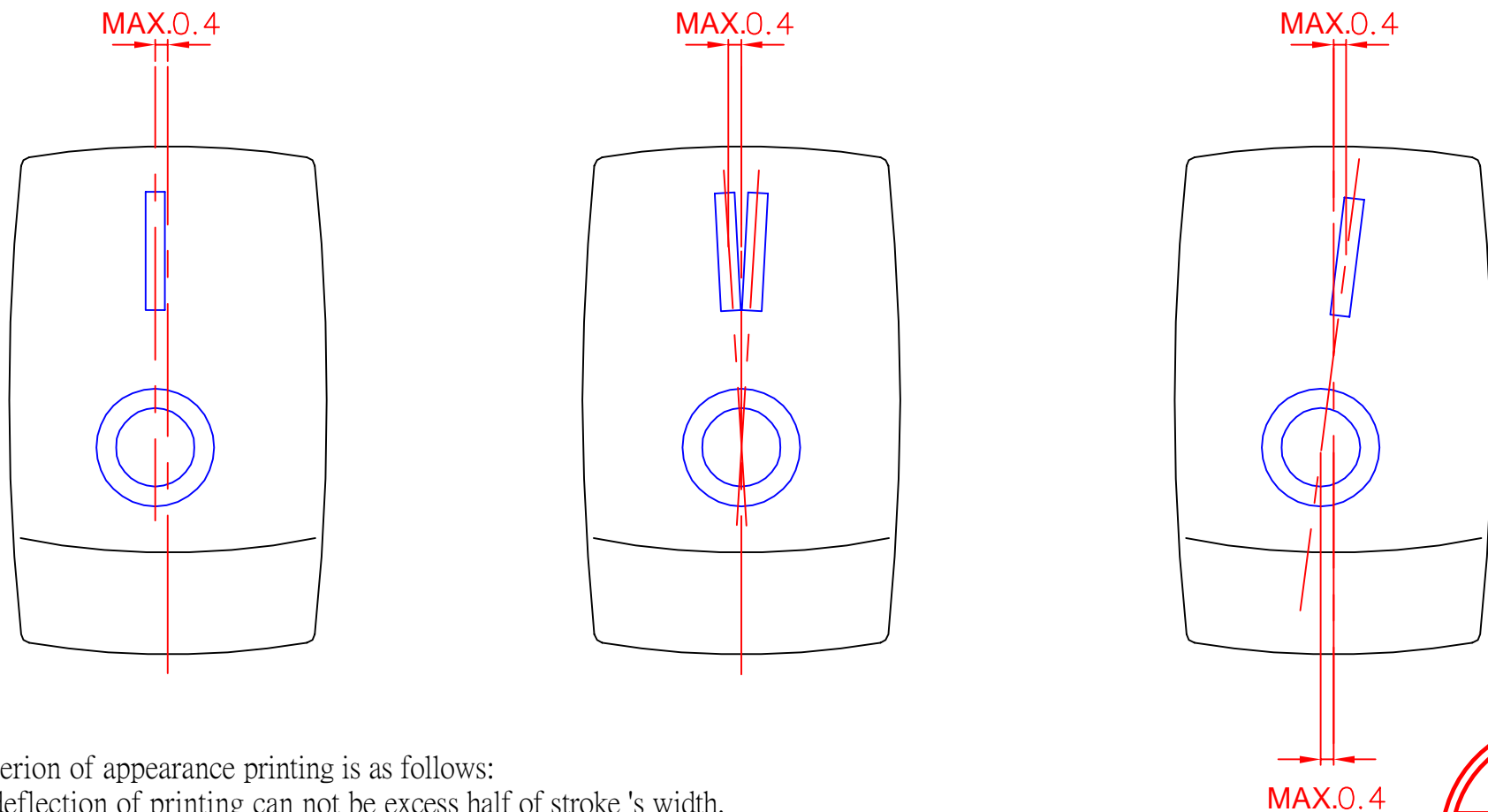

The criterion of appearance printing is as follows:

- A. The deflection of printing can not be excess half of stroke 's width.
- B. Within 5mm printing section, it is acceptable if there are two of 0.15mm contaminations or one of 0.2mm contamination.
- C. The printing should be clear and complete. (It is not acceptable if missing paint is more than 1/3 of stroke's width)
- D. Diffusion of the printing can't more than 1/3 time of stroke's width.
- E. The limitation of scrape:
  - length : within 2mm
  - width : within 0.2mm



VIEW		SIZE	A4	UNIT	mm
DATE	JUN 17 2011	VER.	1.1	FILE NAME	RE-1
APPROVAL	李金龍	CONFIRM	陳立業	DESIGN	沈俊榮