

CS21 Series 1.27mm(.050") DIP PLCC Chip Carrier Socket

- ⊙ With standoff prevent flux wicking
- ⊙ Low cost and reliable
- ⊙ Insulator: Glass filled polyester
- ⊙ Contact: Tin plated Phosphor Bronze

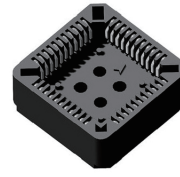

RoHS Compliant

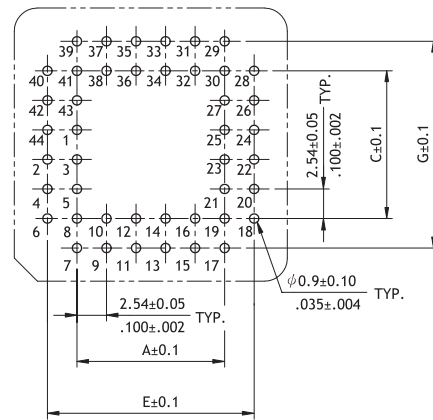
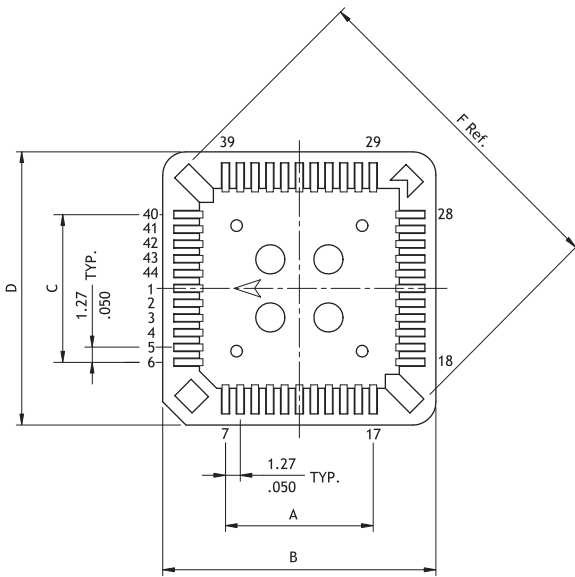

Recommended P.C. Board Layout

Available for 20,28,32,44,52,68,84 Circuits

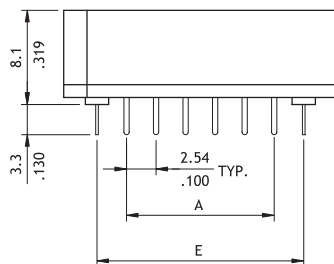

Circuits	Dimension						
	A	B	C	D	E	F	G
20	5.08(.200)	15.5(.610)	5.08(.200)	15.5(.610)	10.16(.400)	16.8(.661)	10.16(.400)
28	7.62(.300)	18.0(.709)	7.62(.300)	18.0(.709)	12.70(.500)	20.7(.815)	12.70(.500)
32	10.16(.400)	20.6(.811)	7.62(.300)	18.0(.709)	15.24(.600)	22.6(.890)	12.70(.500)
44	12.70(.500)	23.5(.926)	12.70(.500)	23.5(.926)	17.78(.700)	28.4(1.118)	17.78(.700)
52	15.24(.600)	25.9(1.020)	15.24(.600)	25.9(1.020)	20.32(.800)	31.7(1.248)	20.32(.800)
68	20.32(.800)	31.66(1.246)	20.32(.800)	31.66(1.246)	25.40(1.000)	39.2(1.543)	25.40(1.000)
84	25.40(1.000)	36.66(1.443)	25.40(1.000)	36.66(1.443)	30.48(1.200)	46.2(1.819)	30.48(1.200)

Ordering Code

① CS 2 1 ② 8 4 ③ 1 ④ 1 ⑤ 0 0 0

- ① Series No.
- ② No. of Circuits: See above table
- ③ Plating Code: 1 = Tin over Nickel
- ④ Color: 1 = Black (PBT)
0 = Nature (PPS)
- ⑤ Other Options:
000 = PBT (Standard)
A00 = PPS
*Special options consult manufacturer