

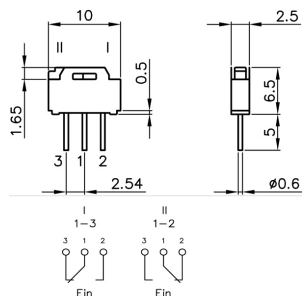

## Slide switches

S - 254 -

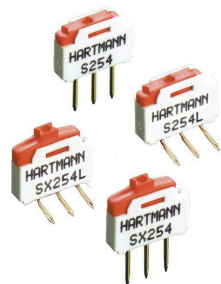

- miniature slide switches with 3 pin connection
- can be used as ON/OFF-switches or CHANGE-OVER-switches
- end-stackable in 2.54mm pitch
- solder and flux sealed base
- gold plated roller contacts ensure safe switching even at low currents
- robust and reliable switches despite of miniature size
- high-end alternative to jumpers
- can also be used as address switch for applications requiring a limited quantity of addresses

Despite their miniature size these switches are robust and reliable. Gold plated roller contacts guarantee secure switching even for low currents. There are multiple applications in industry as well as in consumer electronics. The switches are a High-End alternative to jumpers and also work as address switches for applications requiring a limited quantity of addresses.

### Electrical Data

Operating voltage	12 V
Contact load, dyn	0.5 A
Minimum voltage	10 mV
Minimum load	1 mA
Insulation resistance	10 000 M $\Omega$ min.at 500VDC
Initial contact resistance	20 m $\Omega$ max.
Dielectric strength	
- between terminals	250 Vrms, 50Hz
- between pins of stacked switches	2 000 Vrms, 50Hz min
Electrical lifetime with nominal load	2 000 cycles
Capacitance	< 1.5 pF

### Mechanical Data

Fixation mode	THT
Pitch	2.54 mm
Travel	1.6 mm
Perm. ambient temperature	-40 ... +85 °C
Humidity	21 days at 95%RH (DIN IEC 60068-2-3)
Soldering temperature	max. 250 °C/5s
Wave soldering	base solder and flux sealed

### Material

Case	PBT, glass filled (UL94-V0)
Actuator	PBT, glass filled (UL94-V0)
Contacts	Au over Ni

### Configuration

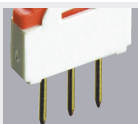
Actuator	 Standard actuator
Pitch	2.54mm
Terminals	 Straight