

Rotary Code Switch

P36THR 1 01 L254 -

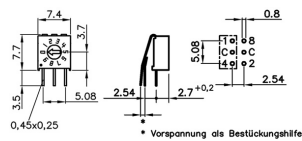
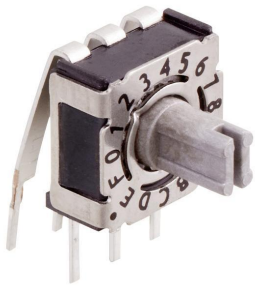

- solid PCB pins
- contacts with abrasion resistant hard gold plating
- extra sealed design with high temperature resistance
- switches are solder and flux sealed and washable
- 100% electronic final inspection and testing
- 90° turned zero position available

Solid PCB pins ensure trouble-free assembly and safe connection. Contacts with abrasion resistant hard gold plating have low and stable contact resistance. ISO 9001:2008 approved production together with 100% electronic final inspection and testing guarantee reliable operation. Figures are clearly visible and detention mechanism is precise for fast and easy operation. Many special designs are available on request or can be built according to customer's specification.

Electrical Data

Operating voltage	≤ 42 V
Contact load, static	≤ 0.4 A
Contact load, dynamic	≤ 0.1 A
Minimum load	1µA 20mVDC
Test voltage	250V 50Hz/1min
Contact resistance	< 80 mΩ
Insulation resistance	> 100 MΩ

Mechanical Data

Type	vertical
Fixation mode	THR
Height	7.7 mm
Length	5.24 mm
Width	7.4 mm
Pin connection	3+3
Perm. ambient temperature	-50 ... +125 °C
Perm. storage temperature	-55 ... +135 °C
Torque	1.2 +/-0.2 Ncm
Max. mech. lifetime	25 000 steps
Positions per rotation	10, 16, more versions on request
Degree of protection	comparable IP67
Sealing	O-Ring
Humidity	21 days at 40°C, 93%RH

Other Data

Reflow soldering	10s/260 °C
Wave soldering	5s/280 °C
Iron soldering	4s/350 °C

THR

THR through holes	plated through
THR PCB hole diameter	0.8 mm
Outside diameter plated land	1.8 mm

Schock- und Vibrationstest

Sinus-vibration testing	acc. DIN IEC 68-2-6
Frequency range	10...500...10 Hz, sliding
Acceleration	10 g
Amplitude	6 mm
Shock testing	acc. DIN IEC 68-2-27
Shock acceleration amplitude	50 g
Duration of nominal shock	11 ms
Directions	6 (±x, ±y, ±z) 3



HARTMANN

Configuration

Actuators



Arrow-shaped slot

Codes

BCD , 10 Positions, Rotor red

Contact Pins

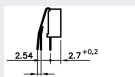

* Vorspannung des Bestückungshilfe

Left angular 2.54mm

Packing

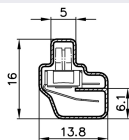

Tube