

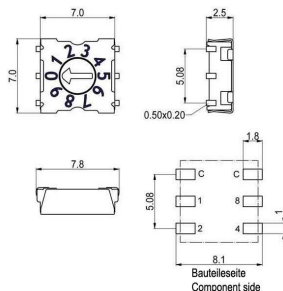

Rotary Code Switch

P25SMJ 8 01 - TR

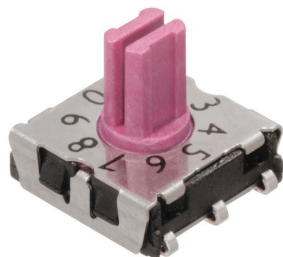

- 2.5mm height
- 7.0mm length
- lateral C-contact
- contacts with abrasion resistant hard gold plating
- solid, tinned PCB pins

Solid PCB pins ensure trouble-free assembly and safe connection. Contacts with abrasion resistant hard gold plating have low and stable contact resistance. ISO 9001:2008 approved production together with 100% electronic final inspection and testing guarantee reliable operation. Figures are clearly visible and detention mechanism is precise for fast and easy operation.

Electrical Data

| | |
|-----------------------|----------------|
| Operating voltage | ≤ 42 V |
| Contact load, static | ≤ 0.4 A |
| Contact load, dynamic | ≤ 0.1 A |
| Minimum load | 1µA 20mVDC |
| Test voltage | 250V 50Hz/1min |
| Contact resistance | < 80 mΩ |
| Insulation resistance | > 100 MΩ |

Mechanical Data

| | |
|-----------------------------|------------------------|
| Type | horizontal |
| Fixation mode | SMJ |
| Height | 2.5 mm |
| Length | 7.0 mm |
| Width | 7.0 mm |
| Pin connection | 3+3 |
| Perm. ambient temperature | -50 ... +125 °C |
| Perm. storage temperature | -55 ... +135 °C |
| Torque | min. 0.7 Ncm |
| Positions per rotation | 10, 16 |
| Shock and vibration testing | acc. DIN IEC 60068 |
| Humidity | 21 days at 40°C, 93%RH |

Other Data

| | |
|------------------|------------|
| Reflow soldering | 10s/260 °C |
| Iron soldering | 2s/340 °C |

Configuration

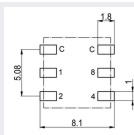
| | |
|--------------|--|
| Actuators |  Slotted spindle |
| Codes | BCD , 10 Positions, Rotor red |
| Contact Pins |  SMJ |
| Packing | Tape & Reel Packing |