



**EtraLED**

**EtraLED-9650 Modular Passive LED Star Heat Sink Ø96mm**

**Features VS Benefits**

- \* Mechanical compatibility with direct mounting of the LED modules to the LED cooler and thermal performance matching the lumen packages.
  - \* Thermal resistance range Rth 1.2°C/W.
  - \* Modular design with mounting holes foreseen for direct mounting of a wide range of LED modules and COB's:
  - \* Diameter 96mm - Standard height 50mm , Other heights on request.
  - \* Extruded from highly conductive aluminum.
- 2 standard colors - clear anodized - black anodized
- Zhaga Book 3 Spot Light Modules Edison , Osram , Xicato ,Bridgelux , Citizen , Cree , Lumileds ,Tridonic Vossloh-Schwabe , LG , Seoul , Luminus , GE lighting , Prolight ,SHARP ,Samsung , Lustrous .Philips



- 1) Xicato XSM, XIM,XTM;(XSA-309;XSA-310)
- 2) Bridgelux ESS, ESR, Vero 10, Vero 13,Vero 18,Vero 29 V-series;
- 3) Citizen CLL022-CLU024, CLL032-CLU034,CLL040-CLU044;
- 4) Cree XLamp CXA13xx, CXA15xx,CXA18,CXA25;
- 5) Philips Fortimo SLM LED engines.
- 6) Lumileds Luxeon COB's 1203, 1204, 1205, Luxeon K arrays K12, K16;
- 7) LG Innotek LEMWM18 27W, 24W, 40W;
- 8) Seoul Semiconductor ZC25, ZC40,ZC60, ZC100 Series;
- 9) Tridonic TALEXXmodule SLE Modules engines;
- 10) Luminus C##14 ,C##22COB LED engines.
- 11) Edison EdiLex SLM and EdiLex II COB LED engines;
- 12) GE lighting Infusion™ LED Modules.
- 13) Prolight Opto PABS, PABA, PACB, PANA;
- 14) SHARP Tiger Zenigataand and Mega Zenigata LED engines;
- 15) Samsung COB LC026B,LC033B,LC040BCOB LED engines;
- 16) Vossloh-Schwabe Vossloh-Schwabe LUGA Shop LED engines;
- 17) OSRAM PrevaLED Core,SOLERIQ P,SOLERIQ E and SOLERIQ S LED engines;
- 18) Lustrous M series, LUSTRON series, Coral series,LUSTRON 5 6 series LED engines;



**Order Information**

Example:EtraLED-9650-B-#

Example:EtraLED-96 **1** - **2** - **3**

**1** Hight (mm)

**2** Anodising Color

B-Black

C-Clear

Z-Custom

**3** Mounting Options - see graphics for details Combinations available

Ex.order code - 12

means option 1 and 2 combined

MingFa recommends the use of a high thermal conductive interface between the LED module and the LED cooler. Either thermal grease, a thermal pad or a phase change thermal pad thickness 0.1-0.15mm is recommended.

Tel: +86-769-33252828 +86-769-33251919  
E-fax: +86-(020)28819702 ext22122  
Http://www.heatsinkled.com  
Http://www.mingfatech.com



*EtraLED*

**EtraLED-9650 Modular Passive LED Star Heat Sink  $\Phi$ 96mm**

The thermal data table

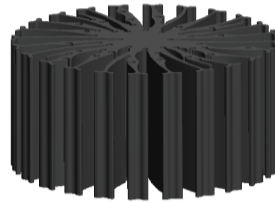

*EtraLED-9650*

<b>Model No.</b>	<b>EtraLED-9650</b>
<b>Size</b>	<b><math>\Phi</math>96x50mm</b>
<b>Material</b>	<b>AL6063-T5</b>
<b>Finish</b>	<b>Black Anodized</b>
<b>Weight(gr)</b>	<b>360</b>
<b>Thermal Wattage</b>	<b>37.5W</b>
<b>HeatsinkOs-a<sup>2</sup></b>	<b>114836</b>
<b>Heat Sink RiseT</b> <small>Rise Above Ambient (°C/W)</small>	<b>1.2</b>

Dissipated Power Pd(W)	Pd = Pe x (1-ηL)	Heat sink to ambient thermal resistance Rhs-amb (°C/W)	Heat sink to ambient temperature rise Ths-amb (°C)
		EtraLED-9650	EtraLED-9650
10		1.7	16.5
15		1.5	22.5
20		1.4	28
25		1.3	33
30		1.3	38
35		1.2	43
40		1.2	48
50		1.1	56

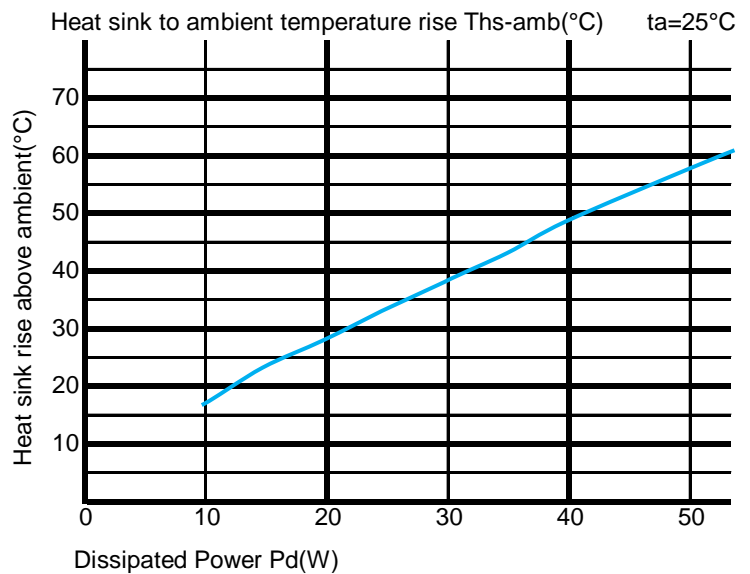

Notes:

- Mentioned models are an extraction of full product range.
- For specific mechanical adaptations please contact MingfaTech.
- MingfaTech reserves the right to change products or specifications without prior notice.