

EtraLED

EtraLED-9680 Modular Passive LED Star Heat Sink Φ 96mm

Features VS Benefits

- * Mechanical compatibility with direct mounting of the LED modules to the LED cooler and thermal performance matching the lumen packages.
- * Thermal resistance range Rth 0.92°C/W.
- * Modular design with mounting holes foreseen for direct mounting of a wide range of LED modules and COB's:
- * Diameter 96mm - Standard height 80mm , Other heights on request.
- * Extruded from highly conductive aluminum.
- 2 standard colors - clear anodized - black anodized
- Zhaga Book 3 Spot Light Modules Edison , Osram , Xicato ,Bridgelux , Citizen , Cree , Lumileds ,Tridonic Vossloh-Schwabe , LG , Seoul , Luminus , GE lighting , Prolight ,SHARP ,Samung , Lustrous .Philips



- 1) Xicato XSM, XIM,XTM;(XSA-309;XSA-310)
- 2) Bridgelux ESS, ESR, Vero 10, Vero 13,Vero 18,Vero 29 V-series;
- 3) Citizen CLL022-CLU024, CLL032-CLU034,CLL040-CLU044;
- 4) Cree XLamp CXA13xx, CXA15xx,CXA18,CXA25;
- 5) Philips Fortimo SLM LED engines.
- 6) Lumileds Luxeon COB's 1203, 1204, 1205, Luxeon K arrays K12, K16;
- 7) LG Innatek LEMWM18 27W, 24W, 40W;
- 8) Seoul Semiconductor ZC25, ZC40,ZC60, ZC100 Series;
- 9) Tridonic TALEXXmodule SLE Modules engines;
- 10) Luminus C##14 ,C##22COB LED engines.
- 11) Edison EdiLex SLM and EdiLex II COB LED engines;
- 12) GE lighting Infusion™ LED Modules.
- 13) Prolight Opto PABS, PABA, PACB, PANA;
- 14) SHARP Tiger Zenigataand and Mega Zenigata LED engines;
- 15) Samung COB LC026B,LC033B,LC040BCOB LED engines;
- 16) Vossloh-Schwabe Vossloh-Schwabe LUGA Shop LED engines;
- 17) OSRAM PrevaLED Core,SOLERIQ P,SOLERIQ E and SOLERIQ S LED engines;
- 18) Lustrous M series, LUSTRON series, Coral series,LUSTRON 5 6 series LED engines;

Order Information

Example:EtraLED-9680-B-#

Example:EtraLED-96 **1** - **2** - **3**

- 1** Hight (mm)
- 2** Anodising Color
B-Black
C-Clear
Z-Custom
- 3** Mounting Options - see graphics for details Combinations available
Ex.order code - 12
means option 1 and 2 combined

MingFa recommends the use of a high thermal conductive interface between the LED module and the LED cooler. Either thermal grease,a thermal pad or a phase change thermal pad thickness 0.1-0.15mm is recommended.



EtraLED

EtraLED-9680 Modular Passive LED Star Heat Sink Φ 96mm

The thermal data table

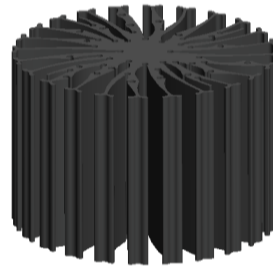

EtraLED-9680

Model No.	EtraLE-9680
Size	Φ96x80mm
Material	AL6063-T5
Finish	Black Anodized
Weight(g)	575
Thermal Wattage	49.2W
HeatsinkΘs-a²	180427
Heat Sink Rise_T Rise Above Ambient ($^{\circ}$C/W)	0.92

Dissipated Power Pd(W)	Pd = Pe x (1- η L)	Heat sink to ambient thermal resistance Rhs-amb ($^{\circ}$ C/W)	Heat sink to ambient temperature rise Ths-amb ($^{\circ}$ C)
		EtraLED-9680	EtraLED-9680
5		3.4	17.5
15		1.43	21.5
20		1.32	26.4
25		1.21	30.3
30		1.32	39.6
35		1.15	40.3
40		1.12	44.8
45		1.08	48.6

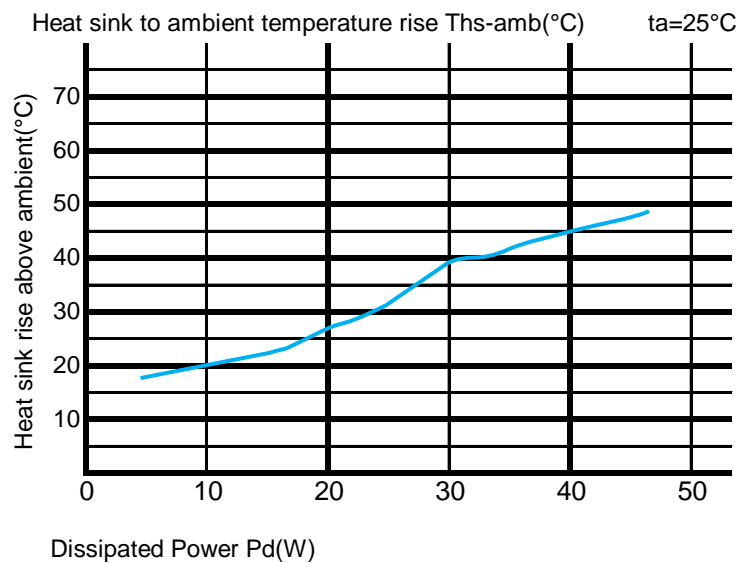

Notes:

- Mentioned models are an extraction of full product range.
- For specific mechanical adaptations please contact MingfaTech.
- MingfaTech reserves the right to change products or specifications without prior notice.