

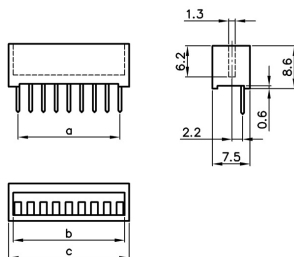

Dual Push Button Switches

B 12 L

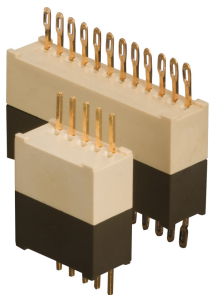

- sockets for Pushbutton Code Switches with PCB in various numbers of poles
- after 100 plugging actions all technical values are within limits

Electrical Data

Operating voltage	40 V
Contact load, static	1 A
Test voltage	~ 500 V
Contact resistance	< 15 mΩ
Insulation resistance	> 100 MΩ

Mechanical Data

Insertion force per pole	approx. 2 N
Withdrawl force per pole	approx. 1.8 N
contact spacing 5, 9, 12 poles	2.54 mm
contact spacing 11 poles	2.00 mm

Material

Plastic material	PPO
Contact material solder tags and lugs	Au over Ni on CuSn6

Configuration

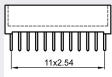
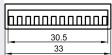
Number of poles	  12 poles for DPS9, DPS10
-----------------	--

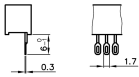
Connection mode	 Solder lug
-----------------	---