

Panel-mount Socket LB4-R/I

Insulated, Ø 4 mm, rigid. Machined brass.
The socket can be screw-mounted in pre-drilled panels.

Solder connection.

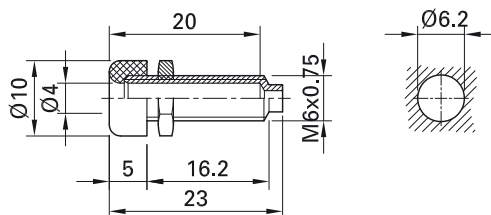

Order No.	Type	Rated voltage/current		*Colors
49.7068-*	LB4-R/I	30 VAC / 20 A 60 VDC / 20 A	Ni	21 22

Component parts

49.7090-*	BI-LB4-R/I	Socket without nut
Page 68	MUE/M6x0,75	Hexagonal Nuts

Panel-mount Socket EBI-40

Insulated, Ø 4 mm, rigid. Machined brass.
The socket can be screw-mounted in pre-drilled panels.

Threaded bolt M6x0.75 and solder connection.

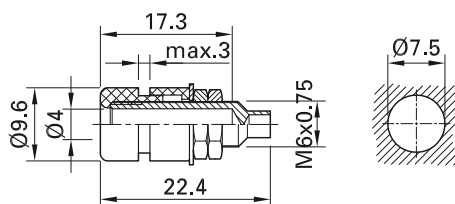

Order No.	Type	Rated voltage/current		*Colors
69.8321-*	EBI-40	30 VAC / 20 A 60 VDC / 20 A	Ni	21 22 23 24 25 29