

# USB PLUGS & SOCKETS

Designers' Choice

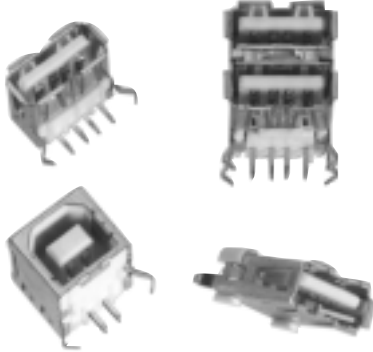

## UNIVERSAL SERIAL BUS SOCKETS



### FEATURES

- Snap-In PC solder tails hold connector in position for wave soldering
- Tin Lead Plated solder tails for excellent solderability
- Gold Plated contacts for low contact resistance and excellent reliability

### SPECIFICATIONS

**Shell:** Phosphor Bronze  
**Insulator:** Thermoplastic, UL 94V-0  
**Contacts:** Phosphor Bronze  
**Contact Area:** Gold Flash over Nickel  
**Solder Tails:** Tin Lead over Nickel

### ELECTRICAL CHARACTERISTICS

**Rated Voltage:** 30V (RMS)  
**Contact Current Rating:** 1 Amp DC max.  
**Contact Resistance:** 15 mΩ max.  
**Insulation Resistance:** 1000MΩ min.  
**Dielectric withstanding Voltage:** 750V AC for 1 minute  
**Operating Temperature:** -13°F (-25°C) to 176°F (+80°C)

### DESIGN ADVANTAGES

**Port Expansion:** Alleviates restriction of limited COM Ports and available IRQ's  
**Daisy Chaining:** Up to a max of 127 devices to the root hub  
**Fast Data Transfer:** Up to 12 Mbps; 3-5 times faster than parallel devices and 20-40 times faster than serial ports  
**Hot-Swapping:** Allows peripherals to be connected or disconnected without turning off computer  
**Simple Connections:** True Plug and Play; No jumper, DIP Switches or IRQ's to set  
**True Digital Audio:** Allows USB Speakers to BYPASS the sound card and receive true digital audio sound quality

### DEVICE APPLICATIONS

Ability to daisy chain more than one input device

- Mouse
- Trackball
- Keyboards
- Printers
- Joysticks
- Modems
- Scanners Digital Cameras
- Telephones
- Fingerprint I.D. Systems
- Digital Speakers: Connect directly with the computer for true digital audio clarity

### SINGLE A-TYPES

#### HORIZONTAL

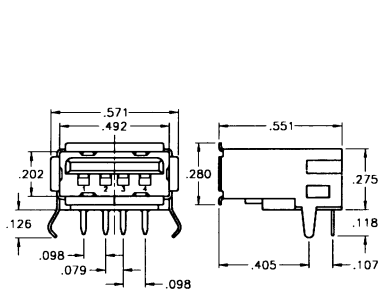

#### VERTICAL

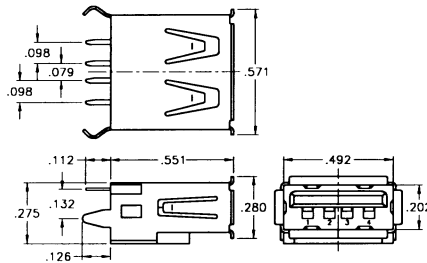

Mounting Detail

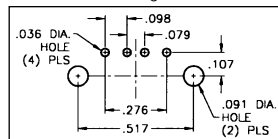

CAT. NO. 921

### DUAL A-TYPE

#### DUAL STACKING

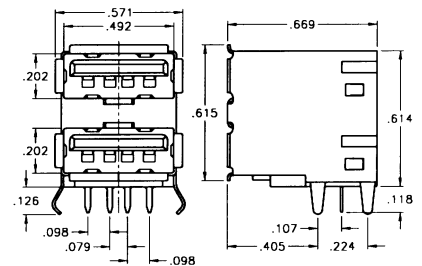

Mounting Detail

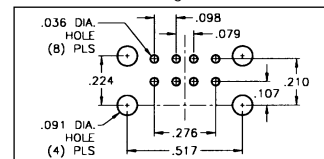

CAT. NO. 923

CAT. NO. 922

### B-TYPE

#### HORIZONTAL

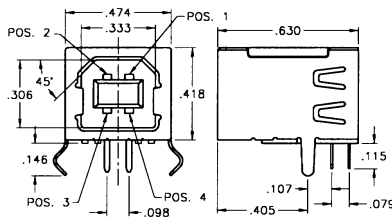

Mounting Detail

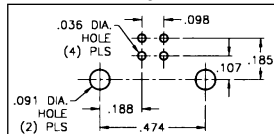

CAT. NO. 924

## USB PLUGS

### A-TYPE

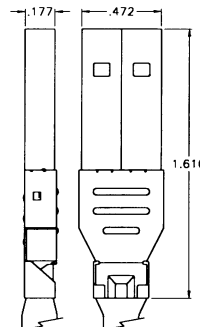

### B-TYPE

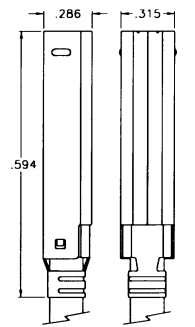

### SPECIFICATIONS

**Shell:** Steel, Tin Plated  
**Insulator:** Thermoplastic, Rated UL 94V-0  
**Contact:** Bronze, Gold Flash over Nickel

Supplied Unassembled

CAT. NO. 925

CAT. NO. 926