

Note:

1. Material:
 - * Insulation: Glass filled polyester UL 94V-0
 - * Contact: Brass
2. For Tin Lead Wave Flow Process

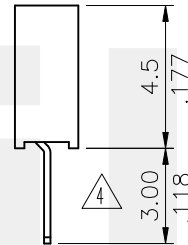
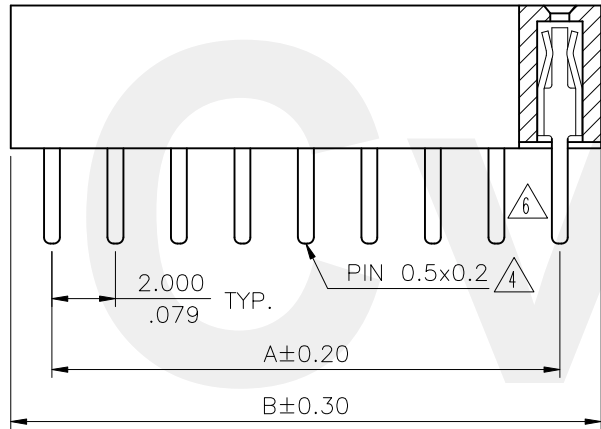
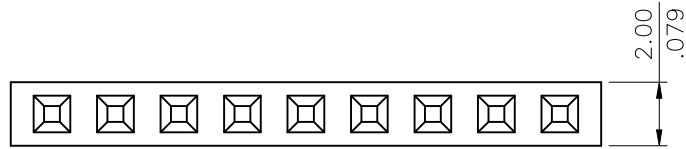

Ordering Code:

CB22 ** 2 V 1 00
 ① ② ③ ④ ⑤ ⑥

- ① Series No.
- ② NO. of Circuits:
2 = Gold flash plated over 1.27μm(50μ") Nickel
- ③ Plating code:
2 = Gold flash plated over 1.27μm(50μ") Nickel
- ④ Tail Style: V = Straight
- ⑤ Color: 1 = Black
- ⑥ Options: 00 = Standard

A = 2.00 * No. of Spaces

B = A + 2.60

△5 * Available in 2 through 35 circuits

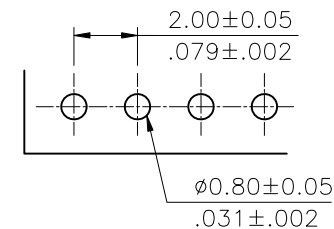

Recommended P.C. Board Layout

Tin-Lead Process

RoHS Compliant

△6	Karen	9/01-21'	ECNT121198/ECRD121028			DATE	UNIT: mm / inch	TITLE: 2.00MM(.079") SINGLE ROW BOARD MOUNT CONNECTOR	瀚荃股份有限公司 CviLux Corporation		
△5	Yushu	12/16-19'	ECNT119357/ECRT119060		DRAWN BY: Karen	9/1-21'	TOLERANCE UNLESS OTHERWISE SPECIFIED	MATERIAL:		DRAWING NO. CB2201SH	PART NO. CB22**2V100
△4	Karen	3/21-18'	ECNT118046/ECRT117082		ENGINEER: Sun	9/2-21'	.X ± 0.30 / .012 X' ±	FINISH:		SCALE 4 / 1	SHEET 1 OF 1
△3	Karen	7/08-15'	ECNT115151/ECRT115052		CHECKED BY: Eisley	9/3-21'	.XX ± 0.20 / .008 .X' ± 3'				
SYM	NAME	DATE	REVISIONS		APPROVED BY: Eisley	9/3-21'	.XXX ± 0.10 / .004 .XX' ± 1'				