

PC BUTTON & SPRING CONTACTS

- Ideal contacts for "A" · "AA" · "AAA" · "N" size batteries
- Space saving design installs directly onto the PC board
- Contacts available for .062 (1.57) to .093 (2.36) thick PC boards
- Reliable spring and/or button assures low contact resistance
- Ideal for self-contained battery compartments



For "A"



Refer to page 24 for Battery Contact Layout & Mounting Details



For "AA" · "AAA" · "N"

(+) POSITIVE BUTTON

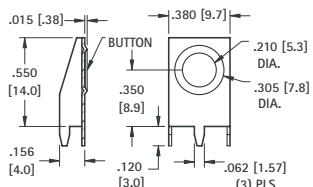

Mounting Detail

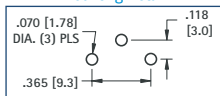

MATERIAL:
Frame: .015 (.38) thick Steel, Tin Nickel Plate

CAT. NO. 595

(-) NEGATIVE SPRING

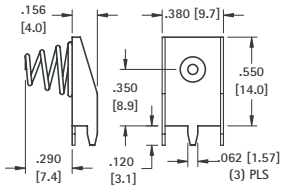

MATERIAL:
Frame: .015 (.38) thick Steel, Tin Plate

CAT. NO. 628

(+) POSITIVE BUTTON

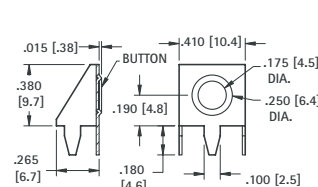

Mounting Detail

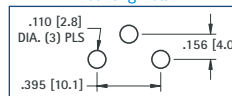

MATERIAL:
Frame: .015 (.38) thick Steel, Tin Nickel Plate

CAT. NO. 637

(-) NEGATIVE SPRING

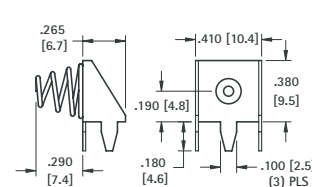

MATERIAL:
Frame: .015 (.38) thick Steel, Tin Plate

CAT. NO. 629

SNAP-IN PC BUTTON & LEAF-SPRING CONTACTS



- Space saving design installs directly onto the PC board
- Suitable for .062 (1.57) to .093 (2.36) thick PC boards
- Reliable leaf-spring assures low contact resistance
- Ideal for self-contained battery compartments



MATERIAL: .012 (.30) thick Spring Steel, Tin Nickel Plate

For "AA" & "N"

Refer to page 24 for Battery Contact Layout & Mounting Details

For "AAA"

(+) POSITIVE BUTTON

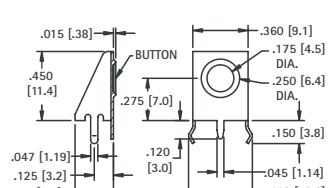

Mounting Detail

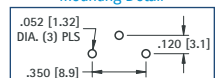

CAT. NO. 596

(-) NEGATIVE LEAF-SPRING

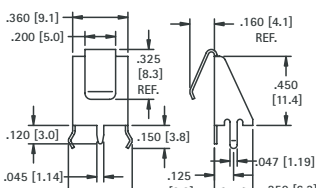

CAT. NO. 590

(+) POSITIVE BUTTON

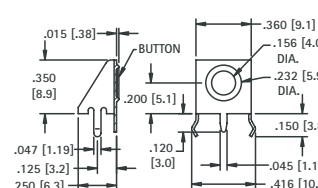

Mounting Detail

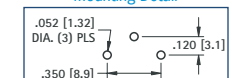

CAT. NO. 597

(-) NEGATIVE LEAF-SPRING

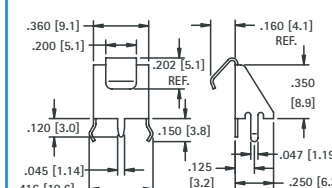

CAT. NO. 591

SURFACE MOUNT LEAF-SPRING CONTACTS

AVAILABLE ON TAPE AND REEL

- Economical & reliable contacts are ideal for surface mount applications
- Unique spring tension contacts adjust to variations in battery length
- Reliable spring tension contacts assure low contact resistance
- SMT solder tail with "flow-hole" design for increased joint strength

MATERIAL: .010 (.25) thick Spring Steel, Tin Nickel Plate

For "AAA" · "AAAA"

Refer to page 24 for Battery Contact Layout & Mounting Details

For "A" · "AA" · "9V"

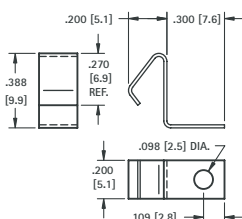

CAT. NO. 5230 (Bulk) **CAT. NO. 5230TR** (Tape & Reel)

Tape and Reel Spec's: 24mm wide; 12mm pitch; 13 inch reel (400 pieces per reel)

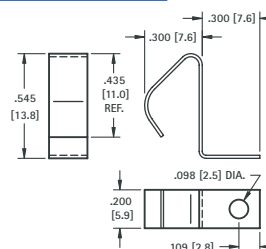

CAT. NO. 5231 (Bulk) **CAT. NO. 5231TR** (Tape & Reel)

Tape and Reel Spec's: 32mm wide; 16mm pitch; 13 inch reel (250 pieces per reel)