

RECOMMENDED
PANEL CUT-OUT

RoHS

IP66~68

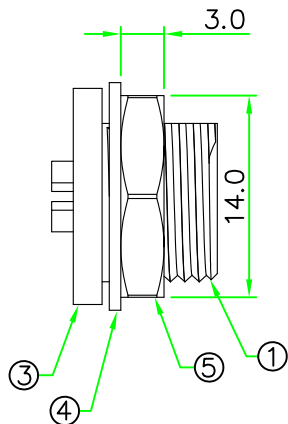
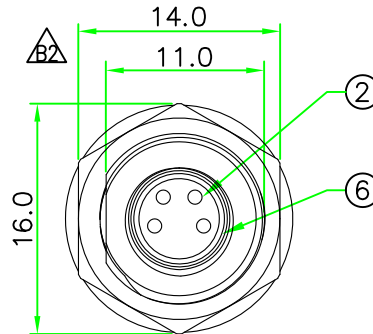
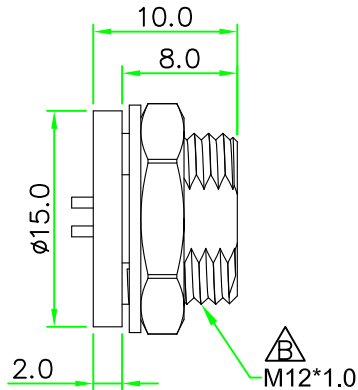

| REV. | DESCRIPTION | DATE |
|------|---------------------------------------|-------------|
| A | ISSUE | Feb/18/2011 |
| B | Modify the flat side. | Sep/02/2013 |
| B1 | Change P/N No. | Jul/03/2014 |
| B2 | Change diagram direction | Apr/22/2015 |
| B3 | Add 7-8 Pin & Correct Pin Assignment. | Oct/24/2018 |

NOTES:

1. ELECTRICAL CHARACTERISTICS:

CURRENT RATING: 1.5A / 3A

TEMPERATURE RANGE: -25°C TO +85°C

DIELECTRIC WITHSTANDING VOLTAGE:

500V AC FOR ONE MINUTE

2. HOW TO ORDER: A08x-M2xxCSR-S12



- 02 - 2 PINS 06 - 6 PINS
- 03 - 3 PINS 07 - 7 PINS
- 04 - 4 PINS 08 - 8 PINS
- 05 - 5 PINS

- I - CURRENT RATING 1.5A
- D - CURRENT RATING 3A

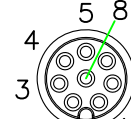
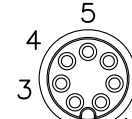
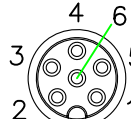
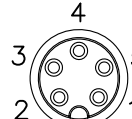
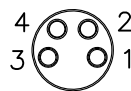
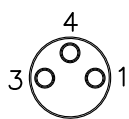
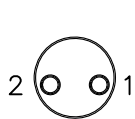

A08D-M202CSR-S12 A08D-M203CSR-S12 A08D-M204CSR-S12 A08I-M205CSR-S12 A08I-M206CSR-S12 A08I-M207CSR-S12 A08I-M208CSR-S12

PIN ASSIGNMENT FRONT VIEW (前視圖)

| 6 | O-RING | Viton. | BLACK | 1 | |
|-----|-----------|--|-------|------|---------|
| 5 | HEX NUT | Brass ,Nickel Plated. | | 1 | |
| 4 | GASKET | EPDM | BLACK | 1 | |
| 3 | HOUSING | Brass ,Nickel Plated. | | 1 | |
| 2 | CONTACT | Brass ,Female Pin. 6u" Gold Plated. | | N | |
| 1 | CONNECTOR | M8 A-Coding Female Connector Insert, Nylon+GF. | BLACK | 1 | |
| No. | PART NAME | DESCRIPTION | COLOR | Q'TY | REMARKS |

HOLIN® HTP ASIA TECHNOLOGY CO., LTD.
禾凌科技股份有限公司

| | | |
|---|------------------|--|
| | UNIT: mm | TITLE : M8 A-Coding Female Panel Connector Rear mount Circular Flange With Solder Bucket Pin |
| SCALE | 2:1 | |
| UNLESS OTHERWISE SPECIFIED TOLERANCES: .x ± 0.25 .xx ± 0.1 .xxx ± 0.05 ANGLE ± 1° | | P/N: A08x-M2xxCSR-S12 |
| REV. | SHEET | DR. SIBYL |
| B3 | 1/1 | CH. ERIC |
| | DWG.NO: | AP. |
| | A08x-M2xxCSR-S12 | |

| REV. | DESCRIPTION | DATE |
|------|-------------|-------------|
| A | ISSUE | Arp/17/2018 |
| | | |
| | | |

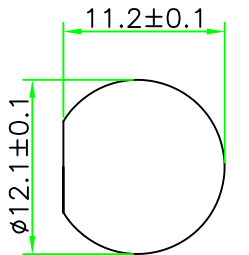

RECOMMENDED
PANEL CUT-OUT

RoHS
IP66~68

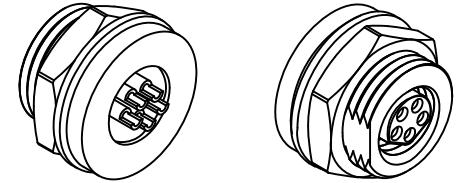
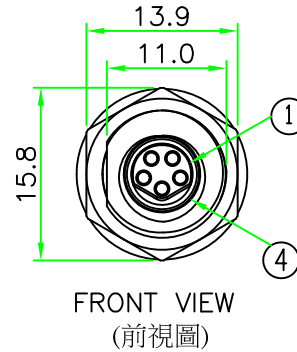
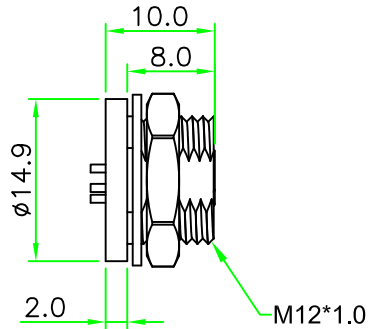
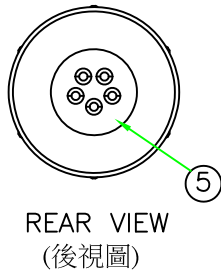

- NOTES:
 1. ELECTRICAL CHARACTERISTICS:
 CURRENT RATING: 3A
 TEMPERATURE RANGE: -25°C TO +85°C
 DIELECTRIC WITHSTANDING VOLTAGE:
 500V AC FOR ONE MINUTE
 2.PANEL THICKNESS MAX. 4.0mm

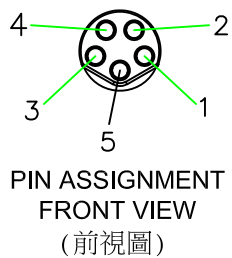
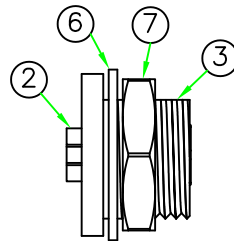

| 7 | HEX NUT | Brass ,Nickel Plated. | | 1 | |
|-----|-----------|--|-------|------|---------|
| 6 | GASKET | EPDM | BLACK | 1 | |
| 5 | GLUE | EPOXY. | BLACK | 1 | |
| 4 | O-RING | VITON | BLACK | 1 | |
| 3 | HOUSING | Brass, Nickel Plated. | | 1 | |
| 2 | CONTACT | Brass, 6 u" Gold plated. Female Contact. | | 5 | |
| 1 | CONNECTOR | M8 B-Coding Female Connector Insert, NYLON+GF. | BLACK | 1 | 12-135 |
| No. | PART NAME | DESCRIPTION | COLOR | Q'TY | REMARKS |

| HOLIN® HTP ASIA TECHNOLOGY CO., LTD. 禾凌科技股份有限公司 | | | | | |
|--|-------|-----------------------|--|-----|-------|
| | | UNIT:mm | TITLE : M8 B-Coding Female Panel Connector Rear mount Circular Flange With Solder Bucket Pin | | |
| SCALE | 1.5:1 | P/N: B08D-M205CSR-S12 | | DR. | SIBYL |
| UNLESS OTHERWISE SPECIFIED TOLERANCES: | | .x ± 0.25 .xx ± 0.1 | | CH. | ERIC |
| | | .xxx± 0.05 ANGLE ± 1° | | AP. | |
| REV. | SHEET | DWG.NO: | | | |
| A | 1/1 | B08D-M205CSR-S12 | | | |