

### Specifications

Current Rating: 3A AC,DC  
 Contact Resistance: 20mΩ Max  
 Insulation Resistance: 1000MΩ Min  
 Withstanding Voltage: 1000V AC/minute  
 Temperature Range: -40°C ~ +105°C

### Material

Insulator: Nylon 6T, UL94V-0  
 Contact: Copper Alloy

### ORDER INFORMATION

P	D	25	25	X	2	A/L/B - 2	XX
Stack Straight Type	Height=2.5mm	RoHS + NY 6T	Customer Design Dimension	No. of Contacts Per Row (02~50)			
Pitch 2.54mm	G0:Gold Flash G1:Gold 3u" G2:Gold 5u" G3:Gold 10u" G4:Gold 15u" G5:Gold 30u"	S0:Selective Flash S1:Selective 3u" S2:Selective 5u" S3:Selective 10u" S4:Selective 15u" S5:Selective 30u"		Dual Row			

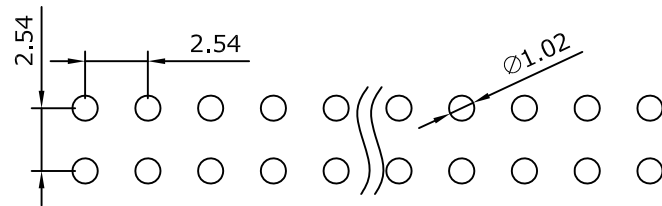
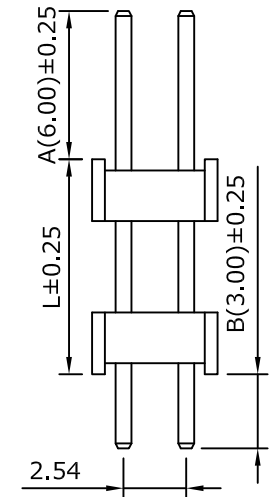
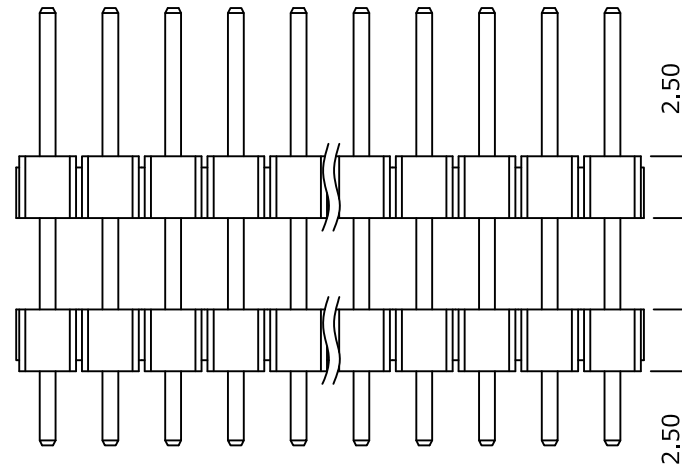
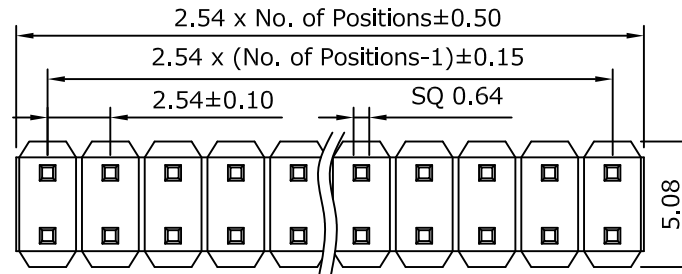

Recommended PCB Layout  
 (PCB TOLERANCE ±0.05)

			<b>MCT</b>		PART NO.	PD2525X2A/L/B-2XX	DATA	2005/06/07
					DRAWING NO.	PD2525X2A/L/B-2XX	DRAWN	Sayid
					CUSTOMER P/N		APPROVED	Max
REV.	DESCRIPTION	DATA	TITLE: Pin Header 2.54mm Plastic Height 2.5mm	REV. A	TOLERANCE .X ±0.25 .XX ±0.20	SCALE	FREE	UNIT mm