

6

5

4

3

2

1

APPROVED: _____

DATE: _____ TITLE: _____

Rev	AWO #	Description	Date	Appr
-		RELEASED	3/30/16	
A		UPDATED SPEC.	6/20/16	HR/CK

3.30mm Length

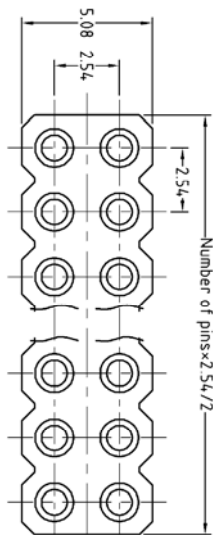
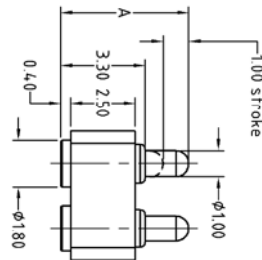

Positions: 02 thru 40
 Example: PH2-3B-08-WVF-3345 = 2X4 PIN

ADAM P/N	Initial Height
PH2-3B-XX-WVF-3345	4.5mm
PH2-3B-XX-WVF-3350	5.0mm

4.30mm Length

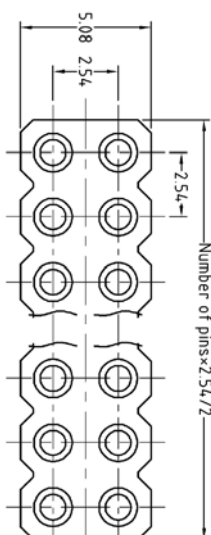
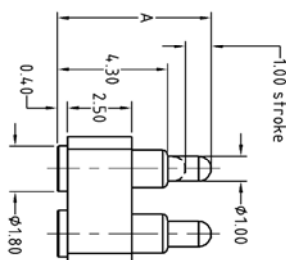

Positions: 02 thru 40
 Example: PH2-3B-08-WVF-4355 = 2X4 PIN

ADAM P/N	Initial Height
PH2-3B-XX-WVF-4355	5.5mm
PH2-3B-XX-WVF-4360	6.0mm

5.30mm Length

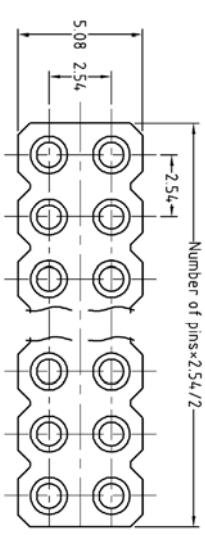
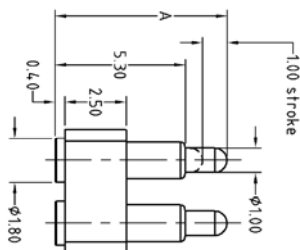

Positions: 02 thru 40
 Example: PH2-3B-08-WVF-5365 = 2X4 PIN

ADAM P/N	Initial Height
PH2-3B-XX-WVF-5365	6.5mm
PH2-3B-XX-WVF-5370	7.0mm
PH2-3B-XX-WVF-5375	7.5mm
PH2-3B-XX-WVF-5380	8.0mm

SPECIFICATIONS:

Material:
 Insulator: Black plastics, Color: Black, rated UL 94V-0
 Plunger: Brass, Gold plated
 Barrel: Brass, Gold plated
 Spring: SUS Surface treatment
Electrical:
 Voltage rating: 12 VDC max
 Current rating: 1A max (3.30mm), 3A max (4.30 & 5.30mm)
 Contact resistance: 20 mohms max
Mechanical:
 Spring force: 90g±20g @ 1.0mm working stroke (3.30mm)
 70g±20g @ 1.0mm working stroke (4.30 & 5.30mm)
 Full stroke: 1.40mm
 Life test: 1,000,000 Cycles
 Temperature Rating:
 Operating temperature: -40°C to +80°C
Environmental:
 Lead free, RoHS compliant.

ADAM TECH

909 Rahway Avenue, Union, NJ 07083
 Phone: 908-687-5000 Fax: 908-687-5710

TITLE: CUSTOM LENGTH TUBE DOUBLE ROW STRIPS
 2.50MM INSULATOR HEIGHT, SMT LOADED

UNLESS OTHERWISE SPECIFIED ALL DIMENSIONS ARE MILLIMETERS TOLERANCES: EXCEPT AS NOTED		DATE	
Holes MM X ± .25 .XX ± .15 XXX ± .05		APPROVALS	
DRAWN	HR	3/30/16	
CHECKED	CK	3/30/16	
APPROVED			
SIZE	PART NO.	REV.	
X	PH2-3B-XX-WVF-XXXX	A	
REF:	S00700C	SCALE:	NIS
		SHEET	1 OF 1



6

5

4

3

2

1