

Order code: 115-1-036-0-MTF-XS0

4) FEMALE HEADER

Series: **115**

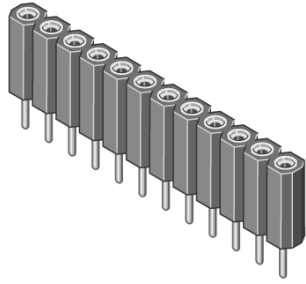

Straight female headers 2,54 mm pitch and precision turned contacts. Standard versions with a height of 7,00 or 8,50 mm available.

Single row version.

Pitch (mm)	2,54
Mating pin size (range)	ø 0,70-0,90, sq. 0,64
No of contacts	36
Polarising	No
Locking	No
Contact type	A8 - Standard 7

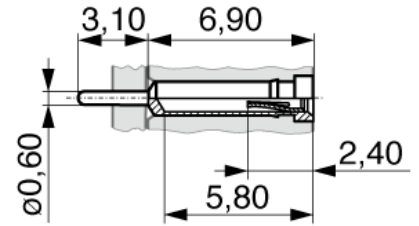

Clip style	6 finger clip
Material contact	Copper alloy
Material clip	Beryllium copper
Plating contact	Sn
Plating clip	Au
Material insulator	High temp. thermoplast UL94V-0
Rated current	3,0 A
Rated voltage	150 V _{RMS} / V _{DC}
Withstand voltage	500 V _{RMS} / V _{DC}
Operating temperature	-55°C to +125°C
Max. processing temper.	260°C for 10 seconds
Packaging	Standard

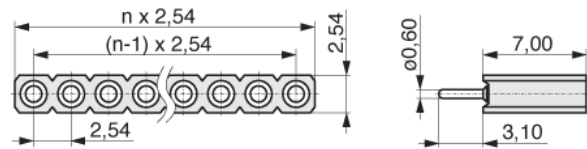

PCB layout

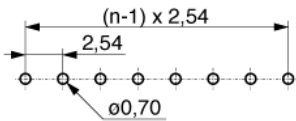

Order code: 115-1-036-0-MTF-XS0



MPE Garry GmbH
Schäfflerstraße 13
87629 Füssen/Germany

Phone: +49 (0) 83 62 / 91 56-0
Fax: +49 (0) 83 62 / 91 56-500
Email: vk@mpe-connector.de

Date: 23.12.2017 Internet: http://www.mpe-connector.de/index.php?lang=en&menu=16&s_product=115-1-036-0-MTF-XS0