

Specifications

Current Rating: 3A AC,DC
 Contact Resistance: 20mΩ Max
 Insulation Resistance: 1000MΩ Min
 Withstanding Voltage: 1000V AC/minute
 Temperature Range: -40°C ~ +105°C

Material

Insulator: P.B.T, UL94V-0
 Contact: Copper Alloy

ORDER INFORMATION

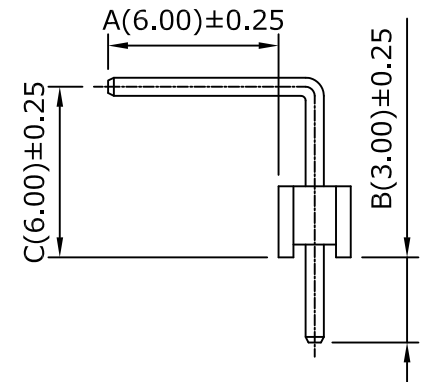
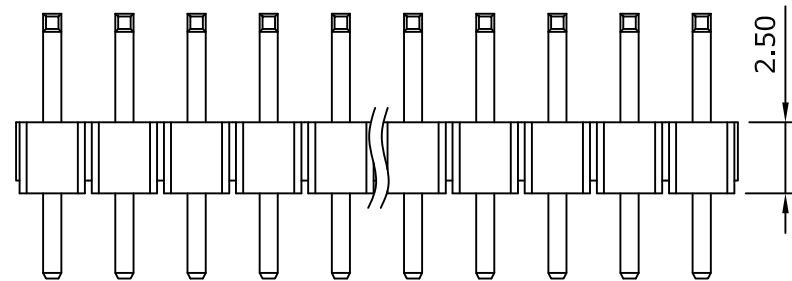
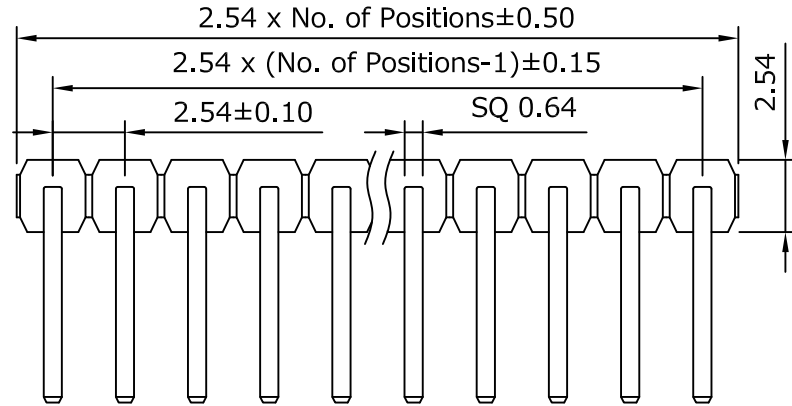
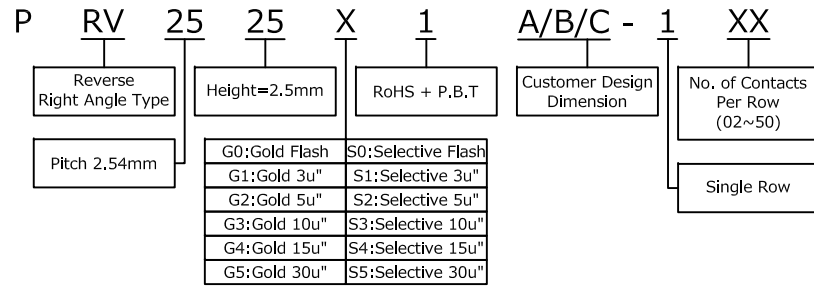

Recommended PCB Layout
 (PCB TOLERANCE ±0.05)

			MCT		PART NO.	PRV2525X1A/B/C-1XX	DATA	2005/06/03		
					DRAWING NO.	PRV2525X1A/B/C-1XX	DRAWN	Sayid		
					CUSTOMER P/N		APPROVED	Max		
REV.	DESCRIPTION	DATA	TITLE: Pin Header 2.54mm Plastic Height 2.5mm	REV. A	TOLERANCE	.X ±0.25 .XX ±0.20	SCALE	FREE	UNIT	mm