

# RB-CASEP4+03B

## Assembly instructions



### 1. GENERAL INFORMATION

Dear customer,

Thank you for choosing our product. In the following, we will show you what to consider during commissioning and use.

Should you encounter any unexpected problems, do not hesitate to contact us.

## 2. ASSEMBLY OF THE CASE

### 1. Installation of the Raspberry Pi:

The Raspberry Pi 4 must be inserted first in the bottom layer of the case:

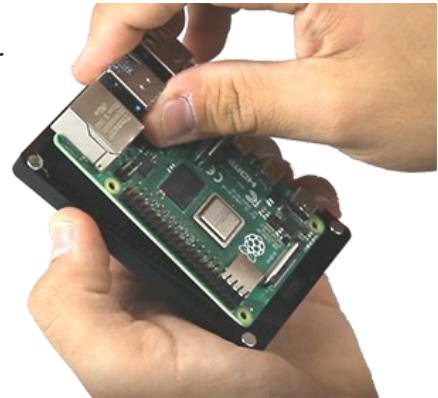

Then the middle (slightly transparent) piece of the case needs to be attached. The magnets will keep it in place.



Now stick the enclosed heatsinks onto the Raspberry Pi.

The large heat sink belongs on the CPU, the middle sized heatsink on the RAM and the small heat sink belongs on the USB3.0 controller.

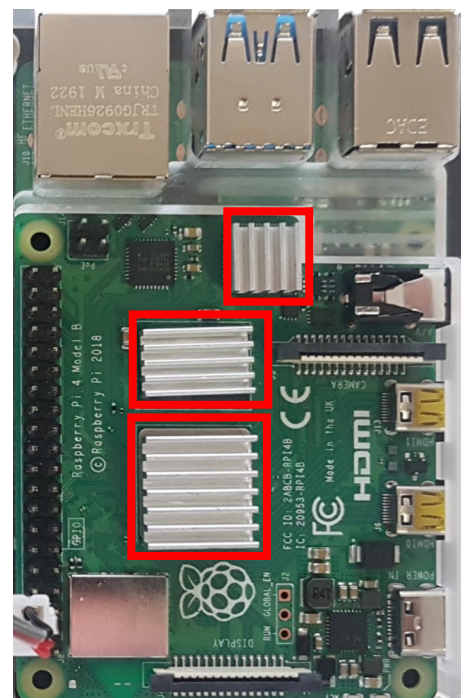

Further, you need to connect the dual fans.  
For this, use the two-pin plug. This must be plugged to 5V and Ground.  
The plug needs to be connected to the Pins 4 and 6.

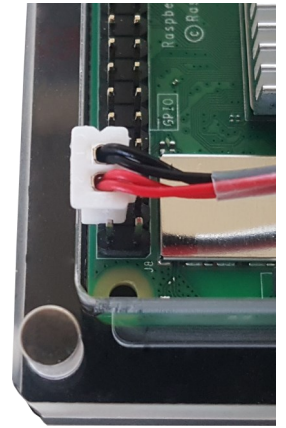
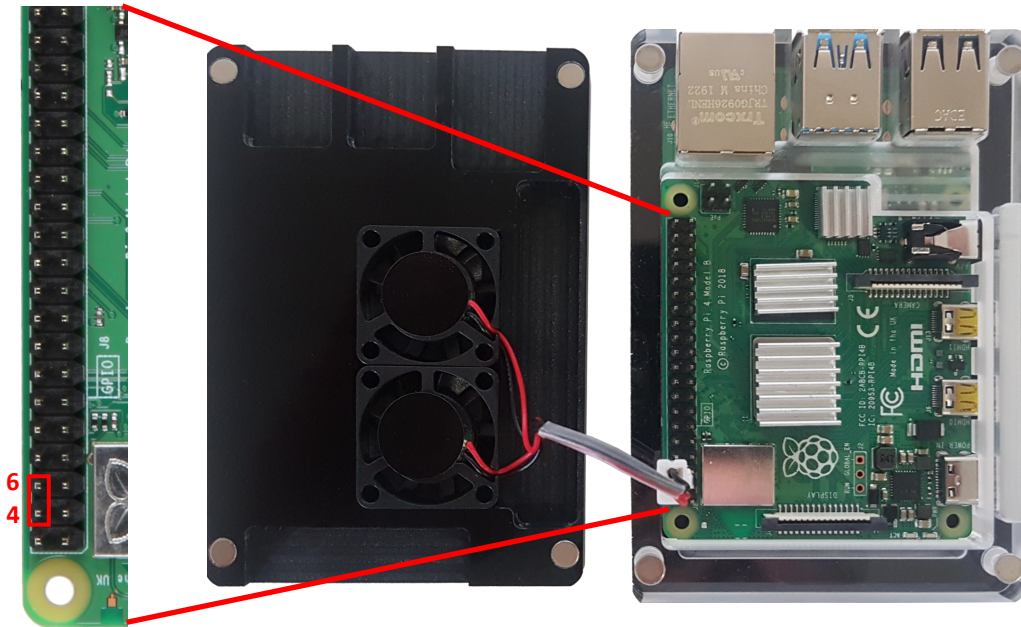

At this point, the case can be completely closed.  
All you have to do is place the cover of the case on  
the middle piece of the case.  
Then you are finished with the assembly of your RB-  
CaseP4+03B.



### 3. OTHER INFORMATION

#### Our Information and Take-back Obligations according to the Electrical and Electrotechnical Equipment Act

##### Symbol on electrical and electronic equipment:



This crossed-out bin means that electrical and electronic products do **not** belong into the household waste. You must hand over your old appliance to a registration place. Before you can hand over the old appliance, you must remove used batteries and replacement batteries which are not enclosed by the device.

##### Return options:

As the end user, you can hand over your old appliance (which has essentially the same functions as the new one bought at us) free of charge for disposal with the purchase of a new device.

Small devices, which do not have outer dimensions bigger than 25 cm can be handed in for disposal independently of the purchase of a new product in normal household quantities.

##### Possibility to return to our company location during the opening hours:

SIMAC Electronics GmbH, Pascalstr. 8, D-47506 Neukirchen-Vluyn

##### Possibility to return in your area:

We will send you a parcel stamp with which you can send us your old appliance free of charge. For this possibility, please contact us via e-mail at [pickup@joy-it.net](mailto:pickup@joy-it.net) or via telephone, then please dial 02845 93 60 -23

##### Information about the packaging:

Please package your old appliance safe for transport. Should you not have suitable packaging material or you do not want to use your own material, you can contact us and we will send you an appropriate package.

Please inform us if your device contains Li-Ion batteries. In such cases, an additional warning label must be affixed on the package.

### 4. SUPPORT

If any questions remain open or problems arise after your purchase, we are available by e-mail, telephone and with a ticket support system to answer these.

E-Mail: [service@joy-it.net](mailto:service@joy-it.net) Ticket-System: <http://support.joy-it.net> Telephone: +49 (0)2845 98469 – 66 (10 - 17 o'clock)

For further information visit our website:

[www.joy-it.net](http://www.joy-it.net)