

**CB34 Series Single Row Female Header**

2.54mm(.100") Center spacing PN1X20-B

☉ Mates with CH31 and CH34

**Ordering code**

①      ②      ③      ④      ⑤      ⑥  
**CB34**   **34**   **2**   **V**   **1**   **00**

- ① Series No.
- ② Circuits: 2= Gold flash over Nickel plated  
02 to 40
- ③ Plating code: \*Optional plating available but MOQ requested
- ④ Tail Style: V= Straight
- ⑤ Color: 1= Black
- ⑥ Other options: 00= Standard  
\*Special options Consult manufacturer

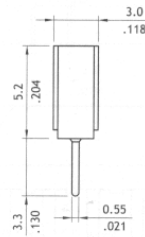
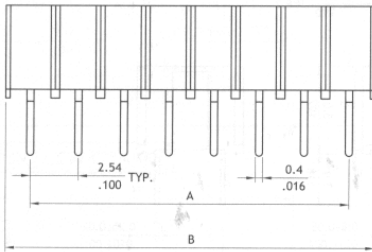
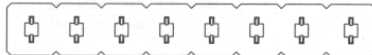
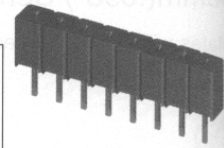

A = 2.54 \* No. of Spaces  
 B = A + 2.54

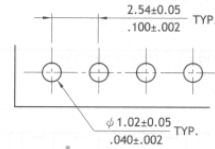

Recommended P.C. Board Layout

**CB37 Series Single Row Female Header**

2.54mm(.100") Center spacing

☉ Mates with CH31 and CH34

**Ordering code**

①      ②      ③      ④      ⑤      ⑥  
**CB37**   **45**   **A**   **V**   **1**   **00**

- ① Series No.
- ② Circuits: A= Selective Gold flash over Nickel plated  
02 to 45
- ③ Plating code: \*Optional plating available but MOQ requested
- ④ Tail Style: V= Straight
- ⑤ Color: 1= Black
- ⑥ Other options: 00= Standard  
\*Special options Consult manufacturer

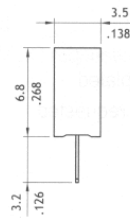
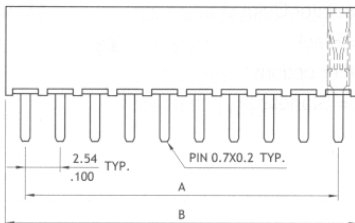
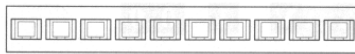
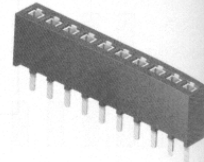

A = 2.54 \* No. of Spaces  
 B = A + 2.5

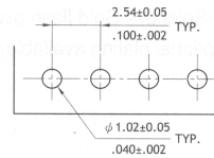

Recommended P.C. Board Layout