

Notes:

* Material:

Insulator: Nylon 6T With 30% GF.

UL 94V-0 Color Black

Square Pin: Brass

△* Pin overall Length 20.0mm Max.

Ordering Code:

CH02 ** * V 1 **
 ① ② ③ ④ ⑤ ⑥

① Series No.

② No. of Contact: 04 to 50

③ Plating code:

2=Gold Flash plated over
 1.27μm(50μ") Nickel

3=0.38μm(15μ") Gold plated
 over 1.27μm(50μ") Nickel

4=0.76μm(30μ") Gold plated
 over 1.27μm(50μ") Nickel

④ Tail & Mounting Style:

V=Straight DIP Type

⑤ Insulator Material & Color:

1=Nylon 6T , Color Black

⑥ Option Code:

See Table PDF. File No. CH0201T

Recommended P.C. Boarded Layout

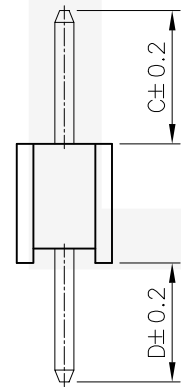
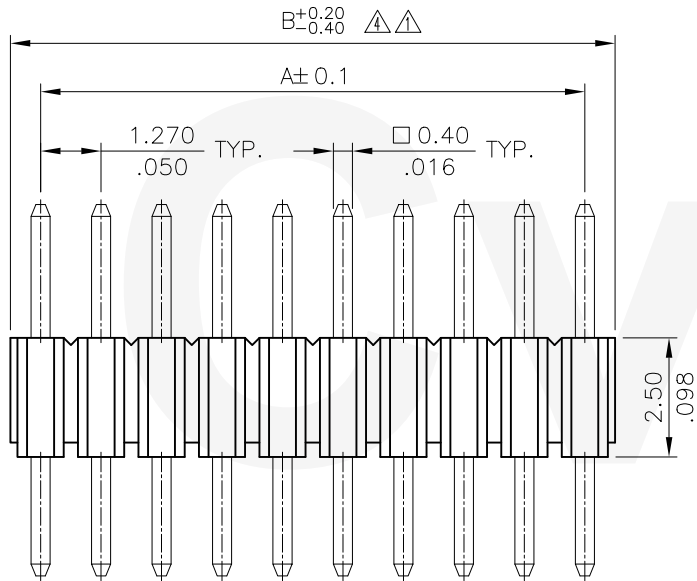

DIM. A = 1.27 X No. of Spaces

DIM. B = DIM. A + 1.27

* Available in 4 through 50 Circuits

Lead Free Process

RoHS Compliant

△4	Ken	4/10-17	ECNT117071/ECRB117010			DATE	UNIT: mm / inch	TITLE: 1.27mm(.050") SINGLE ROW BOARD MOUNT PIN HEADER	 瀚荃股份有限公司 CviLux Corporation
△3	Sun	10/6-08	ECN08477/ECR08117-1		DRAWN BY: Ken	4/28-17	TOLERANCE UNLESS OTHERWISE SPECIFIED	MATERIAL:	
△2	Sandy	3/20-08	ECN08141/ECR08030-1		ENGINEER: Sun	5/02-17	.X ± 0.25/.010 X' ± 1"	FINISH:	
△1	Sandy	08/30/04	ECN04327		CHECKED BY: Eisley	5/03-17	.XX ± 0.15/.006 .X' ±	DRAWING NO. CH0201SE PART NO. CH02***V1**	
SYM	NAME	DATE	REVISIONS		APPROVED BY: Eisley	5/03-17	.XXX ± 0.08/.003 .XX' ±	SCALE 6 / 1 SHEET 1 OF 1	