

Note:

- * Insulator: Glass filled Polyester UL 94V-0, Color Black
- * Contact: Phosphor Bronze
- * For Tin-Lead wave flow process

Ordering Code

CS05 ** 1 1 0 0*
 ① ② ③ ④ ⑤ ⑥

- ① Series No.
- ② No. of Circuits
- ③ Plating code:
 1 = 2.54μm(100μ") Min. Tin
 over 1.27μm(50μ") Nickel
- ④ Color: 1 = Black
- ⑤ Option:
 Please check details in Table
- ⑥ Other option: 00 = Standard
 0A = With Bracket

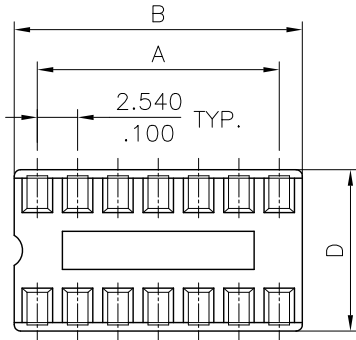

Typical 8,14,16,18,20,22 Circuits

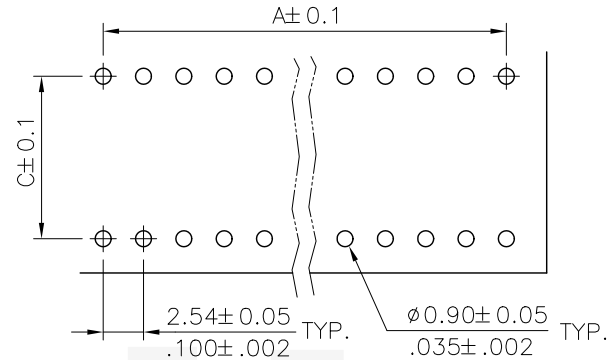

Recommended PC Board Layout

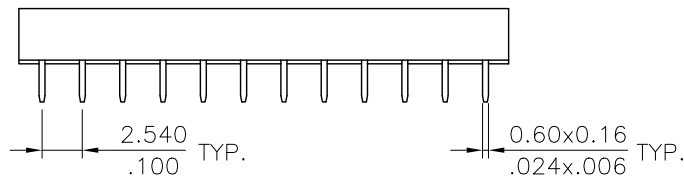
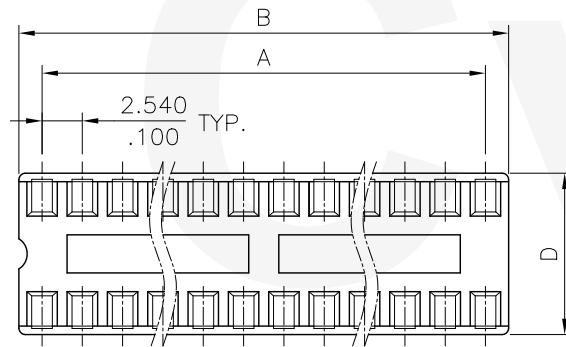

Typical 24,28 Circuits

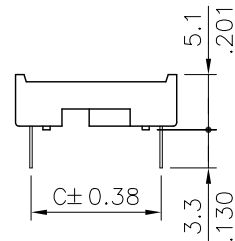

③

Circuits	CviLux P/N	Dimension			
		A	B	C	D
8	CS050811000	7.62(.300)	10.16(.400)	7.62(.300)	9.9(.390)
14	CS051411000	15.24(.600)	17.78(.700)	7.62(.300)	9.9(.390)
16	CS051611000	17.78(.700)	20.32(.800)	7.62(.300)	9.9(.390)
18	CS051811000	20.32(.800)	22.86(.900)	7.62(.300)	9.9(.390)
20	CS052011000	22.86(.900)	25.40(1.000)	7.62(.300)	9.9(.390)
22	CS052211000	25.40(1.000)	27.94(1.100)	7.62(.300)	9.9(.390)
24	CS05241100A	27.94(1.100)	30.48(1.200)	7.62(.300)	9.9(.390)
28	CS05281100A	33.02(1.300)	35.56(1.400)	7.62(.300)	9.9(.390)

Tin-Lead Process

RoHS Compliant

④	SYM	NAME	DATE	REVISIONS	APPROVED BY:	DATE	UNIT: mm / inch	TITLE: 2.54MM(.100") DUAL IN LINE IC SOCKET
④								
③	Enya	6/4-13'	ECN13130-0/ECR13055-0	2013.06.11	DRAWN BY:	Enya	6/4-13'	TOLERANCE UNLESS OTHERWISE SPECIFIED
②	Karen	6/25-09'	ECN09275/ECR9074-0	ISSUED	ENGINEER:	Eisley	6/7-13'	.X ± 0.30/.012 X' ± 1"
①	Sun	9/26-06'	ECN06350		CHECKED BY:	Eisley	6/7-13'	.XX ± 0.20/.008 .X' ±
					APPROVED BY:	David	6/7-13'	.XXX ± 0.10/.004 .XX' ±



瀚荃股份有限公司
CviLux Corporation

DRAWING NO.	CS0503SD	PART NO.	CS05**1100*
SCALE	2 / 1	SHEET	1 OF 1