

SPECIFICATIONS

Current Rating: 2A AC/DC
 Voltage Rating: 100V AC/DC
 Contact Resistance: 10m Ω Max
 Insulation Resistance: 1000M Ω Min
 Withstanding Voltage: 800V AC for 1 minute
 Temperature Range: -25°C to +85°C
 Contact : Brass, Tin plated
 Insulator: NY66, UL94V-0, White

ORDER INFORMATION

W 2001 R - XX

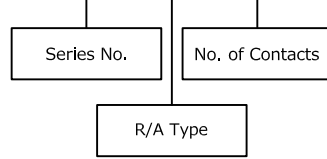

No. of Contacts	Dimensions	
	A	B
2	2.00	6.00
3	4.00	8.00
4	6.00	10.00
5	8.00	12.00
6	10.00	14.00
7	12.00	16.00
8	14.00	18.00
9	16.00	20.00
10	18.00	22.00
11	20.00	24.00
12	22.00	26.00
13	24.00	28.00
14	26.00	30.00
15	28.00	32.00
16	30.00	34.00
17	32.00	36.00
18	34.00	38.00
19	36.00	40.00
20	38.00	42.00

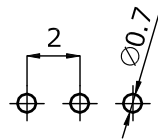
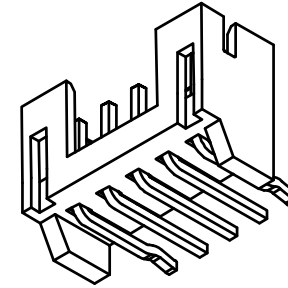

P.C.B LAYOUT

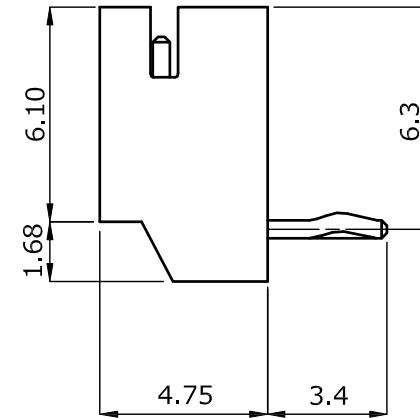
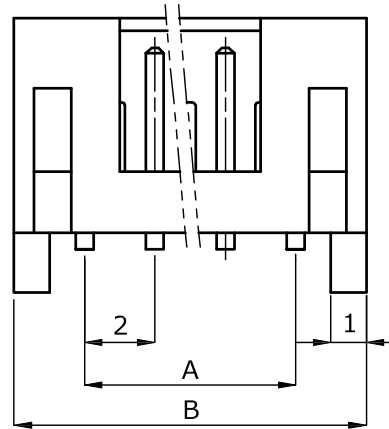

		PART NO.	W2001R-XX		DRAWN	Andrew	
		DRAWING NO.	W2001R-XX		CHECKED	Claudia	
		DATE	2018/03/06		APPROVED	Brian	

TITLE:	REV.	TOLERANCE	.X ±0.25	SCALE	1:1	UNIT	mm	NO.	DESCRIPTION	DATE
Pitch 2.00mm Wafer R/A Type	A0	.XX ±0.20								