

PL-LIN-Z5 1100-830 280X20-LV/HV

PrevaLED Linear G5 | Linear Light Engines



Product family features

- Module efficacy: up to 193 lm/W
- Available with luminous flux: 275 lm on 70 mm
- Available with luminous flux: 1,100 lm or 2,000 lm on 280 mm
- Available with luminous flux: 2,000 lm, 4,000 lm on 560 mm
- Available with luminous flux: 4,400 lm on 1,120 mm
- Available with luminous flux: 5,500 lm on 1,400 mm
- Available with color temperature: 3,000 K, 4,000 K or 6,500 K
- High initial color consistency: ≤ 3 SDCM
- Average lifetime (L80 B50): $> 70,000$ h (temperature at $T_c = 50$ °C)
- CE marked, ENEC certified; UL listed

Product family benefits

- Slim luminaire design by small and flexible form factor
- High homogeneity thanks to small LED pitch
- High voltage (HV) for serial connection
- Low voltage (LV) for parallel connection
- High voltage (HV) optimized for non-isolated, low voltage (LV) optimized for SELV operation
- Adjustable luminous flux, efficacy and lifetime
- Direct the light where it's needed while using PrevaLED Linear Optics

Areas of application

- Office
- Industry



Product datasheet

Technical data

Electrical data

Nominal voltage	23.5 V
Nominal current	0.25 A
Type of current	DC
On-mode power	6.10 W
Energy consumption in on-mode	6.1 kWh/1000h

Photometrical data

Luminous efficacy	174 lm/W
Color rendering index Ra	80
Correlated color temperature CCT	3000 K
Colour consistency (McAdam ellipses)	3
Useful luminous flux (Φ_{use})	1002 lm

Light technical data

Starting time	< 0.1 s
Warm-up time (60 %)	< 2.00 s

LED module information

Number of LEDs per module	36
---------------------------	----

Dimensions & weight

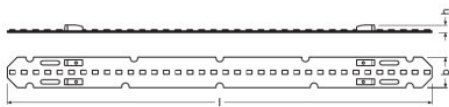

Product weight	20.00 g
Height	5.0 mm
Length	280.0 mm
Width	20.0 mm

Temperatures & operating conditions

Performance temp. acc. to IEC 62717	50 °C
Temperature range in operation at Tc point	-20...75 °C
Maximum temperature at tc test point	75 °C
Temperature range at storage	-30...85 °C
Ambient temperature range	-20...+75 °C

Lifespan

Number of switching cycles	100000
Lumen maintenance factor LMF	96
L70B50 lifetime	100000 h

Additional product data

Lighting technology used	LED
Predecessor EAN	4052899989399

Certificates & standards

Standards	CE/ENEC/VDE
Type of protection	IP20
Energy efficiency class	D

Logistical data

Commodity code	854141000000
----------------	--------------

Environmental information

Information according Art. 33 of EU Regulation (EC) 1907/2006 (REACH)	
Date of Declaration	18-04-2022
Primary Article Identifier	4052899607125
Candidate List Substance 1	No declarable substances contained
Declaration No. in SCIP database	No declarable substances contained

Product datasheet

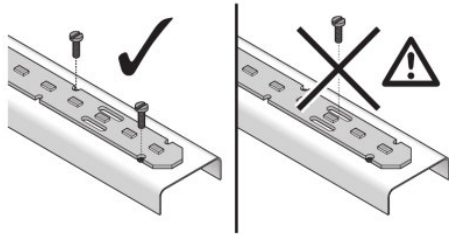



PL LIN G5 G6 Mounting Guidance 251021

Additional product information

- When parallel wiring, tolerance-related differences in output are possible and may cause deviations in brightness.

Download Data

File	
	Certificates PL ENEC 40031612 210922
	Declarations of conformity PL LIN Z5 CE 3812250 160623
	CAD data 3-dim PL LIN Z5 Z6 1100 280x20 LV HV CADPDF 240220

Ecodesign regulation information:

Separate control gear and light sources must be disposed of at certified disposal companies in accordance with Directive 2012/19/EU (WEEE) in the EU and with Waste Electrical and Electronic Equipment (WEEE) Regulations 2013 in the UK. For this purpose, collection points for recycling centres and take-back systems (CRSO) are available from retailers or private disposal companies, which accept separate control gear and light sources free of charge. In this way, raw materials are conserved and materials are recycled.

Logistical Data

Product code	Product description	Packaging unit (Pieces/Unit)	Dimensions (length x width x height)	Volume	Gross weight
4052899607125	PL-LIN-Z5 1100-830 280X20-LV/HV	Shipping carton box 60	592 mm x 252 mm x 100 mm	14.92 dm ³	1632.00 g

Product datasheet

Logistical Data

The mentioned product code describes the smallest quantity unit which can be ordered. One shipping unit can contain one or more single products. When placing an order, for the quantity please enter single or multiples of a shipping unit.

Disclaimer

Subject to change without notice. Errors and omission excepted. Always make sure to use the most recent release.