

countersunk screwhole dimensions -  
use DIN 965 screw or DIN 7991 screw

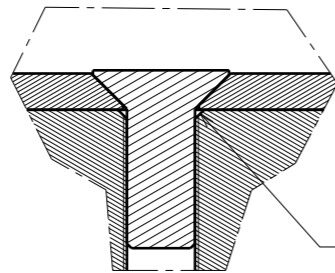
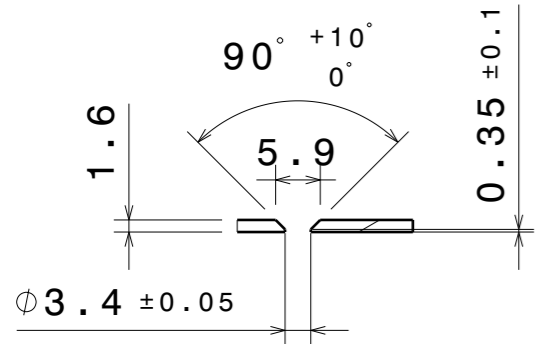

Note: Recommended to add chamfer to heatsink threaded screw holes

REV	DATE	DESCRIPTION	Done by	Checked by
001		1st Model	Mver	
002	28.10.2020	PCB length reduced	KH	
003	19.11.2021	modified holes and dimensions	olli.sipilä	

148 ± 1

Ø3.4x8  
countersunk screw hole

58.8 ± 0.1

Area for LED and other components

42 ± 0.1

25.2 ± 0.1

8.6 ± 0.1 x 2

8.4 ± 0.1

Ø9

Ø3.4x2

Positioning hole

13

A

A

19x2

47 ± 1

0.8

1.6

component area.  
Component max height 4mm

12

12

60.5

8.4

16.8x7

PART	TYPE	MATERIAL	COLOR / COATING
Strada-IP-24-PCB_and_HB-IP-24-PCB			

**PRODUCTION DRAWING**

FAMILY

**STRADA\_IP-24**

**LEDiL®**

It is recommended to rotate LED from position to position.



Plastic moulding general tolerances according to DIN 16901-130 and applies if not otherwise shown in the drawing. Silicone moulding general tolerances according to ISO 3302-1:2014(E)-M2 and applies if not otherwise shown in the drawing.

FIRST ANGLE PROJECTION:

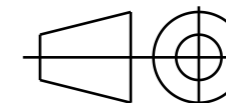

This drawing is the property of LEDiL Oy. It may not be copied or otherwise distributed without prior written permission from LEDiL Oy.

SCALE 1:1

WEIGHT -

A3 SHEET 1/1

H

G

B

A