

PRODUCT NUMBER  
95000-XXXXLF

**EXTENDED RANGE**

- TOOLING FEASIBILITY CONFIRMED
- SAMPLES ON DEMAND
- AVAILABILITY ON DEMAND

RoHS COMPATIBLE, SEE NOTE 6  
PACKAGING TYPE, SEE NOTE 3  
(MAY BE SUBJECT TO TOOLING FEES)  
TOTAL NB OF POSITIONS, 3 TO 17

**PLATING  
(AS AVAILABLE)**

- 0 = 0.20µm GOLD/GXT ON CONTACT AREA  
2.0µm MIN MATTE TIN ON TAILS
- 1 = 0.76µm GOLD/GXT ON CONTACT AREA  
2.0µm MIN MATTE TIN ON TAILS
- 3 = 0.38µm GOLD/GXT ON CONTACT AREA  
2.0µm MIN MATTE TIN ON TAILS
- T = FULL MATTE TIN 2µm-5µm  
1.27µm Ni MIN UNDERPLATING

**NOTES:**

- HOUSING MAT'L : HIGH TEMPERATURE THERMOPLASTIC. UL94V-0 COLOR: CREAM
- PIN MATERIAL : COPPER ALLOY
- PACKAGING :  
= POLY BAGS  
T = TUBE, FROM 04 POS UP TO 17 POS  
TR = TAPE & REEL AS AVAILABLE.
- 7N MIN RETENTION IN EITHER DIRECTION
- TO DETERMINE DIMENSIONS :  
N = NUMBER OF POSITIONS
- RoHS COMPATIBLE PRODUCT SPECIFICATIONS
  - MANUFACTURING PROCESS COMPATIBILITY  
- THE HOUSING WILL WITHSTAND EXPOSURE TO 260°C PEAK TEMPERATURE FOR 30 SECONDES MAX IN A CONVECTION, INFRA-RED OR VAPOR PHASE OR REFLOW OVEN.
  - LABELLING:  
- MEETS PACKAGING SPECS AS PER GS-14-920
  - THIS PRODUCT MEETS EUROPEAN DIRECTIVES AND OTHER COUNTRY REGULATIONS AS DISCRIBED IN GS-47-0004
- HOLE DIMENSION TO BE  $\phi 1.60 \pm 0.07$  FOR INTERFERENCE FIT APPLICATIONS, SEE SHEET 2.  
HOLE DIMENSION TO BE  $\phi 1.95 \pm 0.07$  FOR NON INTERFERENCE FIT (LOCATIONAL) APPLICATIONS
- THIS PART SERIES IS NOT INITIALLY INTENDED FOR AUTOMOTIVE APPLICATIONS. ADDITIONAL FEES ARE CHARGEABLE FOR ANY ADDITIONAL QUALIFICATION AND TEST REPORTS PERFORMED OUTSIDE THE SCOPE OF THE STANDARD PRODUCT SPECIFICATIONS.
- UNLESS OTHERWISE APPROVED BY AMPHENOL, ALL PARTS AND COMPONENTS ARE DESIGNED & BUILT ACCORDING TO AMPHENOL'S SPECIFICATIONS WHICH ARE SUBJECT TO CHANGE WITHOUT NOTICE.

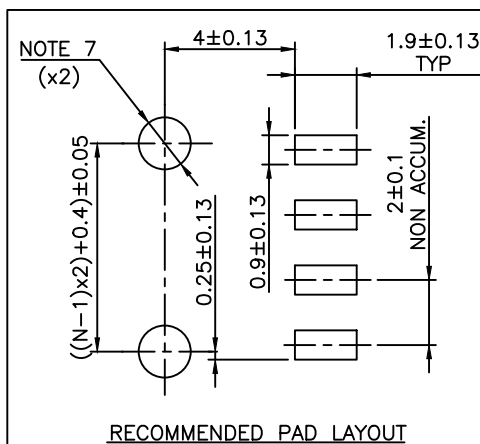
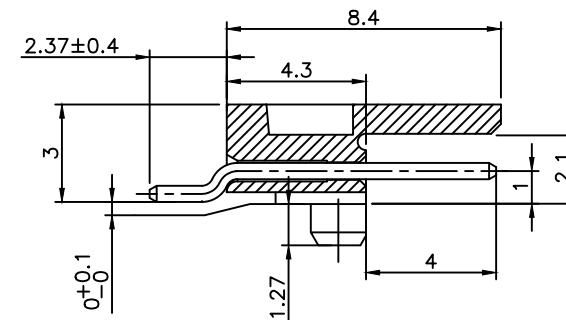
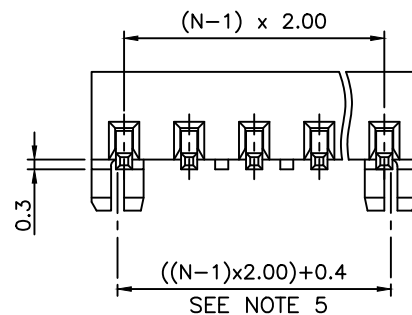
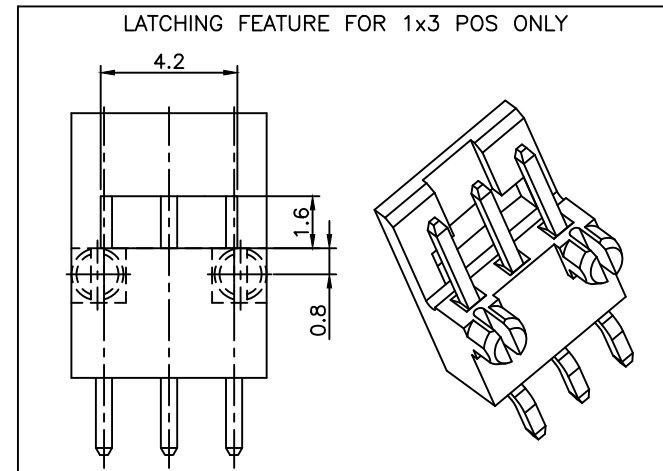
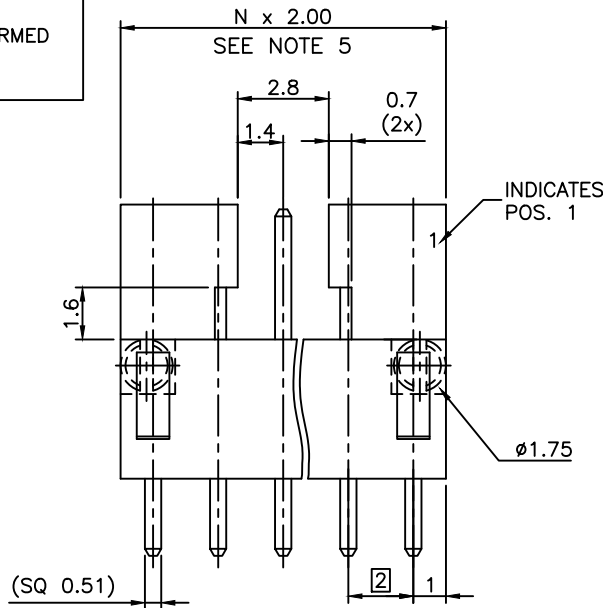

mat'l. code		surface		tolerance		projection		product family	
		ISO 1302		ISO 406 ISO 1101		⊕		MINITEK	
ltr	ecn no	dr	date	tolerances unless otherwise specified		mm		title	
S	B-19986	JCO	15.01.13	angles	linear	.x ±0.3	MINITEK SMT HDR SR		
T	B-19995	JCO	15.01.15			.xx ±0.13	POLARIZATION & LATCHING		
U	F-23052	AMA	16.01.15	±Z		.xxx ±0.05	scale 7:1		
V	F-54488	DDE	25.02.05	dr	J. FABRE	13.01.07	dwg no		sheet 1 of 2
				engr	J. FABRE	13.01.07	95000		A3
P	B-16822	JCO	14.01.23	chr	JL CORDIER	13.01.07	type		CUSTOMER Drawing
R	B-19187	LMU	14.10.24	appd	JMC	13.01.07			
sheet	revision	V	B						
index	sheet	1	2						

# RECOMMENDATION TO PLACE THE CONNECTOR ON TO THE PCB

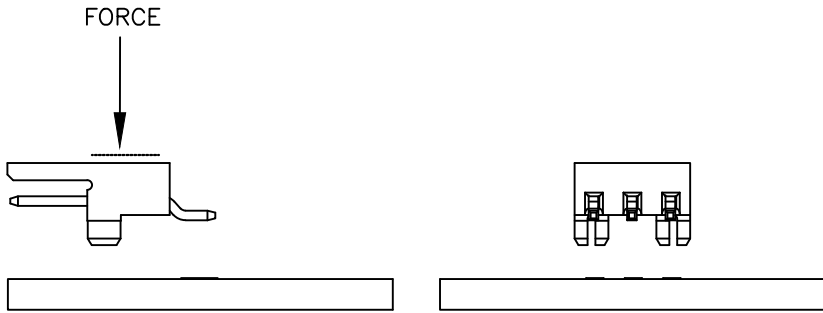
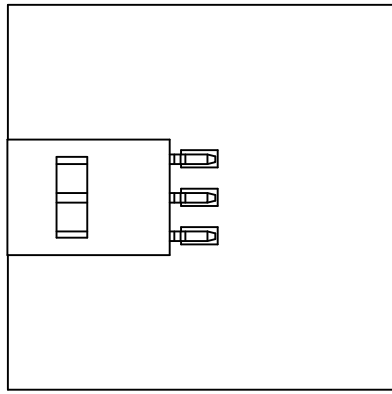

NO FORCE TO BE APLIED ON THIS AREA, RISK TO BREAK THE WALL

PLACE THE CONNECTOR ON TO THE PCB BY HAND OR WITH A TOOL BY PUSHING ON THIS AREA

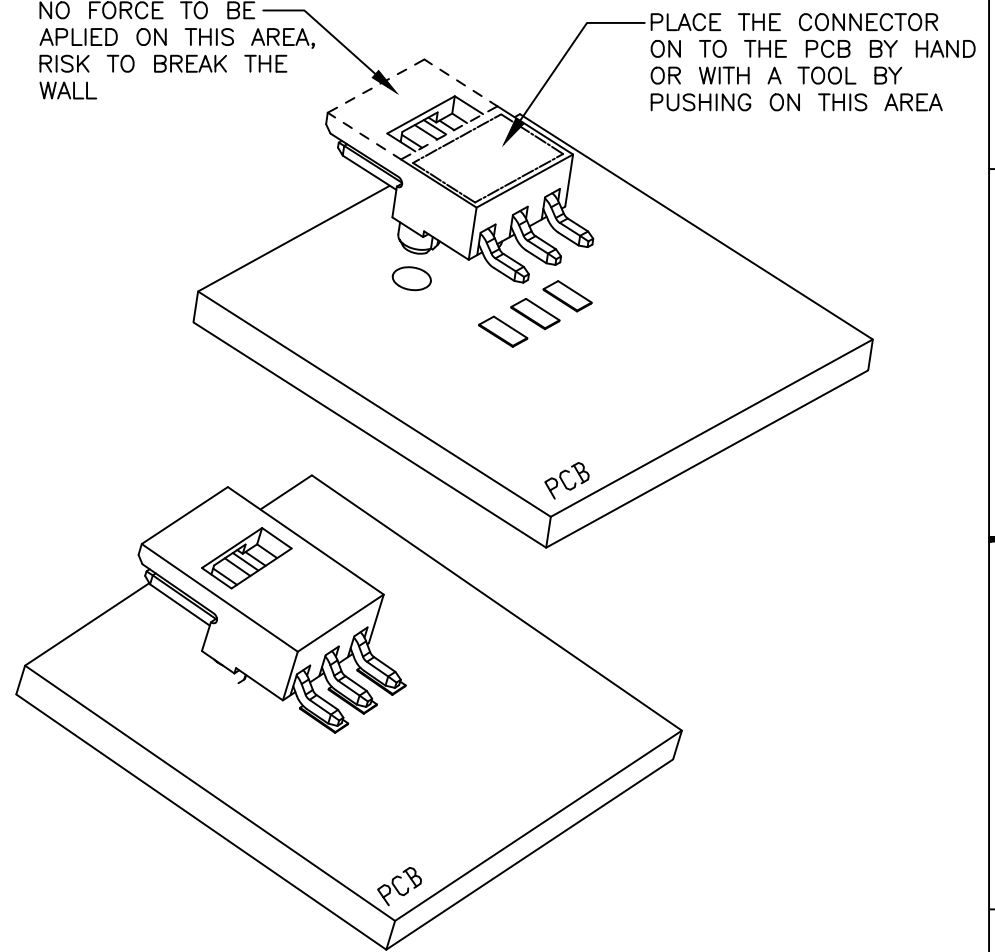

mat'l. code				surface ISO 1302 <input checked="" type="checkbox"/> ISO 406 <input type="checkbox"/> ISO 1101 <input type="checkbox"/>		tolerance ISO 406 ISO 1101		projection 		product family MINITEK	
ltr	ecn no	dr	date	tolerances unless otherwise specified				title MINITEK SMT HDR SR POLARIZATION & LATCHING			
A	B-19986	JFA	15.01.13	angles	linear	.x ±0.3	scale 7:1	dwg no		sheet 2 of 2	size
B	F-54488	DDE	25.02.05	±Z		.xx ±0.13		95000		A3	
						.xxx ±0.05		CUSTOMER		Drawing	
				dr	J. FABRE	13.01.07					
				enr	L.MULIN	15.01.07					
				chr	J.COMPAGNON	15.01.12					
				appd	JCO	15.01.13					
sheet index	revision sheet										