

AUTOMOTIVE BLADE FUSE CLIP & HOLDERS

- Available for standard, mini and maxi fuse sizes
- Horizontal and vertical mini blade clips and holders for Littelfuse Low Profile Mini 897 series, Mini 297 or 997 series, Bussmann ATM series fuses or equivalents

- Horizontal and vertical standard blade clips and holders for Littelfuse ATO 257 series and Bussmann ATC series fuses or equivalents
- Vertical maxi blade clips and holders for Littelfuse Maxi 297 series and Bussmann MAX series fuses or equivalent.

- Thru hole PC mountable, maintains position during wave soldering
- Holds fuse securely, even after multiple insertions
- Available with orientation legs to assure proper orientation

"MAXI" AUTOMOTIVE FUSE CLIP & HOLDER

FOR .312 (7.9) × .032 (.80) MAXI BLADE FUSES

For Littelfuse Maxi 297 series/Bussmann Max series or equivalent

- Thru hole PC mountable, maintains position during wave soldering
- Holder design prevents solder wicking
- Withstands the rigors of shock and vibration
- Holds fuse securely, even after multiple insertions

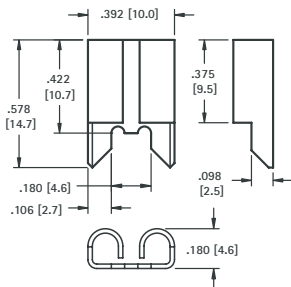

SPECIFICATIONS

Contacts: .020 (.51) thick Copper, Tin Nickel Plate
Insulator: Glass filled Nylon, UL Rated 94V-0
Current Rating: 60 Amps @ 500V AC
Temperature Rating: -58°F to +292°F (-50°C to +145°C)

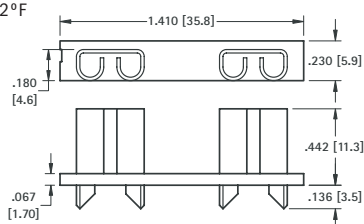

Mounting Detail For Two Clips

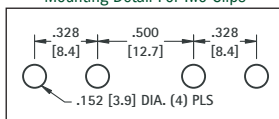

CAT. NO. 3555

CAT. NO. 3555-2

MODULAR AUTOMOTIVE BLADE FUSE HOLDERS

FOR .205 (5.2) × .025 (.64) STANDARD BLADE FUSES

For Littelfuse ATO 257 series/Bussmann ATC series or equivalent

SPECIFICATIONS

Contacts: Brass, Tin Plate
Body: Nylon, UL Rated 94V-0
Current Rating: 20 Amps @ 500V AC
Temperature Rating: -58°F to +292°F (-50°C to +145°C)

- Designed for standard auto blade fuses
- Fully insulated compact design
- Mounts easily in pre-drilled or punched hole
- Holder has pocket to hold spare fuse
- Safety lever release clip will not open under shock or vibration
- Fuses are installed and removed easily
- May be used individually or easily interlocked for multiple mounting



3560 (Shown with two 3560 holders, interlocked)



3559 (14 gauge wire lead must be cut and spliced for in-line use)

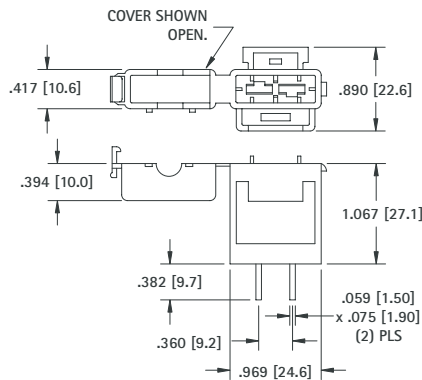

Mounting Detail For Two Holders

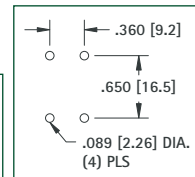

Mounting Detail

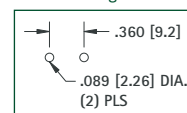

CAT. NO. 3560 (PC Mount)

CAT. NO. 3559 (In Line)

SPECIFICATIONS

Contacts: Brass, Tin Plate
Body: Nylon, UL Rated 94V-0
Current Rating: 20 Amps @ 500V AC
Temperature Rating: -58°F to +292°F (-50°C to +145°C)

- Fully insulated fuse mount
- Designed for standard auto blade fuses
- Mounts easily in punched hole
- Fuses are installed and removed easily
- May be used individually or easily interlocked for multiple mounting



CAT. NO. 3558

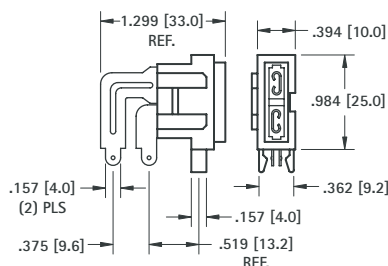

Mounting Detail

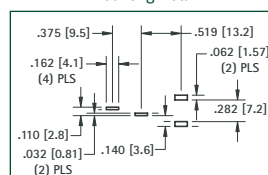

Mounting Detail For Two Holders

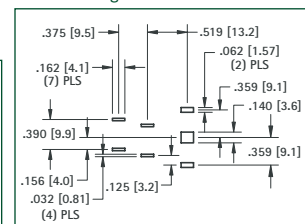

"AUTO" FUSE CLIPS & HOLDERS

STANDARD AUTOMOTIVE BLADE FUSE CLIPS & HOLDERS

FOR .205 (5.2) × .025 (.64) STANDARD BLADE FUSES

For Littelfuse ATO 257 series/Bussmann ATC series or equivalent

- Thru hole PC mountable, maintains position during wave soldering
- Holder design prevents solder wicking
- Withstands the rigors of shock and vibration
- Holds fuse securely, even after multiple insertions

VERTICAL FUSE ENTRY

SPECIFICATIONS

Contacts: .016 (.41) thick Brass, Tin Nickel Plate

Insulator: Glass filled Nylon, UL Rated 94V-0

Current Rating: 30 Amps @ 500V AC

Temperature Rating: -58°F to +292°F (-50°C to +145°C)

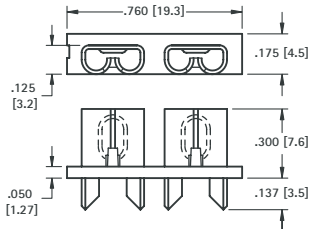

Mounting Detail For Two Clips

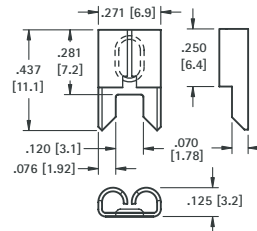
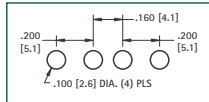

CAT. NO. 3522-2

CAT. NO. 3522-3

CAT. NO. 3522

HORIZONTAL FUSE ENTRY

- Designed for low height clearance applications
- Fuse will be inserted parallel to board
- Thru hole PC mountable, maintains position during wave soldering
- Fuse holder fully insulates clips to protect fuse from shorting
- Holder assures proper spacing and reduces assembly time
- Polarized legs assure proper orientation of clips onto board

SPECIFICATIONS

Contacts: .012 (.30) thick Brass, Tin Nickel Plate

Insulator: PBT, UL Rated 94V-0

Current Rating: 30 Amps @ 500V AC

Temperature Rating: -58°F to +292°F (-50°C to +145°C)

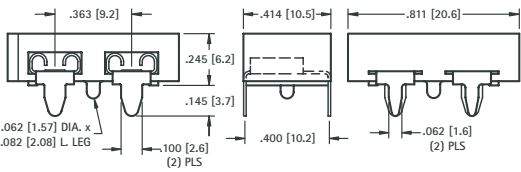

Mounting Detail For Two Clips

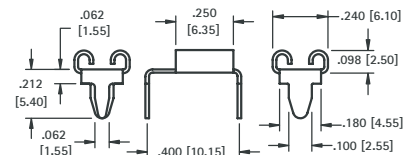
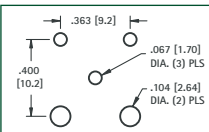

CAT. NO. 3550-2

CAT. NO. 3550

2 IN 1 FUSE HOLDER

For Littelfuse ATO 257 series/Bussmann ATC series, Littelfuse Low Profile Mini 897 series or equivalents

- Accepts Standard Auto Fuses or Low Profile Mini Fuses
- Low insertion force
- Fuse holder fully insulates clips to protect fuse from shorting
- Holder assures proper spacing and reduces assembly time
- Thru hole PC mountable, maintains position during wave soldering

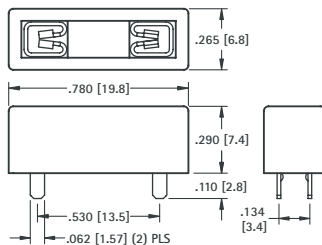

Mounting Detail

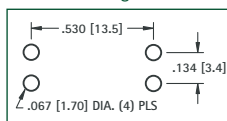

CAT. NO. 3557-2

SPECIFICATIONS

Contacts: .016 (.41) thick Brass, Tin Nickel Plate

Insulator: PBT, UL Rated 94V-0

Current Rating: 20 Amps @ 500V AC

Temperature Rating: -58°F to +292°F (-50°C to +145°C)

UNIVERSAL CLIP

For Littelfuse ATO 257 series/Bussmann ATC series, Littelfuse Mini 297 or 997 series/Bussmann ATM series, Littelfuse Low Profile Mini 897 series or equivalents

- Accepts most Auto-Blade Fuses
- Low insertion force
- Thru hole PC mountable, maintains position during wave soldering



Mounting Detail for Standard Auto Fuses and Low Profile Mini Fuse

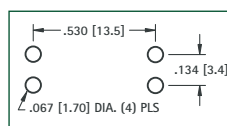

Mounting Detail for Mini Fuse

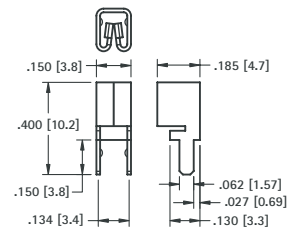
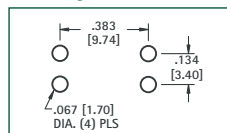

SPECIFICATIONS

Contacts: .016 (.41) thick Brass, Tin Nickel Plate

Current Rating: 20 Amps @ 500V AC

CAT. NO. 3557

"MINI" AUTOMOTIVE FUSE CLIPS & HOLDERS

For .110 (2.8) x .032 (.80) MINI BLADE FUSES

For Littelfuse Mini 297 or 997 series/Bussmann ATM series or equivalent

VERTICAL FUSE ENTRY

Thru Hole Mount



- Low Profile

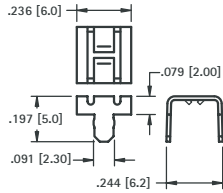

MATERIAL:

.016 (.41) thick Brass, Tin Plate
Current Rating: 30 Amps @ 500V AC

AVAILABLE ON TAPE AND REEL

Surface Mount



- Low Profile

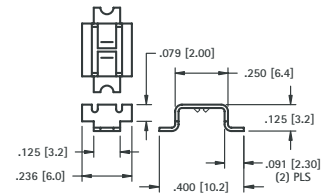

Mounting Detail For Two Clips

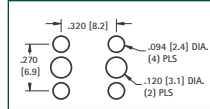

Pad Layout For Two Clips

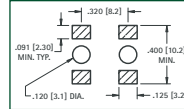

CAT. NO. 3564

CAT. NO. 3563 (Bulk)

CAT. NO. 3563TR (Tape & Reel)

Tape & Reel Spec's: 24mm wide; 12mm pitch; 13 inch reel (1500 pieces per reel)

SPECIFICATIONS

Material: .012 (.30) thick Brass, Tin Nickel Plate
Insulator: Glass filled Nylon, UL Rated 94V-0
Current Rating: 30 Amps @ 500V AC
Temperature Rating: -58°F to +292°F (-50°C to +145°C)

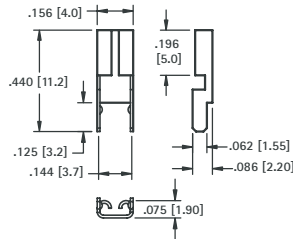

Mounting Detail For Two Clips

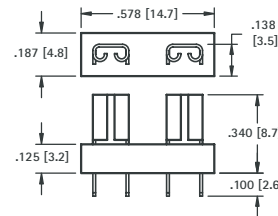
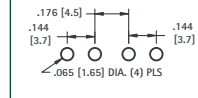

CAT. NO. 3544

CAT. NO. 3544-2

LOW PROFILE MINI FUSE HOLDER

For Littelfuse Low Profile Mini 897 series or equivalent

- Low insertion force
- Thru hole PC mountable, maintains position during wave soldering
- Fuse holder fully insulates clips to protect fuse from shorting
- Holder assures proper spacing and reduces assembly time

SPECIFICATIONS

Contacts: .016 (.41) thick Brass, Tin Nickel Plate
Insulator: PBT, UL Rated 94V-0
Current Rating: 20 Amps @ 500V AC
Temperature Rating: -58°F to +292°F (-50°C to +145°C)

MINI FUSE HOLDER

For Littelfuse Mini 297 or 997 series/Bussmann ATM or equivalents

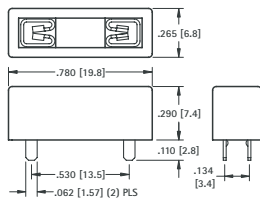

Mounting Detail

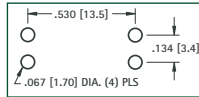

Refer to page 35 for Cat. No. 3557 Clip details

Mounting Detail

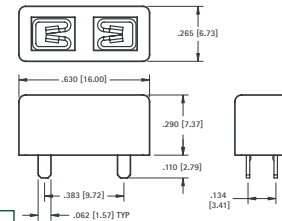
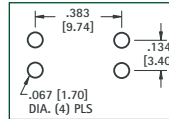

CAT. NO. 3557-2

CAT. NO. 3568

HORIZONTAL FUSE ENTRY

For Littelfuse Mini 297 or 997 series/Bussmann ATM series or equivalent

SPECIFICATIONS

Contacts: .012 (.30) thick Brass, Tin Nickel Plate
Insulator: PBT, UL Rated 94V-0
Current Rating: 30 Amps @ 500V AC
Temperature Rating: -58°F to +292°F (-50°C to +145°C)

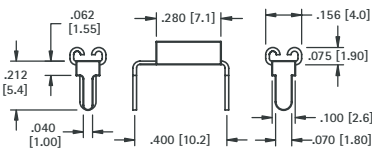

Mounting Detail For Two Clips

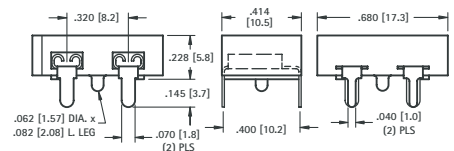
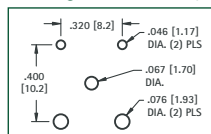

CAT. NO. 3549

CAT. NO. 3549-2