

**Series MF/ML/MP
.100" Headers**

**.100" (2.54 mm) Headers
Available in 2-36 Circuits**

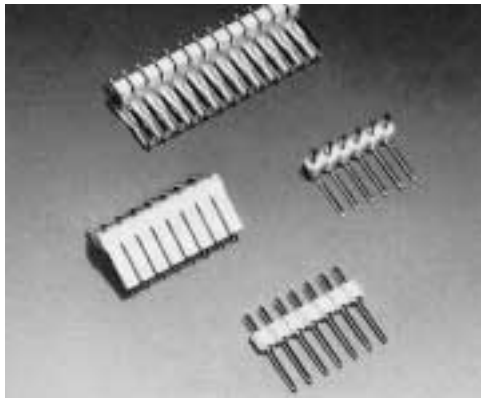

Right Angled MFAS...

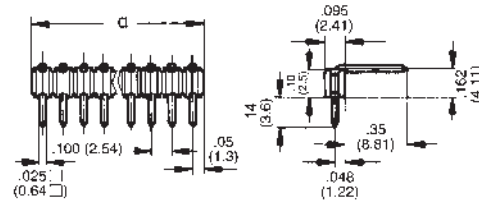

Right Angled Locking MLAS * See Page 11....

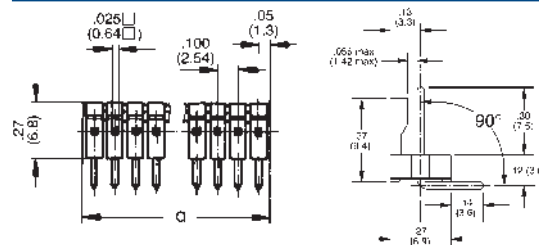

Straight MFSS...

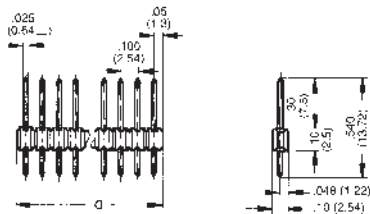

Right Angled Polarizing MPAS...

Printed Circuit Layout...

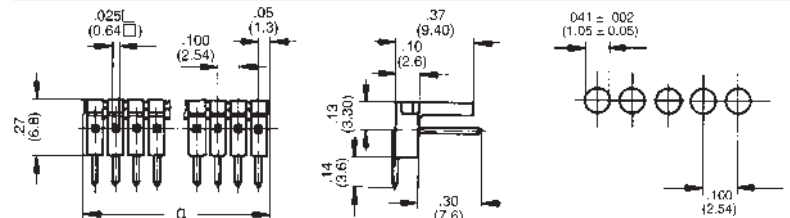

**Straight, Locking MLSS...
See Page 15 For Tabbed Polar**

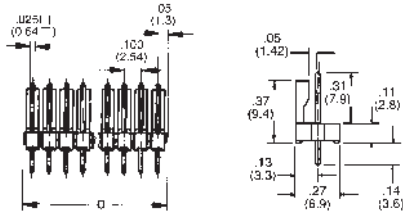

Straight, Polarizing MPSS...

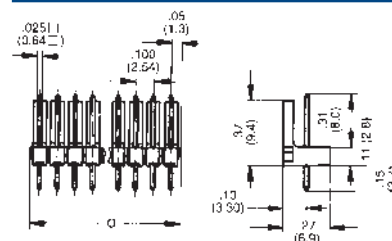

Dimensions

No. of Circuits	2	3	4	5	6	7	8	9	10	11	12	13	14	15	16	17	18	19	20	21	22	23	24	25	26	27	28	29	30	31	32	33	34	35	36
Dimensions	.200 (5.08)	.300 (7.62)	.400 (10.16)	.500 (12.70)	.600 (15.24)	.700 (17.78)	.800 (20.32)	.900 (22.86)	1.000 (25.40)	1.100 (27.94)	1.200 (30.48)	1.300 (33.02)	1.400 (35.56)	1.500 (38.10)	1.600 (40.64)	1.700 (43.18)	1.800 (45.72)	1.900 (48.26)	2.000 (50.80)	2.100 (53.34)	2.200 (55.88)	2.300 (58.42)	2.400 (60.96)	2.500 (63.50)	2.600 (66.04)	2.700 (68.58)	2.800 (71.12)	2.900 (73.66)	3.000 (76.20)	3.100 (78.74)	3.200 (81.28)	3.300 (83.82)	3.400 (86.36)	3.500 (88.90)	3.600 (91.44)

Part Number

No. of Circuits 2-36 (Contact Factory For Circuit Availability) □□ = Number of Circuits					
Description					
Straight MFSS100-□□	Straight Locking MLSS100-□□	Straight Polarizing MPSS100-□□	Angled MFAS100-□□	Angled Locking MLAS100-□□	Angled Polarizing MPAS100-□□