

# **JBC**

[www.jbctools.com](http://www.jbctools.com)



# **TIP CLEANING**

**RANGE**

## CL9885 / TIP CLEANING RANGE

The most complete cleaning accessory, allows you to choose between 3 different cleaning methods, metallic wool, metal brush and sponge. Use the integrated wiper to remove the excess of solder from the tip, you can tap the tip on the wiper profile or you can wipe any possible particle stuck on the tip using the slots. Due to its weight and antislip bumpers, it is totally self portable, there is no need to hold with a hand while you are cleaning the tip.

### CL6210 BRASS WOOL

Very effective cleaning method. Leaves a small layer of solder on the tip preventing oxidation between cleaning and rewetting.



### S0354 SPONGE

Wet cleaning method

### CL0236 WIPER

Very soft and temperature resistant receptacle allows tapping and wiping of the tip to eliminate the excess of solder

## OPTIONAL

### CL6205 INOX WOOL

Inox wool stronger cleaning method than brass wool.



### CL6220 BRUSHES

The metal brush differs from the cleaning wool in that it is a little bit more aggressive on the tip.

It therefore cleans the tip very well but it should be used gently.



### TT-A TIPTINNER-CLEANER

A long proven method of chemically cleaning and retinning at the same time.

It should be used when the above methods fail and a very active cleaning method is needed.





CL6210 Brass wool

CL6205 Inox wool



CL6220 Brushes



CL0354 Sponge

## CL0236 TIP WIPER

TAPPING

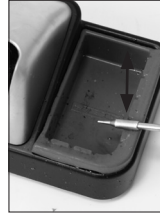

WIPPING

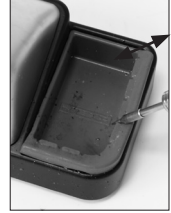

Wiper can be easily removed to clean it.

## WOOL REPLACEMENT

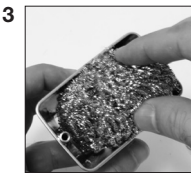

## METALLIC BRUSH REPLACEMENT

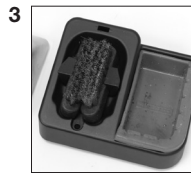
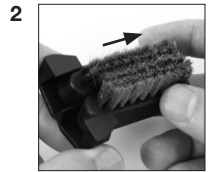
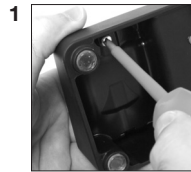



This product should not be thrown in the garbage.

# **JBC**

---

## **WARRANTY**

JBC's 2 years warranty guarantees this equipment against all manufacturing defects, covering the replacement of defective parts and all necessary labour.

Warranty does not cover product wear due to use or mis-use.

In order for the warranty to be valid, equipment must be returned, postage paid, to the dealer where it was purchased enclosing this fully filled in, sheet.

---

SERIAL N°

---

STAMP OF DEALER

---

---

DATE OF PURCHASE

---

**[www.jbctools.com](http://www.jbctools.com)**

0006349-0412