

Euromas II

Enclosure, polycarbonate



EM 241

Order no.: 62241000

* = Available on request.

Characteristics

Colour of enclosure group

Light grey

Protection class

IP 65

Enclosure Material

ABS, PC (UV stabilised); seal made of CR; for details see Technical Information

Scope of delivery

Lid and base, self-tapping coarse-pitch thread lid screws made of V2A

Dimensions

Dimensions

250 x 160 x 122 mm

Product drawing

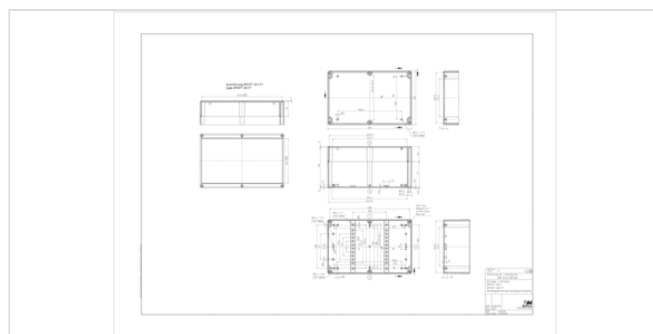

Technical documentation / Downloads

Technical drawings

3D product data in STEP format: 62241000 EM-241.stp (1.9 MB)

Drawing for mechanical processing: 62241000 EM-241-G.dxf (933.6 KB)

Milling contours are shown here as a DXF file. (Sub D, USB, HDMI, cable glands, ...)

Product drawing in PDF format: 62241000 EM-241.pdf (106.4 KB)

Product drawing in DXF format: 62241000 EM-241.dxf (1.1 MB)

Product information

euromas-ii en.pdf (1.0 MB)

Important!

To compensate for pressure when temperatures change and cause moisture in the enclosure, we recommend that you use a pressure compensation element.

» Additional information

Matching accessories



Rubber feet

22009000 GF

Polyurethane, 65-75 Shore

Black



Mast mounting, stainless steel V2A, uncoated

96500167 MH 167

96500265 MH 265



DIN rails DIN EN 60715 TH 15, galvanised steel

22152301 TS 15.230.1

For EM/ET 224, EM/ET 233-236, EM/ET 239-242, B 2617.., B 2613.., B 2736.. (crosswise)



DIN rails DIN EN 60715 G 32, galvanised steel

22322301 TS 32.230.1

For EM/ET 224, EM/ET 233-236, EM/ET 239-242, B 2617.., B 2613.., B 2736.. (crosswise)



DIN rails DIN EN 60715 TH 35, galvanised steel

22352301 TS 35

For EM/ET 224, EM/ET 233-236, EM/ET 239-242, B 2617.., B 2613.., B 2736.. (crosswise)



Mounting panels, laminated paper

22000900 M M 239/240/241/250

For EM/ET 239-241, M/T 240, M/T 241, M/T 250



Wall brackets, screw-on at rear

22010000 EM-WL



Screw covers

22080000 EM-SA

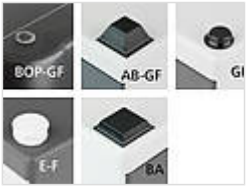

Universal rubber feet for stability of the enclosures on all surfaces

35800300 BOP-GF

Polyurethane, 65-75 Shore

Transparent



Screws (SHR) and distance bolts (DIBLZ) for mounting bosses in plastic enclosures

59006219 SHR Z KA30x6

SD = 3.0 / ND = 2.4-2.6 / KD = 5.3