

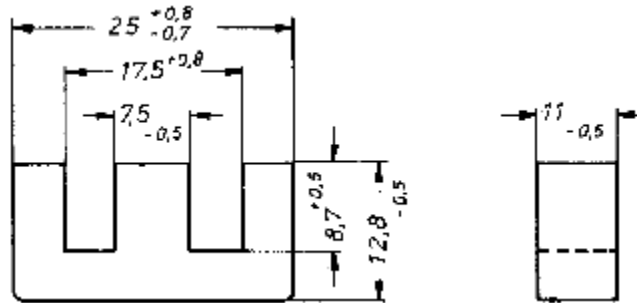

E-KERN E 25/11 (EF 25/11)
E CORE E 25/11 (EF 25/11)



206

Magn. Formkenngrößen/Satz / Effective magn. parameters/set

Formfaktor Core factor	C_1	=	0.74	mm ⁻¹
Eff. magn. Weglänge Eff. magn. path length	l_e	=	58.0	mm
Eff. magn. Querschnitt Eff. magn. cross-section	A_e	=	76.5	mm ²
Min. Kernquerschnitt Min. core cross-section	A_{min}	=	75.0	mm ²
Eff. magn. Volumen Eff. magn. volume	V_e	=	4450	mm ³
Gewicht Weight	G	=	24.0	g

A_L Wert A_L value nH	Toleranz tolerance %	Werkstoff material	Luftspalt air gap mm	Bestellnummer order number
2650	±25	K2004		320 251 100 024
2700	±25	K2006		320 251 100 026
4600	±25	K4000		320 251 100 004
660		K2004	0.10	320 251 110 024
420		K2004	0.20	320 251 120 024
220		K2004	0.50	320 251 150 024

Bei Anwendung in Leistungsübertragern / For application in power transformers
 Meßfrequenz / Test frequency $f = 16 \text{ kHz}, 25 \text{ kHz}^{1)}$

Temperatur temperature °C	Induktion induction mT	Feldstärke field strength A/m	Verluste W/Satz / losses W/set	
			K2004	K2006 ¹⁾
25	200		0.53	0.71
100	200		0.45	0.53
100	100	50		
100	330	250		

SPULENKÖRPER E 25/11 (EF 25/11)
COIL FORMER E 25/11 (EF 25/11)

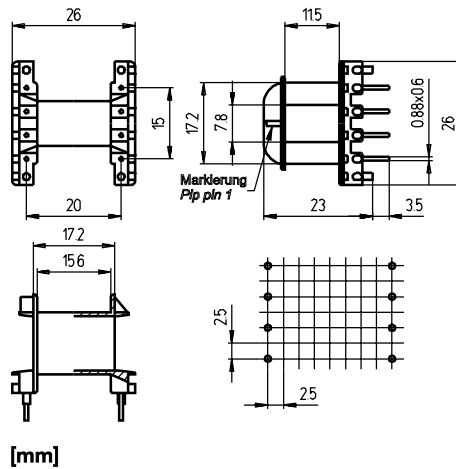

	Bezeichnung / Designation
	SP-EF 25/11 - 1418
Kammeranzahl <i>Number of sections</i>	1
A_N in mm²	60.8
l_N in mm	58.9
max. Stiftanzahl <i>max. number of pins</i>	8
Bestell-Nr. <i>Order no.</i>	500 251 110 12M

Standardmaterial / *Standard material* : Polyamid(e)