



GREEN POWER
GROUP

TACHIMA

Electret Condenser Microphone
Receiver
Speaker



INDEX OF PRODUCTS TYPE

HOW TO SPECIFY ELECTRET CONDENSER MICROPHONE PART NUMBER

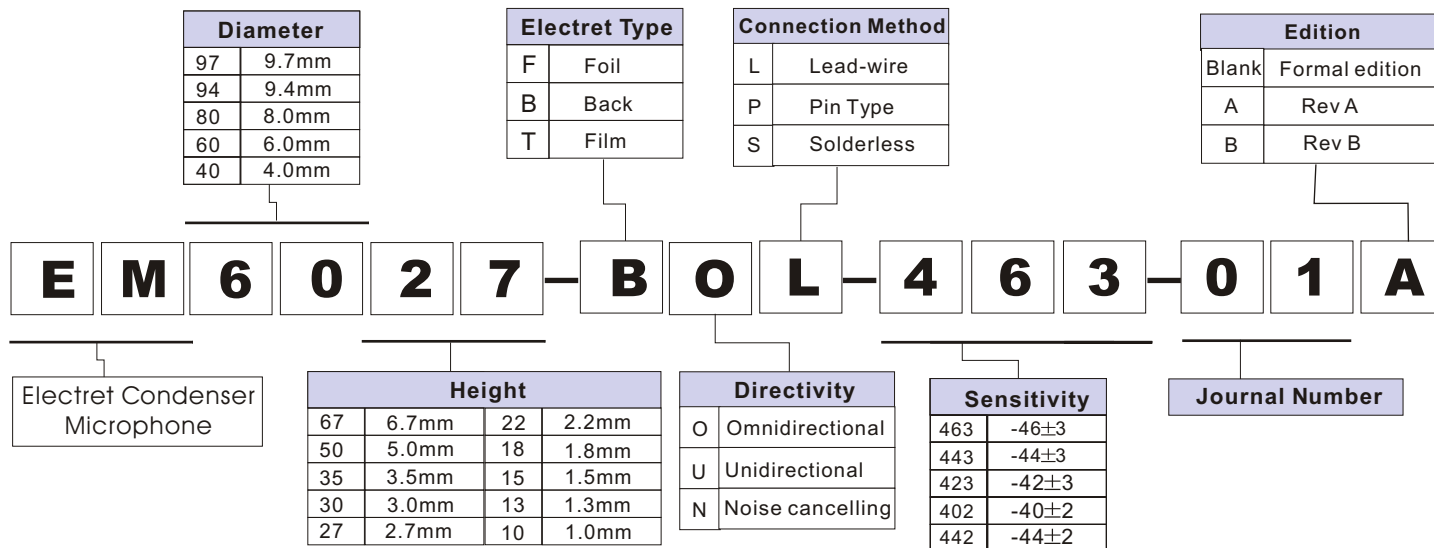

IMPORTANT INFORMATION

- Pascal(Pa) is used as the unit of sensitivity in all of our specification.it is recommend by I.E.C (International Electrotechnical Commission)
- The relation between "Pascal" and "μbar" is as follow.
- The sensitivity will increase 20dB with "Pa" indication
Example :-60dB(0dB=1V/μbar)=-40dB(0dB=1V/pa)

HOW TO SPECIFY RECEIVER&SPEAKER PART NUMBER

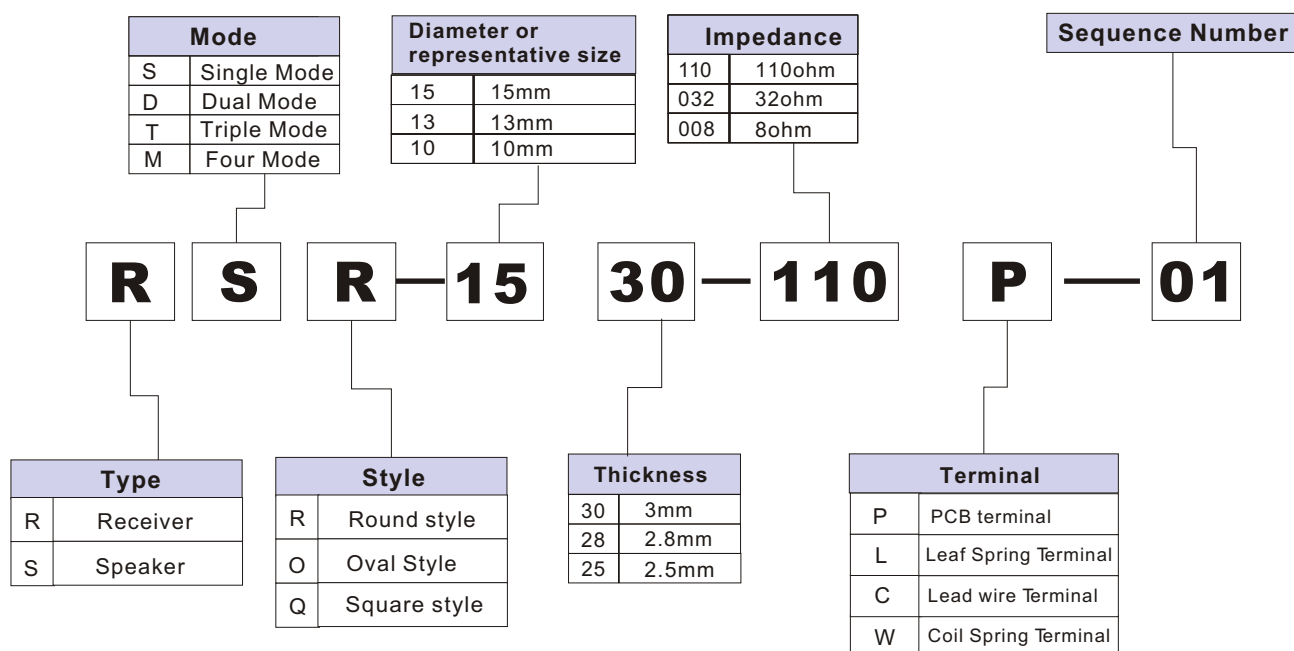

Omnidirectional Back Electret Condenser Microphone

EM4010-BOL-01



Sensitivity	-42±3, -44±3, -46±3dB
Impedance	Less than 2.2KΩ
Directivity	Omni-directional
Frequency	100-10K Hz
Max operation voltage	10.0 V
Standard operation voltage	2.0 V
Current Consumption	Max 0.5mA
Sensitivity Reduction	Within -3dB at 1.5V
Signal to Noise ratio	More than 55dB
Capacitor build-in	10+33pF

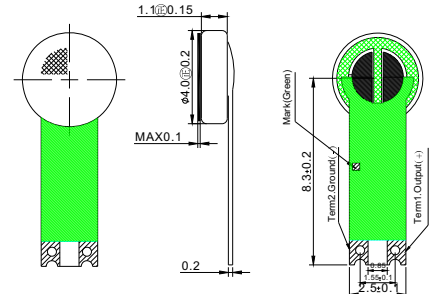
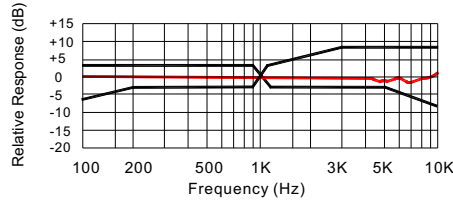

EM4010-BOL-02



Sensitivity	-42±3, -44±3, -46±3dB
Impedance	Less than 2.2KΩ
Directivity	Omni-directional
Frequency	100-10K Hz
Max operation voltage	10.0 V
Standard operation voltage	2.0 V
Current Consumption	Max 0.5mA
Sensitivity Reduction	Within -3dB at 1.5V
Signal to Noise ratio	More than 55dB
Capacitor build-in	10+33pF

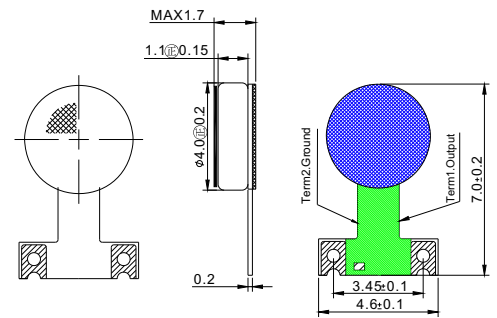
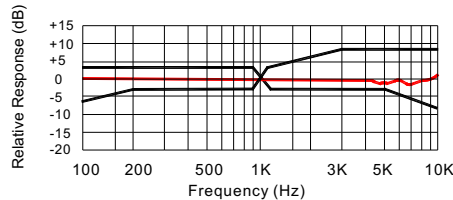

EM4010-BOS-01



Sensitivity	-42±3, -44±3, -46±3dB
Impedance	Less than 2.2KΩ
Directivity	Omni-directional
Frequency	100-10K Hz
Max operation voltage	10.0 V
Standard operation voltage	2.0 V
Current Consumption	Max 0.5mA
Sensitivity Reduction	Within -3dB at 1.5V
Signal to Noise ratio	More than 55dB
Capacitor build-in	10+33pF

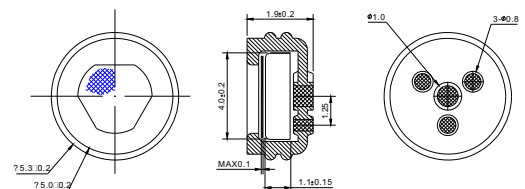
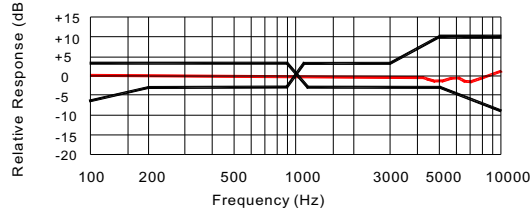

Omnidirectional Back Electret Condenser Microphone

EM4013-BOL-01



Sensitivity	-42±3, -44±3, -46±3dB
Impedance	Less than 2.2KΩ
Directivity	Omni-directional
Frequency	100-10K Hz
Max operation voltage	10.0 V
Standard operation voltage	2.0 V
Current Consumption	Max 0.5mA
Sensitivity Reduction	Within -3dB at 1.5V
Signal to Noise ratio	More than 55dB
Capacitor build-in	10+33pF

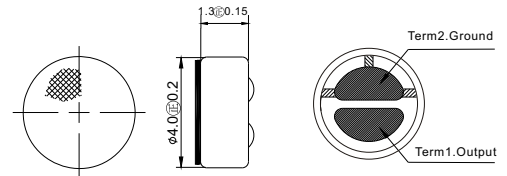
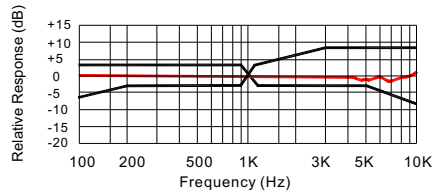

EM4013-BOS-01



Sensitivity	-42±3, -44±3, -46±3dB
Impedance	Less than 2.2KΩ
Directivity	Omni-directional
Frequency	100-10K Hz
Max operation voltage	10.0 V
Standard operation voltage	2.0 V
Current Consumption	Max 0.5mA
Sensitivity Reduction	Within -3dB at 1.5V
Signal to Noise ratio	More than 55dB
Capacitor build-in	10+33pF

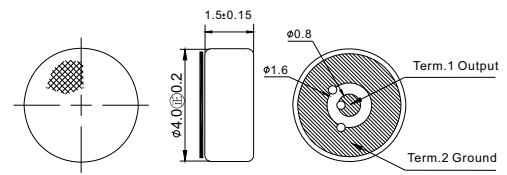
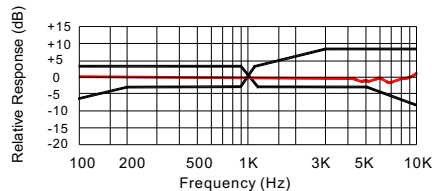

EM4013-BOP-01



Sensitivity	-42±3, -44±3, -46±3dB
Impedance	Less than 2.2KΩ
Directivity	Omni-directional
Frequency	100-10K Hz
Max operation voltage	10.0 V
Standard operation voltage	2.0 V
Current Consumption	Max 0.5mA
Sensitivity Reduction	Within -3dB at 1.5V
Signal to Noise ratio	More than 55dB
Capacitor build-in	10+33pF

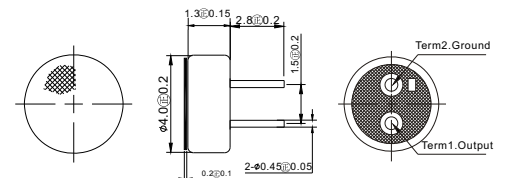
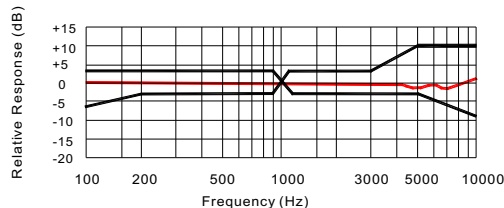

Omnidirectional Back Electret Condenser Microphone

EM4015-BOL-02



Sensitivity	-44±3, -46±3, -48±3dB
Impedance	Less than 2.2KΩ
Directivity	Omni-directional
Frequency	100-10K Hz
Max operation voltage	10.0 V
Standard operation voltage	3.0 V
Current Consumption	Max 0.5mA
Sensitivity Reduction	Within -3dB at 1.5V
Signal to Noise ratio	More than 55dB
Capacitor build-in	10+33pF

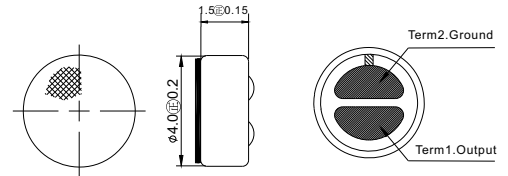
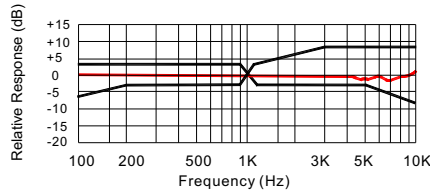

EM4015-BOL-13



Sensitivity	-42±3, -44±3, -46±3dB
Impedance	Less than 2.2KΩ
Directivity	Omni-directional
Frequency	100-10K Hz
Max operation voltage	10.0 V
Standard operation voltage	2.0 V
Current Consumption	Max 0.5mA
Sensitivity Reduction	Within -3dB at 1.5V
Signal to Noise ratio	More than 58dB
Capacitor build-in	10+33pF

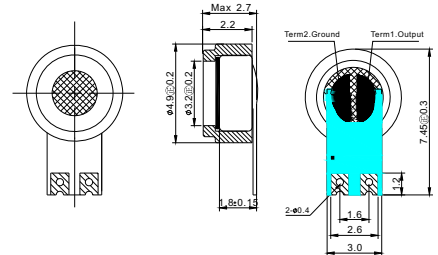
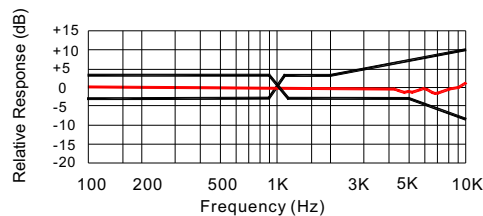

EM4015-BOL-20



Sensitivity	-42±3, -44±3, -46±3dB
Impedance	Less than 2.2KΩ
Directivity	Omni-directional
Frequency	100-10K Hz
Max operation voltage	10.0 V
Standard operation voltage	2.0 V
Current Consumption	Max 0.3mA
Sensitivity Reduction	Within -3dB at 1.1V
Signal to Noise ratio	More than 55dB
Capacitor build-in	10+33pF

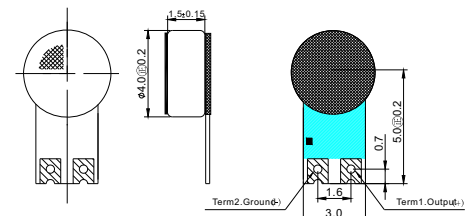
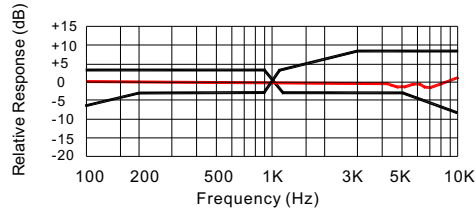

Omnidirectional Back Electret Condenser Microphone

EM4015-BOL-32



Sensitivity	-42±3, -44±3, -46±3dB
Impedance	Less than 2.2KΩ
Directivity	Omni-directional
Frequency	100-10K Hz
Max operation voltage	10.0 V
Standard operation voltage	3.0 V
Current Consumption	Max 0.5mA
Sensitivity Reduction	Within -3dB at 2.0V
Signal to Noise ratio	More than 55dB
Capacitor build-in	10+33pF

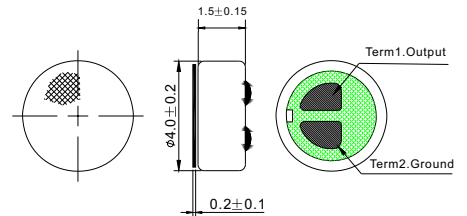
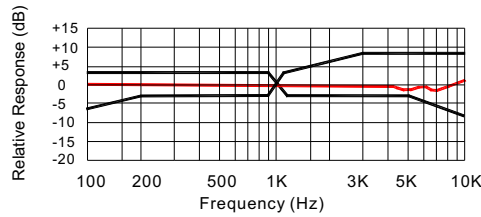

EM4015-BOL-33



Sensitivity	-42±3, -44±3, -46±3dB
Impedance	Less than 2.2KΩ
Directivity	Omni-directional
Frequency	100-10K Hz
Max operation voltage	10.0 V
Standard operation voltage	2.0 V
Current Consumption	Max 0.3mA
Sensitivity Reduction	Within -3dB at 1.5V
Signal to Noise ratio	More than 55dB
Capacitor build-in	10+33pF

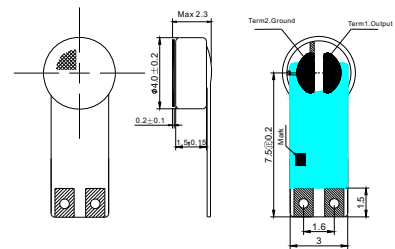
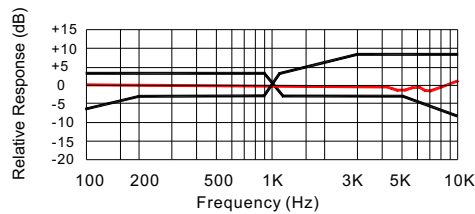

EM4015-BOP-03



Sensitivity	-42±3, -44±3, -46±3dB
Impedance	Less than 2.2KΩ
Directivity	Omni-directional
Frequency	100-10K Hz
Max operation voltage	10.0 V
Standard operation voltage	2.0 V
Current Consumption	Max 0.5mA
Sensitivity Reduction	Within -3dB at 1.5V
Signal to Noise ratio	More than 55dB
Capacitor build-in	10+33pF

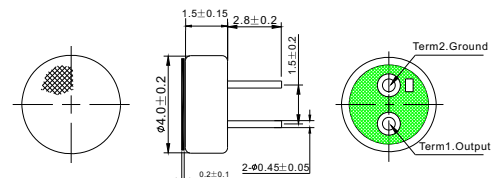
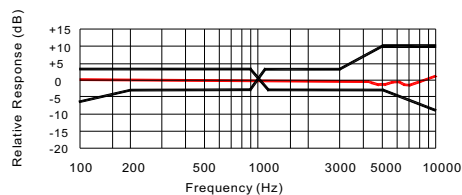

Omnidirectional Back Electret Condenser Microphone

EM4015-BOS-08



Sensitivity $-42\pm 3, -44\pm 3, -46\pm 3\text{dB}$
 Impedance Less than $2.2\text{K}\Omega$
 Directivity Omni-directional
 Frequency 100-10K Hz
 Max operation voltage 10.0 V
 Standard operation voltage 2.0 V
 Current Consumption Max 0.5mA
 Sensitivity Reduction Within -3dB at 1.5V
 Signal to Noise ratio More than 55dB
 Capacitor build-in $10+33\text{pF}$

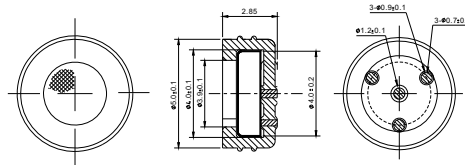
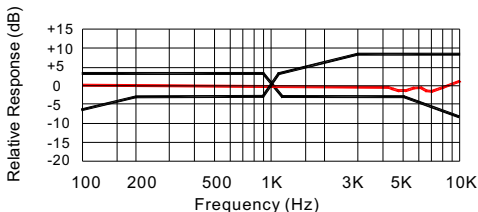

EM4015-BOS-10



Sensitivity $-42\pm 3, -44\pm 3, -46\pm 3\text{dB}$
 Impedance Less than $2.2\text{K}\Omega$
 Directivity Omni-directional
 Frequency 100-10K Hz
 Max operation voltage 10.0 V
 Standard operation voltage 3.0 V
 Current Consumption Max 0.5mA
 Sensitivity Reduction Within -3dB at 2.0V
 Signal to Noise ratio More than 55dB
 Capacitor build-in $10+33\text{pF}$

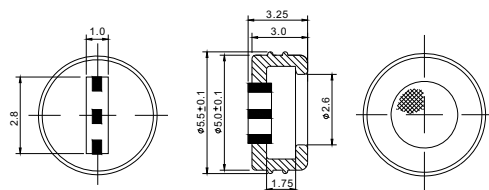
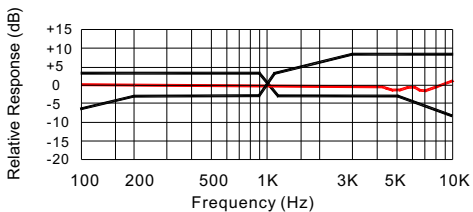

EM4015-BOS-17



Sensitivity $-42\pm 3, -44\pm 3, -46\pm 3\text{dB}$
 Impedance Less than $2.2\text{K}\Omega$
 Directivity Omni-directional
 Frequency 100-10K Hz
 Max operation voltage 10.0 V
 Standard operation voltage 2.0 V
 Current Consumption Max 0.5mA
 Sensitivity Reduction Within -3dB at 1.5V
 Signal to Noise ratio More than 55dB
 Capacitor build-in $10+33\text{pF}$

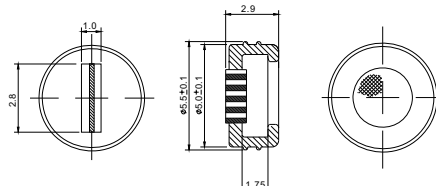
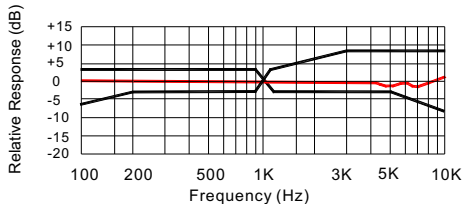

Omnidirectional Back Electret Condenser Microphone

EM4513-BOL-01



Sensitivity	-42±3, -44±3, -46±3dB
Impedance	Less than 2.2KΩ
Directivity	Omni-directional
Frequency	100-10K Hz
Max operation voltage	10.0 V
Standard operation voltage	2.0 V
Current Consumption	Max 0.5mA
Sensitivity Reduction	Within -3dB at 1.5V
Signal to Noise ratio	More than 55dB
Capacitor build-in	10+33pF

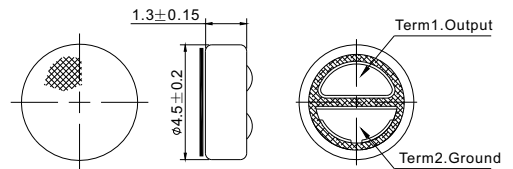
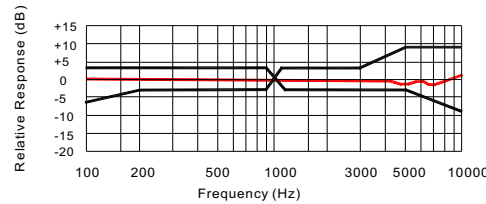

EM4518-BOL-01



Sensitivity	-42±3, -44±3, -46±3dB
Impedance	Less than 2.2KΩ
Directivity	Omni-directional
Frequency	100-10K Hz
Max operation voltage	10.0 V
Standard operation voltage	2.0 V
Current Consumption	Max 0.5mA
Sensitivity Reduction	Within -3dB at 1.5V
Signal to Noise ratio	More than 55dB
Capacitor build-in	10+33pF

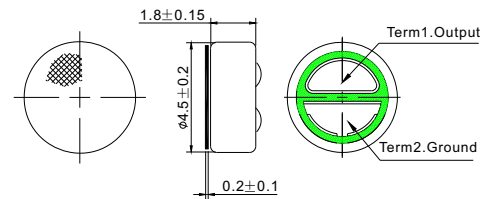
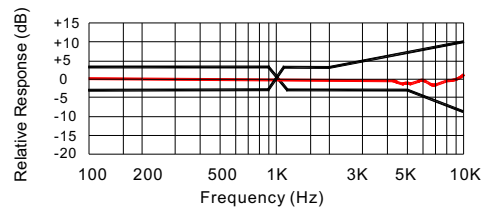

EM4022-BOL-22



Sensitivity	-42±3, -44±3, -46±3dB
Impedance	Less than 2.2KΩ
Directivity	Omni-directional
Frequency	100-10K Hz
Max operation voltage	10.0 V
Standard operation voltage	2.0 V
Current Consumption	Max 0.5mA
Sensitivity Reduction	Within -3dB at 1.5V
Signal to Noise ratio	More than 55dB
Capacitor build-in	10+33pF

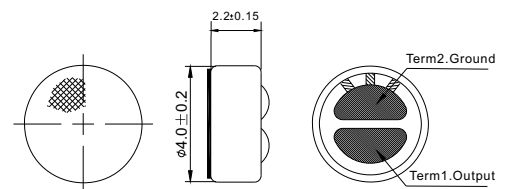
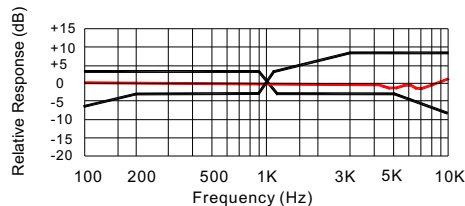

Omnidirectional Back Electret Condenser Microphone

EM5820-BOL-02



Sensitivity	-40±3, -42±3, -44±3dB
Impedance	Less than 2.2KΩ
Directivity	Omni-directional
Frequency	100-10K Hz
Max operation voltage	10.0 V
Standard operation voltage	2.0 V
Current Consumption	Max 0.5mA
Sensitivity Reduction	Within -3dB at 1.5V
Signal to Noise ratio	More than 55dB
Capacitor build-in	10+33pF

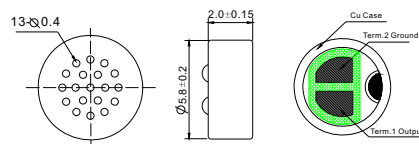
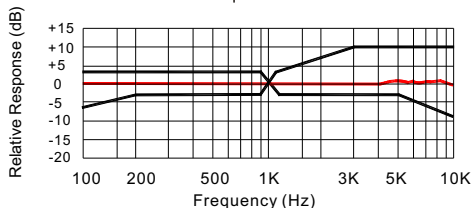

EM6015-BOL-02



Sensitivity	-42±3, -44±3, -46±3dB
Impedance	Less than 2.2KΩ
Directivity	Omni-directional
Frequency	100-10K Hz
Max operation voltage	10.0 V
Standard operation voltage	2.0 V
Current Consumption	Max 0.5mA
Sensitivity Reduction	Within -3dB at 1.5V
Signal to Noise ratio	More than 55dB
Capacitor build-in	10+33pF

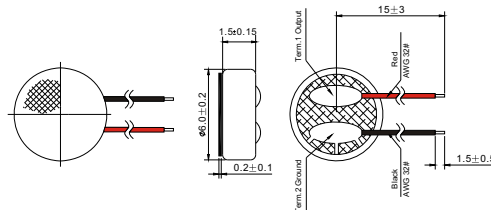
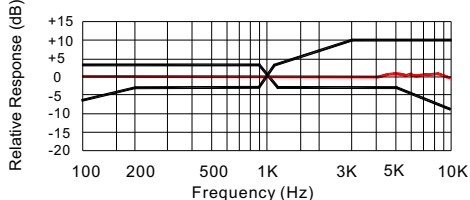

EM6015-BOL-03



Sensitivity	-42±3, -44±3, -46±3dB
Impedance	Less than 2.2KΩ
Directivity	Omni-directional
Frequency	100-10K Hz
Max operation voltage	10.0 V
Standard operation voltage	2.0 V
Current Consumption	Max 0.5mA
Sensitivity Reduction	Within -3dB at 1.5V
Signal to Noise ratio	More than 55dB
Capacitor build-in	10+33pF

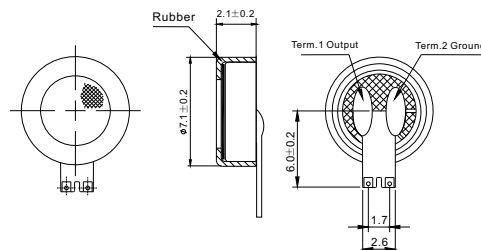
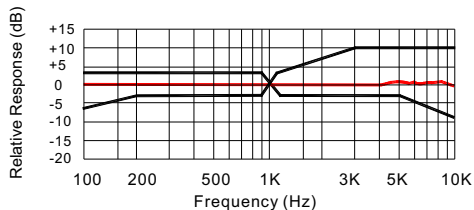

Omnidirectional Back Electret Condenser Microphone

EM6015-BOP-01



Sensitivity	-42±3, -44±3, -46±3dB
Impedance	Less than 2.2KΩ
Directivity	Omni-directional
Frequency	100-10K Hz
Max operation voltage	10.0 V
Standard operation voltage	2.0 V
Current Consumption	Max 0.5mA
Sensitivity Reduction	Within -3dB at 1.5V
Signal to Noise ratio	More than 58dB
Capacitor build-in	10+33pF

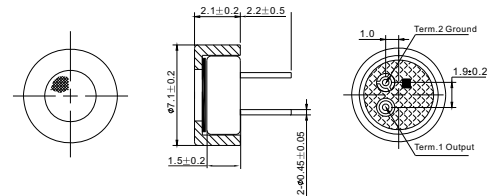
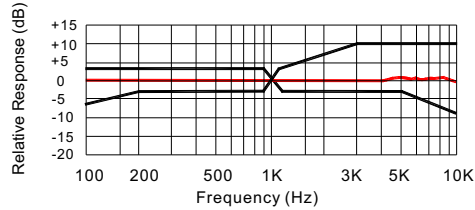

EM6015-BOP-03



Sensitivity	-42±3, -44±3, -46±3dB
Impedance	Less than 2.2KΩ
Directivity	Omni-directional
Frequency	100-10K Hz
Max operation voltage	10.0 V
Standard operation voltage	2.0 V
Current Consumption	Max 0.5mA
Sensitivity Reduction	Within -3dB at 1.5V
Signal to Noise ratio	More than 58dB
Capacitor build-in	10+33pF

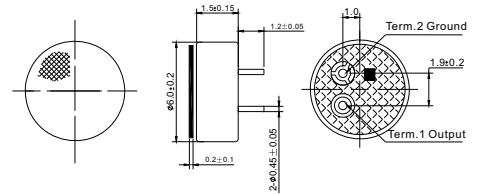
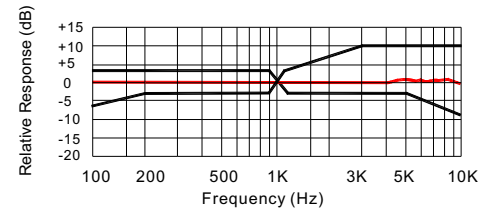

EM6015-BOS-03



Sensitivity	-42±3, -44±3, -46±3dB
Impedance	Less than 2.2KΩ
Directivity	Omni-directional
Frequency	100-10K Hz
Max operation voltage	10.0 V
Standard operation voltage	2.0 V
Current Consumption	Max 0.5mA
Sensitivity Reduction	Within -3dB at 1.5V
Signal to Noise ratio	More than 55dB
Capacitor build-in	10+33pF

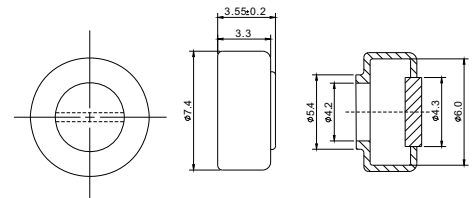
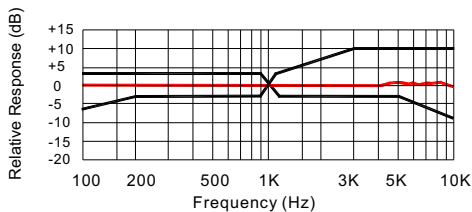

Omnidirectional Back Electret Condenser Microphone

EM6018-BOL-05



Sensitivity	-40±3, -42±3, -44±3dB
Impedance	Less than 2.2KΩ
Directivity	Omni-directional
Frequency	100-10K Hz
Max operation voltage	10.0 V
Standard operation voltage	2.0 V
Current Consumption	Max 0.5mA
Sensitivity Reduction	Within -3dB at 1.5V
Signal to Noise ratio	More than 55dB
Capacitor build-in	10+33pF

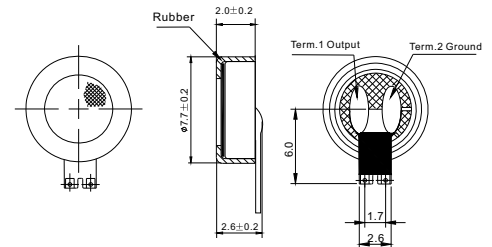
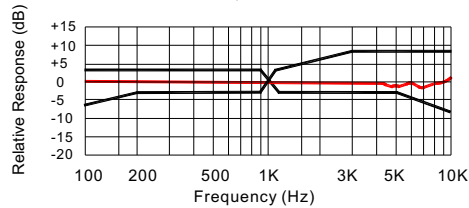

EM6018-BOL-10



Sensitivity	-40±3, -42±3, -44±3dB
Impedance	Less than 2.2KΩ
Directivity	Omni-directional
Frequency	100-10K Hz
Max operation voltage	10.0 V
Standard operation voltage	2.0 V
Current Consumption	Max 0.5mA
Sensitivity Reduction	Within -3dB at 1.5V
Signal to Noise ratio	More than 55dB
Capacitor build-in	10+33pF

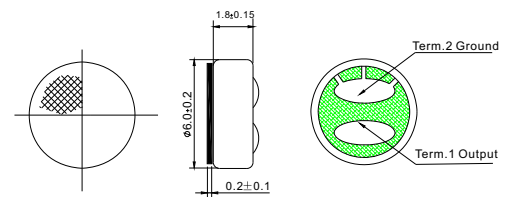
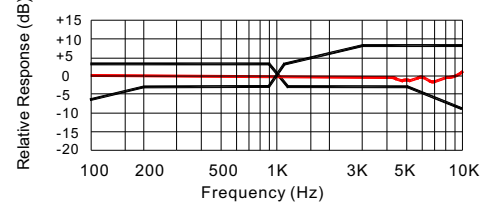

EM6018-BOP-03



Sensitivity	-40±3, -42±3, -44±3dB
Impedance	Less than 2.2KΩ
Directivity	Omni-directional
Frequency	100-10K Hz
Max operation voltage	10.0 V
Standard operation voltage	2.0 V
Current Consumption	Max 0.5mA
Sensitivity Reduction	Within -3dB at 1.5V
Signal to Noise ratio	More than 55dB
Capacitor build-in	10+33pF

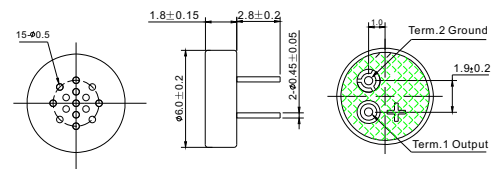
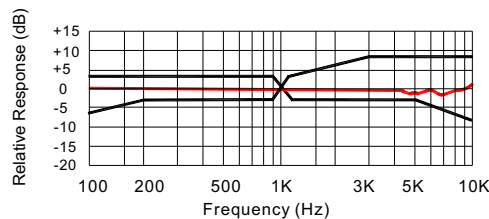

Omnidirectional Back Electret Condenser Microphone

EM6018-BOP-05



Sensitivity	-40±3, -42±3, -44±3dB
Impedance	Less than 2.2KΩ
Directivity	Omn-directional
Frequency	100-10K Hz
Max operation voltage	10.0 V
Standard operation voltage	2.0 V
Current Consumption	Max 0.5mA
Sensitivity Reduction	Within -3dB at 1.5V
Signal to Noise ratio	More than 55dB
Capacitor build-in	10+33pF

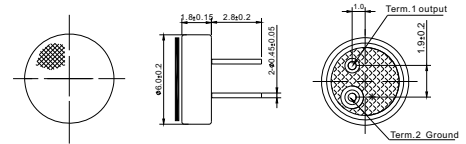
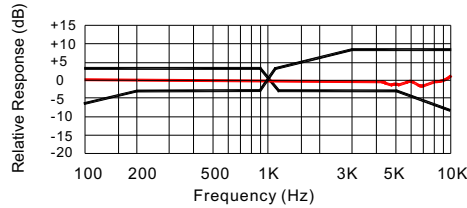

EM6018-BOS-13



Sensitivity	-40±3, -42±3, -44±3dB
Impedance	Less than 2.2KΩ
Directivity	Omn-directional
Frequency	100-10K Hz
Max operation voltage	10.0 V
Standard operation voltage	2.0 V
Current Consumption	Max 0.5mA
Sensitivity Reduction	Within -3dB at 1.5V
Signal to Noise ratio	More than 55dB
Capacitor build-in	10+33pF

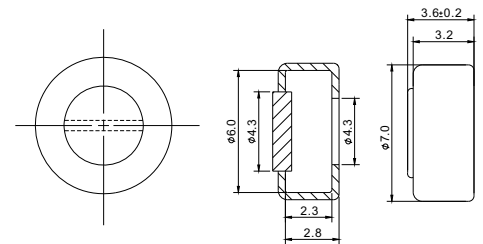
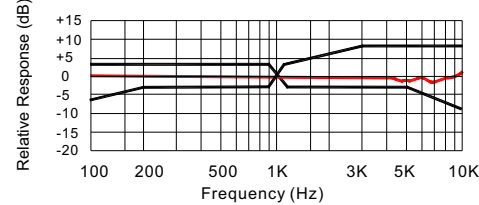

EM6022-BOL-16



Sensitivity	-40±3, -42±3, -44±3dB
Impedance	Less than 2.2KΩ
Directivity	Omn-directional
Frequency	100-10K Hz
Max operation voltage	10.0 V
Standard operation voltage	2.0 V
Current Consumption	Max 0.5mA
Sensitivity Reduction	Within -3dB at 1.5V
Signal to Noise ratio	More than 55dB
Capacitor build-in	10+33pF

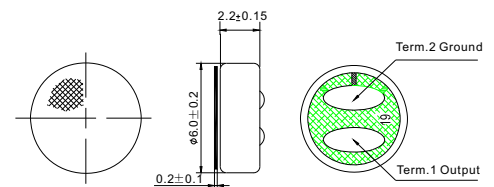
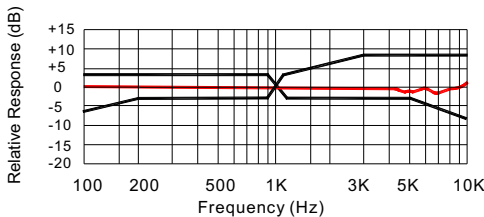

Omnidirectional Back Electret Condenser Microphone

EM6022-BOP-06



Sensitivity	-38±3, -40±3, -42±3dB
Impedance	Less than 2.2KΩ
Directivity	Omni-directional
Frequency	100-10K Hz
Max operation voltage	10.0 V
Standard operation voltage	2.0 V
Current Consumption	Max 0.5mA
Sensitivity Reduction	Within -3dB at 1.5V
Signal to Noise ratio	More than 58dB
Capacitor build-in	10 pF

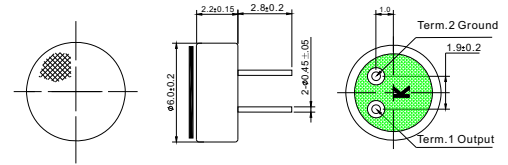
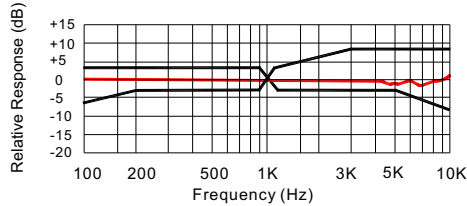

EM6022-BOP-08



Sensitivity	-38±3, -40±3, -40±3dB
Impedance	Less than 2.2KΩ
Directivity	Omni-directional
Frequency	100-10K Hz
Max operation voltage	10.0 V
Standard operation voltage	2.0 V
Current Consumption	Max 0.5mA
Sensitivity Reduction	Within -3dB at 1.5V
Signal to Noise ratio	More than 58dB
Capacitor build-in	10+33pF

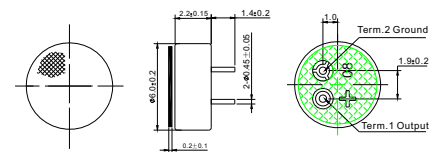
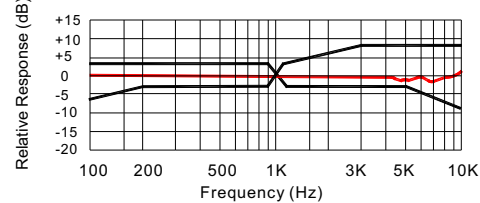

EM6022-BOP-18



Sensitivity	-38±3, -40±3, -42±3dB
Impedance	Less than 2.2KΩ
Directivity	Omni-directional
Frequency	100-10K Hz
Max operation voltage	10.0 V
Standard operation voltage	2.0 V
Current Consumption	Max 0.5mA
Sensitivity Reduction	Within -3dB at 1.5V
Signal to Noise ratio	More than 58dB
Capacitor build-in	10+33pF

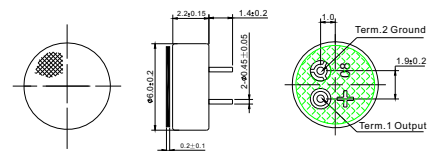
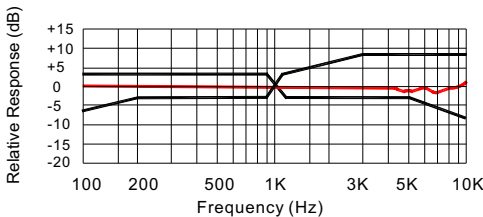

Omnidirectional Back Electret Condenser Microphone

EM6022-BOS-25



Sensitivity	-40±3, -42±3, -44±3dB
Impedance	Less than 2.2KΩ
Directivity	Omni-directional
Frequency	100-10K Hz
Max operation voltage	10.0 V
Standard operation voltage	2.0 V
Current Consumption	Max 0.5mA
Sensitivity Reduction	Within -3dB at 1.5V
Signal to Noise ratio	More than 55dB
Capacitor build-in	10+33 pF

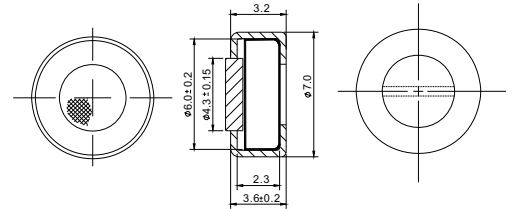
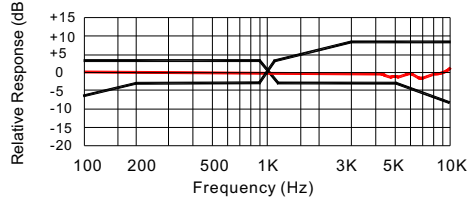

EM6027-BOL-20



Sensitivity	-38±3, -40±3, -40±3dB
Impedance	Less than 2.2KΩ
Directivity	Omni-directional
Frequency	100-10K Hz
Max operation voltage	10.0 V
Standard operation voltage	3.0 V
Current Consumption	Max 0.5mA
Sensitivity Reduction	Within -3dB at 2.0V
Signal to Noise ratio	More than 58dB
Capacitor build-in	10+33pF

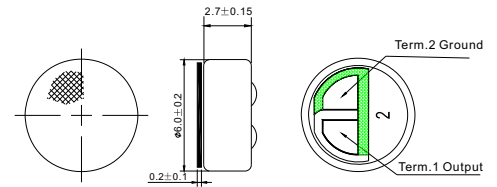
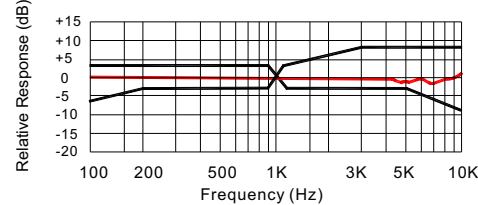

EM6027-BOL-33



Sensitivity	-38±3, -40±3, -42±3dB
Impedance	Less than 2.2KΩ
Directivity	Omni-directional
Frequency	100-10K Hz
Max operation voltage	10.0 V
Standard operation voltage	3.0 V
Current Consumption	Max 0.5mA
Sensitivity Reduction	Within -3dB at 2.0V
Signal to Noise ratio	More than 58dB
Capacitor build-in	10+33pF

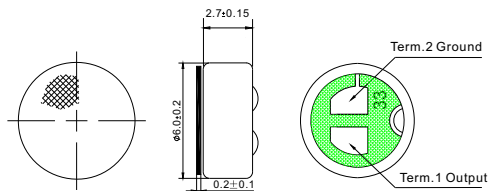
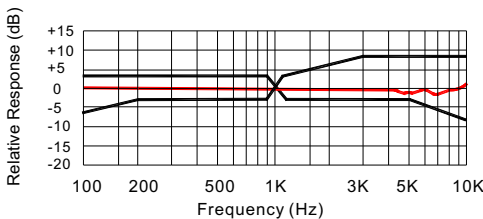

Omnidirectional Back Electret Condenser Microphone

EM6027-BOL-67



Sensitivity	-38±3, -40±3, -42±3dB
Impedance	Less than 2.2KΩ
Directivity	Omni-directional
Frequency	100-10K Hz
Max operation voltage	10.0 V
Standard operation voltage	3.0 V
Current Consumption	Max 0.5mA
Sensitivity Reduction	Within -3dB at 2.0V
Signal to Noise ratio	More than 58dB
Capacitor build-in	10+33 pF

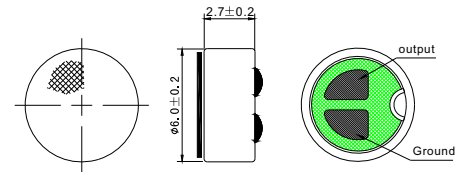
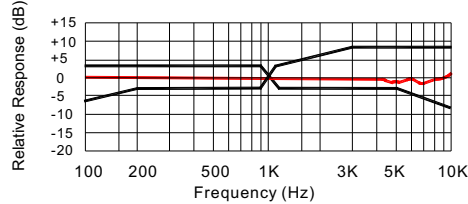

EM6027-BOP-11



Sensitivity	-38±3, -40±3, -40±3dB
Impedance	Less than 2.2KΩ
Directivity	Omni-directional
Frequency	100-10K Hz
Max operation voltage	10.0 V
Standard operation voltage	2.0 V
Current Consumption	Max 0.5mA
Sensitivity Reduction	Within -3dB at 1.5V
Signal to Noise ratio	More than 58dB
Capacitor build-in	10+33pF

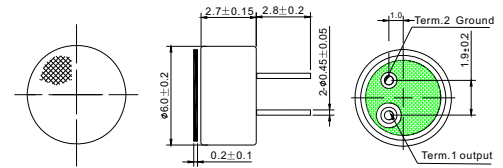
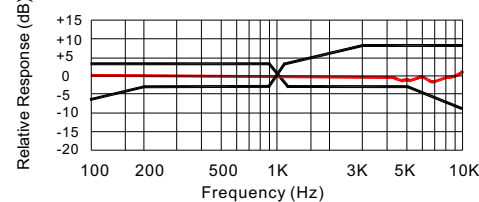

EM6027-BOP-33



Sensitivity	-38±3, -40±3, -42±3dB
Impedance	Less than 2.2KΩ
Directivity	Omni-directional
Frequency	100-10K Hz
Max operation voltage	10.0 V
Standard operation voltage	2.0 V
Current Consumption	Max 0.5mA
Sensitivity Reduction	Within -3dB at 1.5V
Signal to Noise ratio	More than 55dB
Capacitor build-in	10+33pF

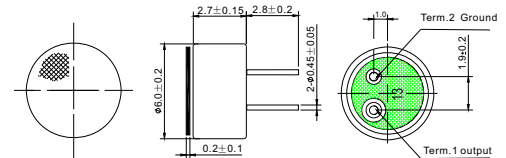
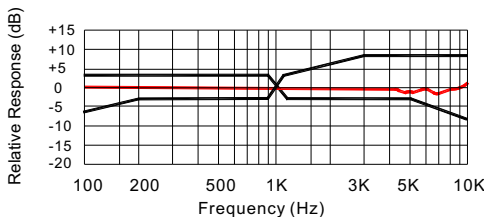

Omnidirectional Back Electret Condenser Microphone

EM6027-BOP-55



Sensitivity	-38±3, -40±3, -42±3dB
Impedance	Less than 2.2KΩ
Directivity	Omni-directional
Frequency	100-10K Hz
Max operation voltage	10.0 V
Standard operation voltage	2.0 V
Current Consumption	Max 0.5mA
Sensitivity Reduction	Within -3dB at 1.5V
Signal to Noise ratio	More than 55dB
Capacitor build-in	10+33 pF

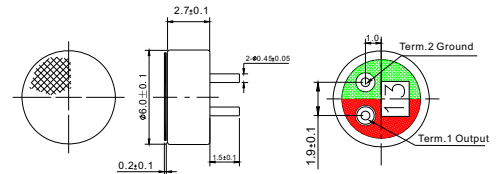
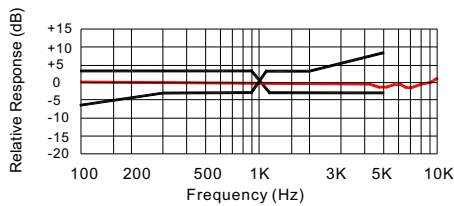

EM6027-BOP-62



Sensitivity	-38±3, -40±3, -40±3dB
Impedance	Less than 2.2KΩ
Directivity	Omni-directional
Frequency	100-10K Hz
Max operation voltage	10.0 V
Standard operation voltage	3.0 V
Current Consumption	Max 0.5mA
Sensitivity Reduction	Within -3dB at 2.0V
Signal to Noise ratio	More than 58dB
Capacitor build-in	10+33pF

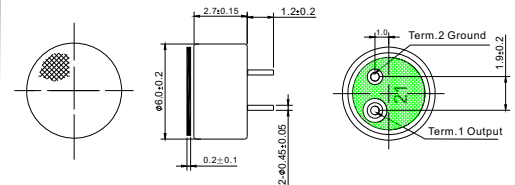
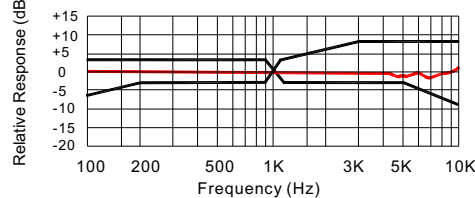

EM6050-BOL-15



Sensitivity	-38±3, -40±3, -42±3dB
Impedance	Less than 2.2KΩ
Directivity	Omni-directional
Frequency	100-10K Hz
Max operation voltage	10.0 V
Standard operation voltage	3.0 V
Current Consumption	Max 0.5mA
Sensitivity Reduction	Within -3dB at 2.0V
Signal to Noise ratio	More than 55dB
Capacitor build-in	10+33pF

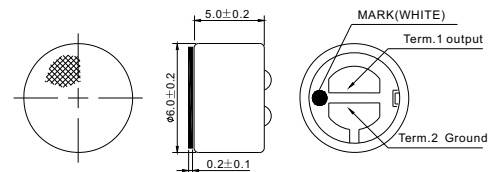
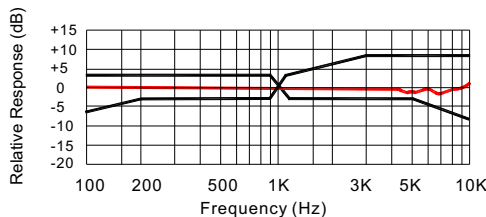

Omnidirectional Back Electret Condenser Microphone

EM6050-BOL-27



Sensitivity	-36±3, -38±3, -40±3dB
Impedance	Less than 2.2KΩ
Directivity	Omni-directional
Frequency	100-10K Hz
Max operation voltage	10.0 V
Standard operation voltage	2.0 V
Current Consumption	Max 0.5mA
Sensitivity Reduction	Within -3dB at 1.5V
Signal to Noise ratio	More than 55dB
Capacitor build-in	10+33 pF

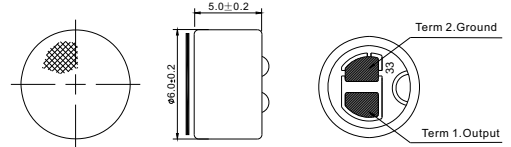
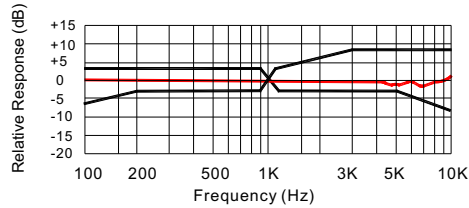

EM9745-BOL-01



Sensitivity	-36±3, -38±3, -40±3dB
Impedance	Less than 2.2KΩ
Directivity	Omni-directional
Frequency	100-10K Hz
Max operation voltage	10.0 V
Standard operation voltage	2.0 V
Current Consumption	Max 0.4mA
Sensitivity Reduction	Within -3dB at 1.5V
Signal to Noise ratio	More than 58dB

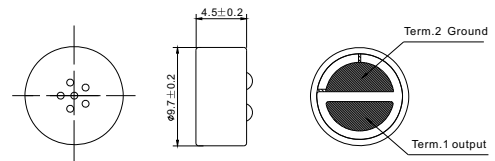
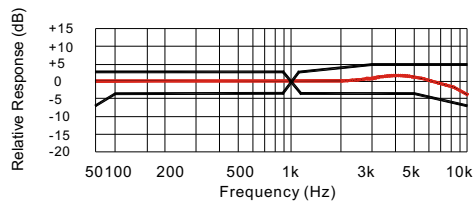

EM9745-BOP-01



Sensitivity	-36±3, -38±3, -40±3dB
Impedance	Less than 2.2KΩ
Directivity	Omni-directional
Frequency	100-10K Hz
Max operation voltage	10.0 V
Standard operation voltage	1.5 V
Current Consumption	Max 0.4mA
Sensitivity Reduction	Within -3dB at 1.1V
Signal to Noise ratio	More than 60dB
Capacitor build-in	33pF

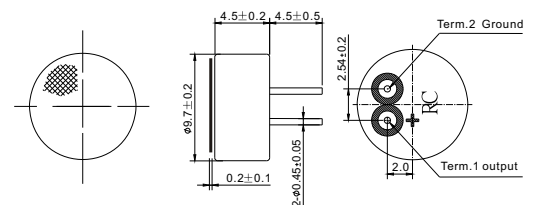
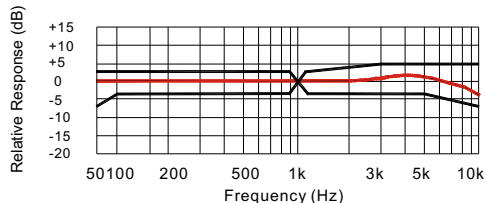

Omnidirectional Film Electret Condenser Microphone

EM4010-TOL-01

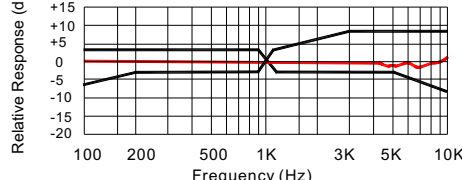
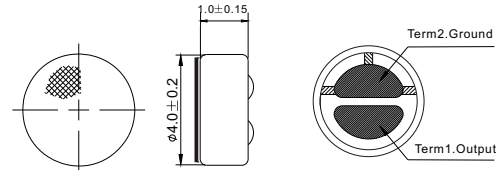

Sensitivity	-42±3, -44±3, -46±3dB
Impedance	Less than 2.2KΩ
Directivity	Omni-directional
Frequency	100-10K Hz
Max operation voltage	10.0 V
Standard operation voltage	2.0 V
Current Consumption	Max 0.5mA
Sensitivity Reduction	Within -3dB at 1.5V
Signal to Noise ratio	More than 55dB
Capacitor build-in	10+33 pF

EM6010-TOL-01



Sensitivity	-42±3, -44±3, -46±3dB
Impedance	Less than 2.2KΩ
Directivity	Omni-directional
Frequency	100-10K Hz
Max operation voltage	10.0 V
Standard operation voltage	2.0 V
Current Consumption	Max 0.5mA
Sensitivity Reduction	Within -3dB at 1.5V
Signal to Noise ratio	More than 55dB
Capacitor build-in	10+33 pF

EM6010-TOL-05

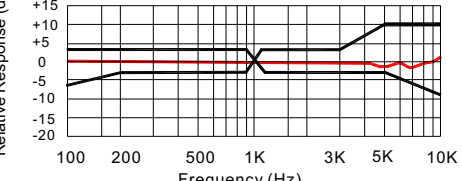
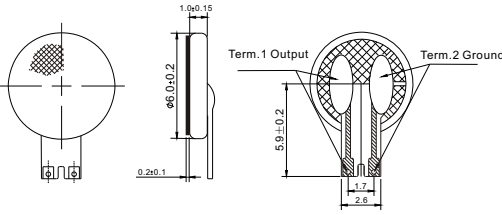

Sensitivity	-42±3, -44±3, -46±3dB
Impedance	Less than 2.2KΩ
Directivity	Omni-directional
Frequency	100-10K Hz
Max operation voltage	10.0 V
Standard operation voltage	2.0 V
Current Consumption	Max 0.5mA
Sensitivity Reduction	Within -3dB at 1.5V
Signal to Noise ratio	More than 55dB
Capacitor build-in	10+33pF



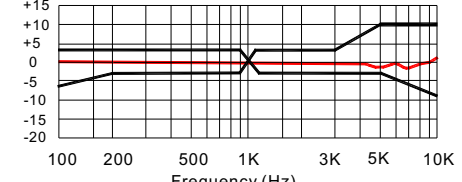
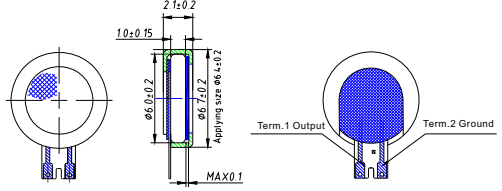

Omnidirectional Film Electret Condenser Microphone

EM6010-TOL-08

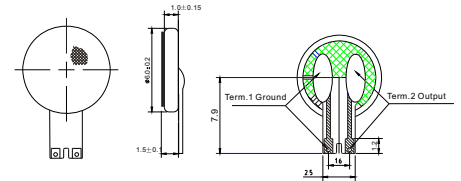
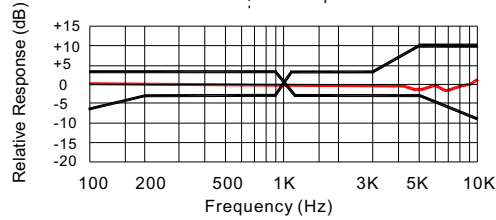

Sensitivity	-42±3, -44±3, -46±3dB
Impedance	Less than 2.2KΩ
Directivity	Omni-directional
Frequency	100-10K Hz
Max operation voltage	10.0 V
Standard operation voltage	3.0 V
Current Consumption	Max 0.5mA
Sensitivity Reduction	Within -3dB at 2.0V
Signal to Noise ratio	More than 55dB
Capacitor build-in	10+33 pF



EM6010-TOL-10



Sensitivity	-42±3, -44±3, -46±3dB
Impedance	Less than 2.2KΩ
Directivity	Omni-directional
Frequency	100-10K Hz
Max operation voltage	10.0 V
Standard operation voltage	2.0 V
Current Consumption	Max 0.5mA
Sensitivity Reduction	Within -3dB at 1.5V
Signal to Noise ratio	More than 55dB
Capacitor build-in	10+33 pF

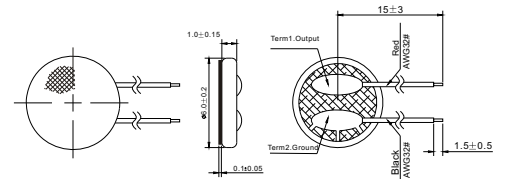
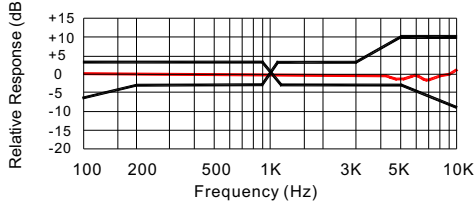

EM6010-TOP-01



Sensitivity	-42±3, -44±3, -46±3dB
Impedance	Less than 2.2KΩ
Directivity	Omni-directional
Frequency	100-10K Hz
Max operation voltage	10.0 V
Standard operation voltage	2.0 V
Current Consumption	Max 0.5mA
Sensitivity Reduction	Within -3dB at 1.5V
Signal to Noise ratio	More than 55dB
Capacitor build-in	10+33pF

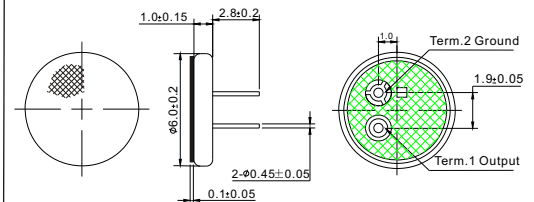
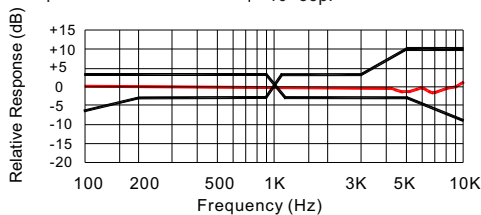

Omnidirectional Film Electret Condenser Microphone

EM6010-TOP-04



Sensitivity	-42±3, -44±3, -46±3dB
Impedance	Less than 2.2KΩ
Directivity	Omni-directional
Frequency	100-10K Hz
Max operation voltage	10.0 V
Standard operation voltage	3.0 V
Current Consumption	Max 0.5mA
Sensitivity Reduction	Within -3dB at 2.0V
Signal to Noise ratio	More than 55dB
Capacitor build-in	10+33 pF

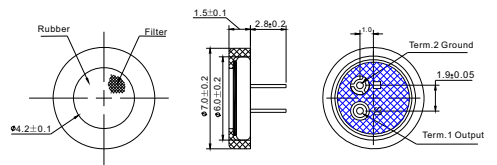
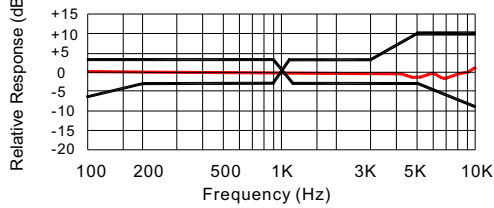

EM6010-TOS-01



Sensitivity	-42±3, -44±3, -46±3dB
Impedance	Less than 2.2KΩ
Directivity	Omni-directional
Frequency	100-10K Hz
Max operation voltage	10.0 V
Standard operation voltage	2.0 V
Current Consumption	Max 0.5mA
Sensitivity Reduction	Within -3dB at 1.5V
Signal to Noise ratio	More than 55dB
Capacitor build-in	10+33 pF

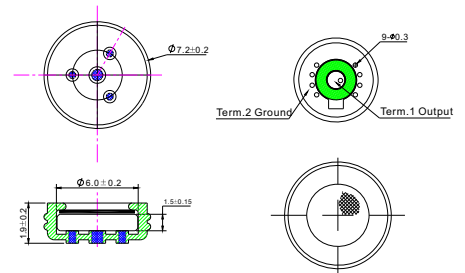
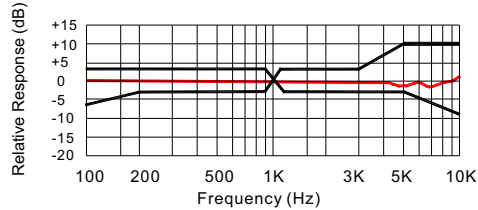

EM6010-TOS-06



Sensitivity	-42±3, -44±3, -46±3dB
Impedance	Less than 2.2KΩ
Directivity	Omni-directional
Frequency	100-10K Hz
Max operation voltage	10.0 V
Standard operation voltage	2.0 V
Current Consumption	Max 0.5mA
Sensitivity Reduction	Within -3dB at 1.5V
Signal to Noise ratio	More than 55dB
Capacitor build-in	10+33pF

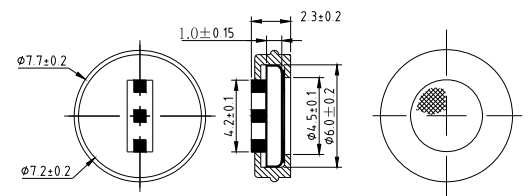
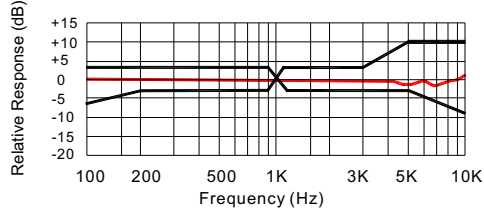

Omnidirectional Film Electret Condenser Microphone

EM6013-TOL-15



Sensitivity	-42±3, -44±3, -46±3dB
Impedance	Less than 2.2KΩ
Directivity	Omni-directional
Frequency	100-10K Hz
Max operation voltage	10.0 V
Standard operation voltage	2.0 V
Current Consumption	Max 0.5mA
Sensitivity Reduction	Within -3dB at 1.5V
Signal to Noise ratio	More than 55dB
Capacitor build-in	10+33 pF

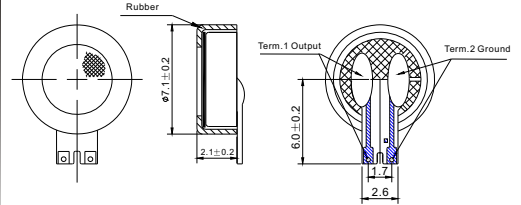
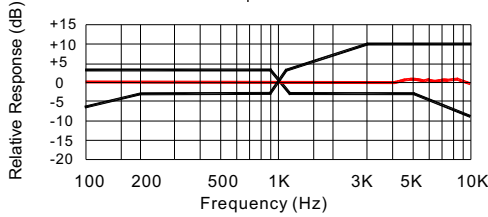

EM6013-TOP-10



Sensitivity	-42±3, -44±3, -46±3dB
Impedance	Less than 2.2KΩ
Directivity	Omni-directional
Frequency	100-10K Hz
Max operation voltage	10.0 V
Standard operation voltage	2.0 V
Current Consumption	Max 0.5mA
Sensitivity Reduction	Within -3dB at 1.5V
Signal to Noise ratio	More than 55dB
Capacitor build-in	10+33 pF

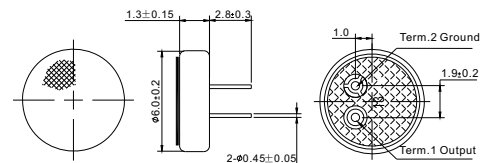
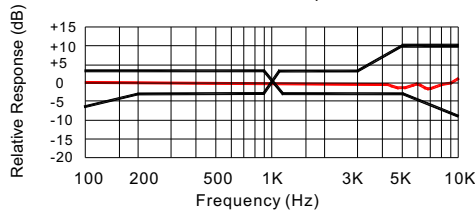

EM6013-TOS-05



Sensitivity	-42±3, -44±3, -46±3dB
Impedance	Less than 2.2KΩ
Directivity	Omni-directional
Frequency	100-10K Hz
Max operation voltage	10.0 V
Standard operation voltage	2.0 V
Current Consumption	Max 0.5mA
Sensitivity Reduction	Within -3dB at 1.5V
Signal to Noise ratio	More than 55dB
Capacitor build-in	10+33pF

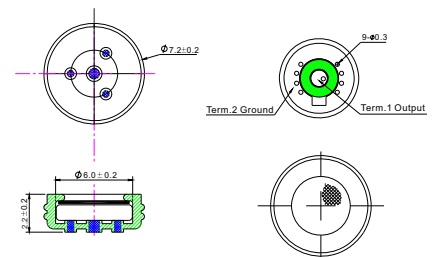
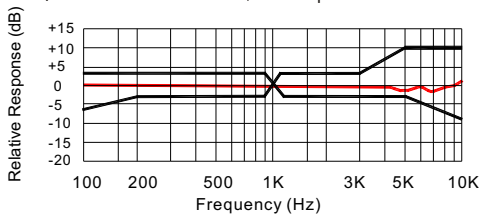

Omnidirectional Foil Electret Condenser Microphone

EM9745-FOL-21



Sensitivity	-42±3, -44±3, -46±3dB
Impedance	Less than 2.2KΩ
Directivity	Omni-directional
Frequency	100-10K Hz
Max operation voltage	10.0 V
Standard operation voltage	3.0 V
Current Consumption	Max 0.5mA
Sensitivity Reduction	Within -3dB at 2.0V
Signal to Noise ratio	More than 55dB

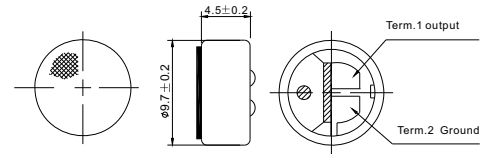
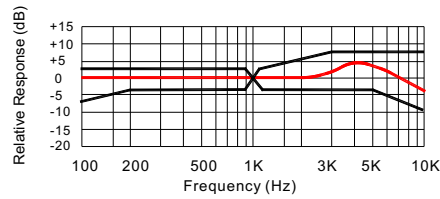

EM9745-FOL-27



Sensitivity	-36±3, -38±3, -40±3dB
Impedance	Less than 2.2KΩ
Directivity	Omni-directional
Frequency	100-10K Hz
Max operation voltage	10.0 V
Standard operation voltage	4.5 V
Current Consumption	Max 0.5mA
Sensitivity Reduction	Within -3dB at 3.0V
Signal to Noise ratio	More than 55dB

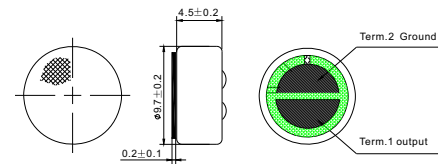
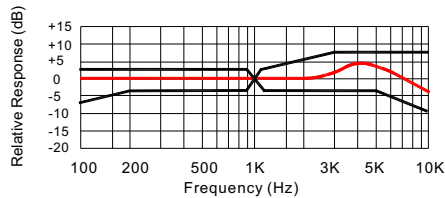

EM9745-FOP-01



Sensitivity	-36±3, -38±3, -40±3dB
Impedance	Less than 2.2KΩ
Directivity	Omni-directional
Frequency	100-10K Hz
Max operation voltage	10.0 V
Standard operation voltage	3.0 V
Current Consumption	Max 0.5mA
Sensitivity Reduction	Within -3dB at 2.0V
Signal to Noise ratio	More than 55dB

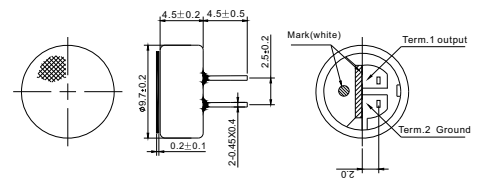
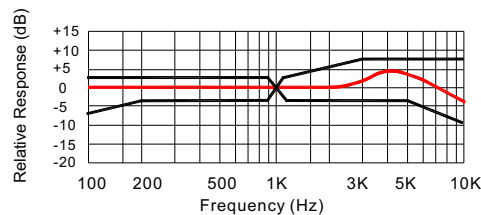

Omnidirectional Foil Electret Condenser Microphone

EM9745-FOP-03



Sensitivity	-36±3, -38±3, -40±3dB
Impedance	Less than 2.2KΩ
Directivity	Omn-directional
Frequency	100-10K Hz
Max operation voltage	10.0 V
Standard operation voltage	1.5 V
Current Consumption	Max 0.5mA
Sensitivity Reduction	Within -3dB at 1.1V
Signal to Noise ratio	More than 55dB

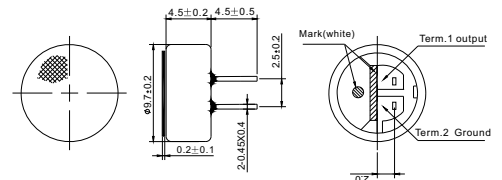
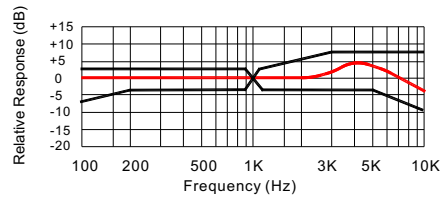

EM9745-FOP-07



Sensitivity	-36±3, -38±3, -40±3dB
Impedance	Less than 2.2KΩ
Directivity	Omn-directional
Frequency	100-10K Hz
Max operation voltage	10.0 V
Standard operation voltage	3.0V
Current Consumption	Max 0.5mA
Sensitivity Reduction	Within -3dB at 2.0V
Signal to Noise ratio	More than 55dB

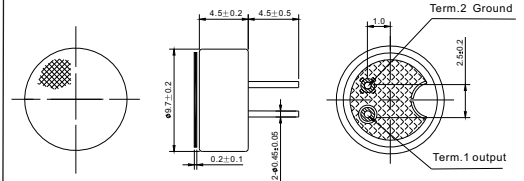
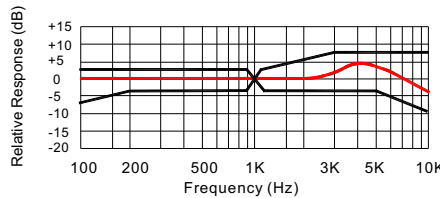

EM9745-FOP-50



Sensitivity	-36±3, -38±3, -40±3dB
Impedance	Less than 2.2KΩ
Directivity	Omn-directional
Frequency	100-10K Hz
Max operation voltage	10.0 V
Standard operation voltage	3.0 V
Current Consumption	Max 0.5mA
Sensitivity Reduction	Within -3dB at 2.0V
Signal to Noise ratio	More than 55dB

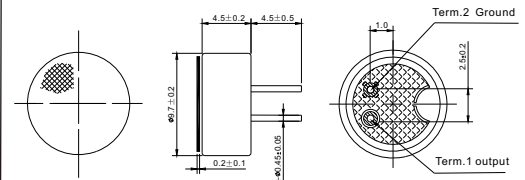
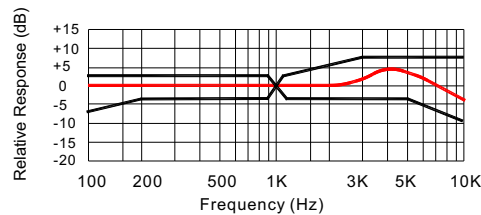

Omnidirectional Foil Electret Condenser Microphone

EM9745-FOP-62



Sensitivity	-36±3, -38±3, -40±3dB
Impedance	Less than 2.2KΩ
Directivity	Omni-directional
Frequency	100-10K Hz
Max operation voltage	10.0 V
Standard operation voltage	2.0 V
Current Consumption	Max 0.5mA
Sensitivity Reduction	Within -3dB at 1.1V
Signal to Noise ratio	More than 55dB

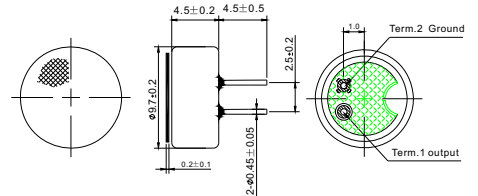
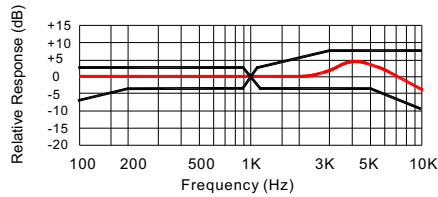

EM9750-FOP-06



Sensitivity	-36±3, -38±3, -40±3dB
Impedance	Less than 2.2KΩ
Directivity	Omni-directional
Frequency	100-10K Hz
Max operation voltage	10.0 V
Standard operation voltage	4.5V
Current Consumption	Max 0.5mA
Sensitivity Reduction	Within -3dB at 3.0V
Signal to Noise ratio	More than 55dB

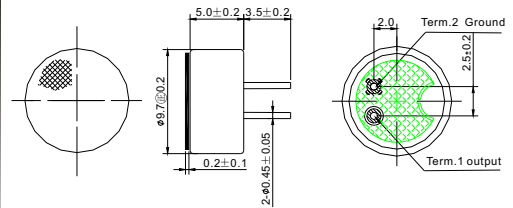
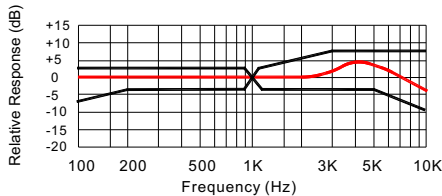

EM9767-FOL-02



Sensitivity	-36±3, -38±3, -40±3dB
Impedance	Less than 2.2KΩ
Directivity	Omni-directional
Frequency	100-10K Hz
Max operation voltage	10.0 V
Standard operation voltage	4.5 V
Current Consumption	Max 0.5mA
Sensitivity Reduction	Within -3dB at 3.0V
Signal to Noise ratio	More than 55dB

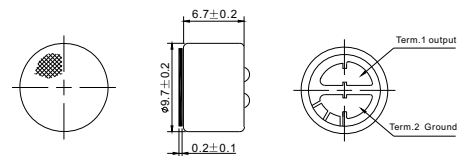
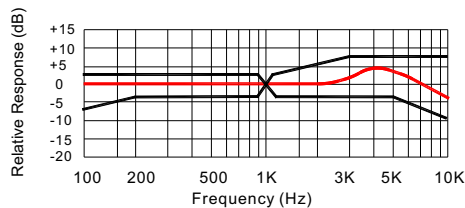

Omnidirectional Foil Electret Condenser Microphone

EM9767-FOL-42



Sensitivity	-36±3, -38±3, -40±3dB
Impedance	Less than 2.2KΩ
Directivity	Omni-directional
Frequency	100-10K Hz
Max operation voltage	10.0 V
Standard operation voltage	4.5 V
Current Consumption	Max 0.5mA
Sensitivity Reduction	Within -3dB at 3.0V
Signal to Noise ratio	More than 55dB

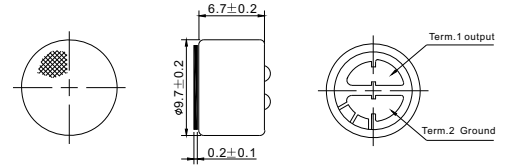
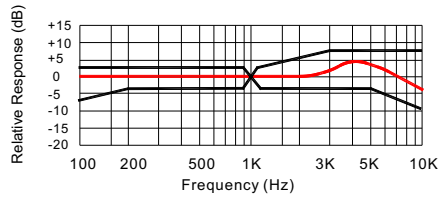

EM9767-FOL-57



Sensitivity	-36±3, -38±3, -40±3dB
Impedance	Less than 2.2KΩ
Directivity	Omni-directional
Frequency	100-10K Hz
Max operation voltage	10.0 V
Standard operation voltage	4.5V
Current Consumption	Max 0.5mA
Sensitivity Reduction	Within -3dB at 3.0V
Signal to Noise ratio	More than 55dB

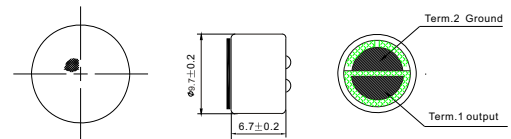
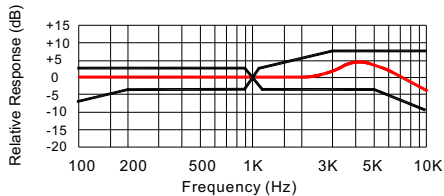

EM9767-FOP-02



Sensitivity	-36±3, -38±3, -40±3dB
Impedance	Less than 2.2KΩ
Directivity	Omni-directional
Frequency	100-10K Hz
Max operation voltage	10.0 V
Standard operation voltage	4.5 V
Current Consumption	Max 0.5mA
Sensitivity Reduction	Within -3dB at 3.0V
Signal to Noise ratio	More than 60dB

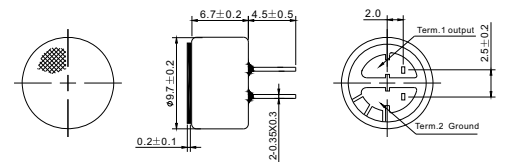
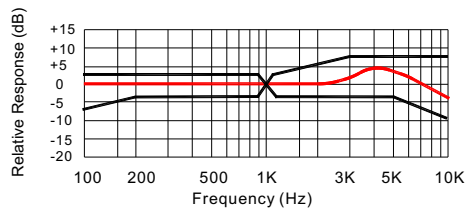

Unidirectional Back Electret Condenser Microphone

EM4022-BUL-01



Sensitivity $-42\pm 3, -44\pm 3, -46\pm 3\text{dB}$
 Impedance Less than $2.2\text{K}\Omega$
 Directivity Uni-directional
 Frequency 100-10K Hz
 Max operation voltage 10.0 V
 Standard operation voltage 3.0 V
 Current Consumption Max 0.5mA
 Sensitivity Reduction Within -3dB at 2.0V
 Signal to Noise ratio More than 55dB
 Capacitor build-in 10 pF

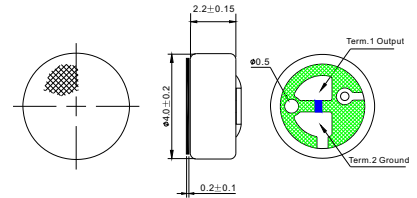
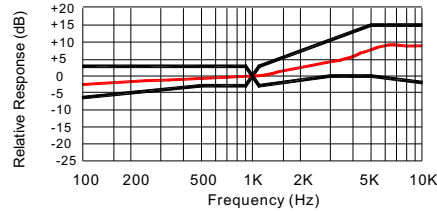

EM5820-BUL-02



Sensitivity $-44\pm 3, -46\pm 3, -48\pm 3\text{dB}$
 Impedance Less than $2.2\text{K}\Omega$
 Directivity Uni-directional
 Frequency 100-10K Hz
 Max operation voltage 10.0 V
 Standard operation voltage 3.0 V
 Current Consumption Max 0.5mA
 Sensitivity Reduction Within -3dB at 2.0V
 Signal to Noise ratio More than 50dB
 Capacitor build-in $33+180\text{ pF}$

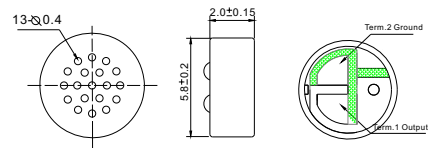
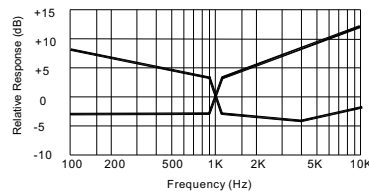

EM6022-BUL-05



Sensitivity $-44\pm 3, -46\pm 3, -48\pm 3\text{dB}$
 Impedance Less than $2.2\text{K}\Omega$
 Directivity Uni-directional
 Frequency 100-10K Hz
 Max operation voltage 10.0 V
 Standard operation voltage 2.0 V
 Current Consumption Max 0.5mA
 Sensitivity Reduction Within -3dB at 1.5V
 Signal to Noise ratio More than 50dB
 Capacitor build-in $10+33\text{ pF}$

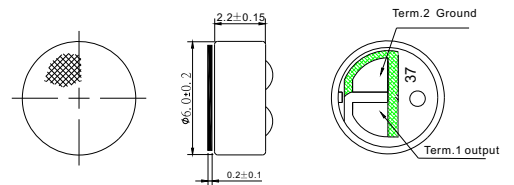
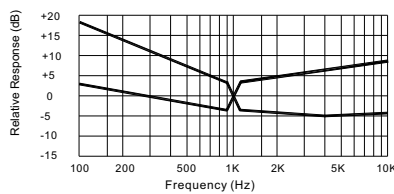

Unidirectional Back Electret Condenser Microphone

EM6022-BUL-01

Sensitivity	-44±3, -46±3, -48±3dB
Impedance	Less than 2.2KΩ
Directivity	Uni-directional
Frequency	100-10K Hz
Max operation voltage	10.0 V
Standard operation voltage	2.0 V
Current Consumption	Max 0.5mA
Sensitivity Reduction	Within -3dB at 1.5V
Signal to Noise ratio	More than 50dB

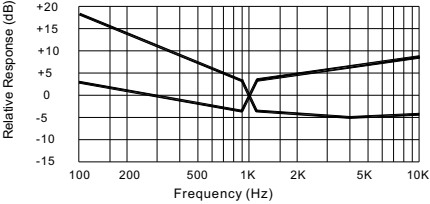
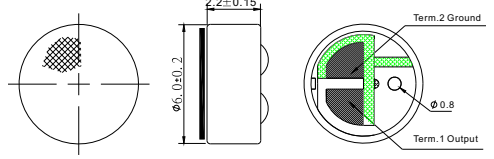
EM6027-BUL-03

Sensitivity	-44±3, -46±3, -48±3dB
Impedance	Less than 2.2KΩ
Directivity	Uni-directional
Frequency	100-10K Hz
Max operation voltage	10.0 V
Standard operation voltage	3.0 V
Current Consumption	Max 0.5mA
Sensitivity Reduction	Within -3dB at 2.0V
Signal to Noise ratio	More than 50dB
Capacitor build-in	33+180 pF

EM6027-BUL-36

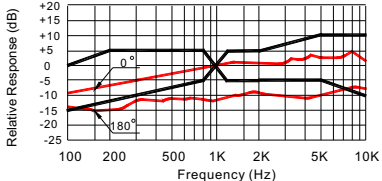
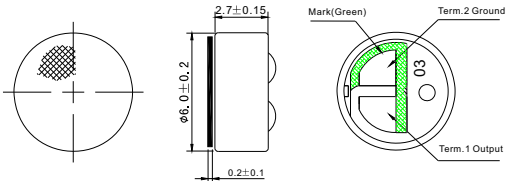
Sensitivity	-44±3, -46±3, -48±3dB
Impedance	Less than 2.2KΩ
Directivity	Uni-directional
Frequency	100-10K Hz
Max operation voltage	10.0 V
Standard operation voltage	3.0 V
Current Consumption	Max 0.3mA
Sensitivity Reduction	Within -3dB at 2.0V
Signal to Noise ratio	More than 55dB
Capacitor build-in	10+33pF

Unidirectional Back Electret Condenser Microphone

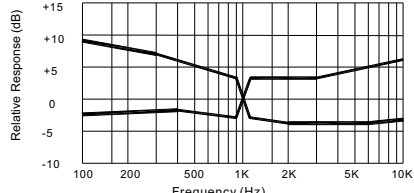
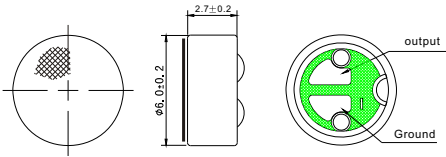
EM6050-BUL-02



Sensitivity	-38±3, -40±3, -42±3dB
Impedance	Less than 2.2KΩ
Directivity	Uni-directional
Frequency	100-10K Hz
Max operation voltage	10.0 V
Standard operation voltage	3.0 V
Current Consumption	Max 0.5mA
Sensitivity Reduction	Within -3dB at 2.0V
Signal to Noise ratio	More than 60dB

Frequency in Cycles Per Second(1 inch testing)

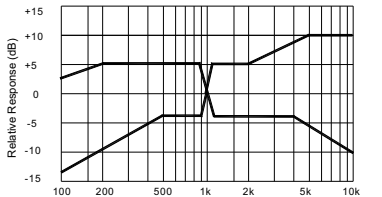
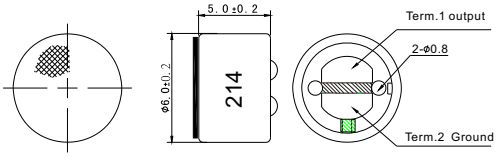



EM9730-BUL-01

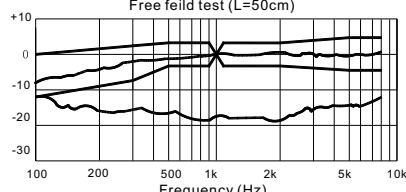
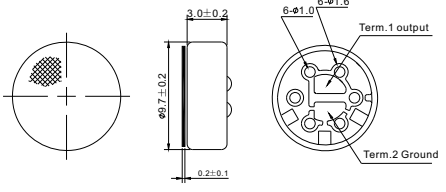

Sensitivity	-38±3, -40±3, -42±3dB
Impedance	Less than 680 Ω
Directivity	Uni-directional
Frequency	100-10K Hz
Max operation voltage	10.0 V
Standard operation voltage	3.0 V
Current Consumption	Max 0.5mA
Sensitivity Reduction	Within -3dB at 2.0V
Signal to Noise ratio	More than 55dB
Capacitor build-in	33+10+7pF

Free feild test (L=50cm)





EM9750-BUL-02

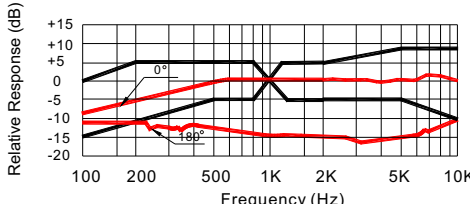
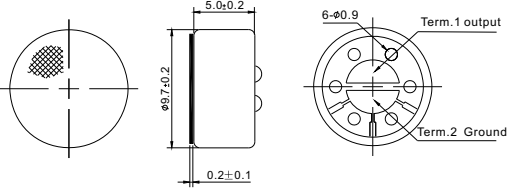

Sensitivity	-38±3, -40±3, -42±3dB
Impedance	Less than 680 Ω
Directivity	Uni-directional
Frequency	100-10K Hz
Max operation voltage	10.0 V
Standard operation voltage	1.5 V
Current Consumption	Max 0.5mA
Sensitivity Reduction	Within -3dB at 1.1V
Signal to Noise ratio	More than 50dB

Relative Response (dB)

Bi-directional Back Electret Condenser Microphone

EM4015-BNL-04



Sensitivity	-48±3, -50±3, -52±3dB
Impedance	Less than 2.2KΩ
Directivity	Bi-directional
Frequency	100-10K Hz
Max operation voltage	10.0 V
Standard operation voltage	2.0 V
Current Consumption	Max 0.5mA
Sensitivity Reduction	Within -3dB at 1.5V
Signal to Noise ratio	More than 50dB

Frequency Response(1 inch measurement)

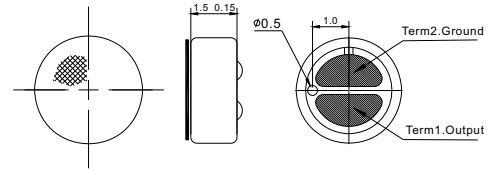
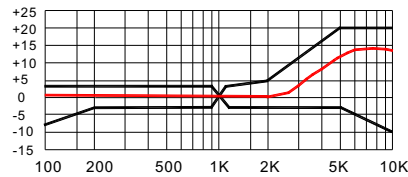

EM6022-BNL-02



Sensitivity	-46±3, -48±3, -50±3dB
Impedance	Less than 2.2KΩ
Directivity	Bi-directional
Frequency	100-10K Hz
Max operation voltage	10.0 V
Standard operation voltage	3.0 V
Current Consumption	Max 0.5mA
Sensitivity Reduction	Within -3dB at 1.5V
Signal to Noise ratio	More than 50dB
Capacitor build-in	10+33pF

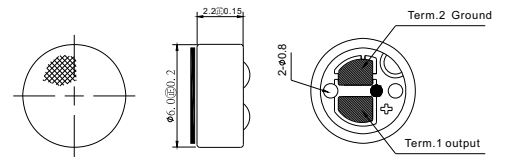
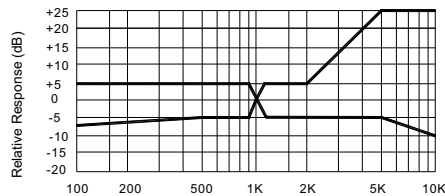

EM6027-BNL-30



Sensitivity	-44±3, -46±3, -48±3dB
Impedance	Less than 2.2KΩ
Directivity	Bi-directional
Frequency	100-10K Hz
Max operation voltage	10.0 V
Standard operation voltage	3.0 V
Current Consumption	Max 0.5mA
Sensitivity Reduction	Within -3dB at 2.0V
Signal to Noise ratio	More than 50dB
Capacitor build-in	10+33+82pF

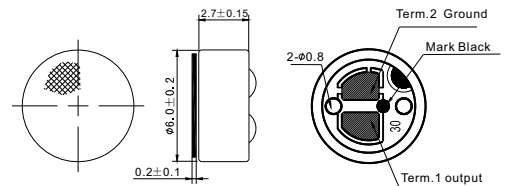
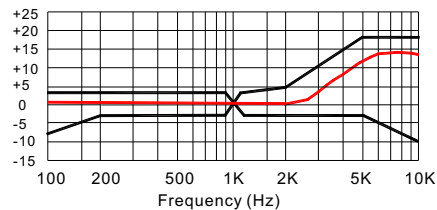

Specifications For Receiver&Speaker

RSR-1027-032W-01



Parameter	Data	Specifications	Unit
Impedance At 1KHz		32 ±15%	Ω
Sensitivity At 1KHz / 100mV (0dB=20 μ Pa)		100±3	dB
Operating Power (Nom/Max)		10/30	mW
Total Harmonic Distortion At 1KHz/ Nom. Power		MAX. 5	%
Buzz & Rattles		0.57V at 300 ~ 3.4kHz	Sine wave
Weight		1.0 ± 0.2	gr

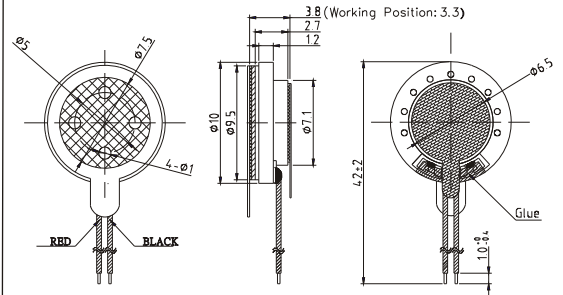
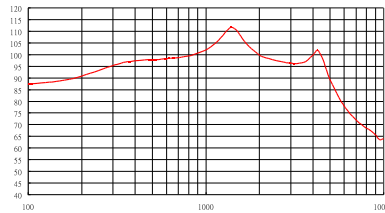

RSR-1327-150L-01

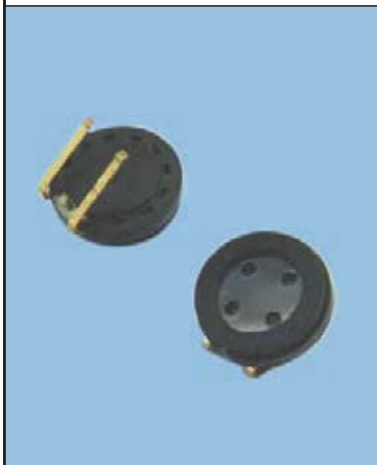

Parameter	Data	Specifications	Unit
Impedance 1 KHz		150 ±15%	Ω
Sensitivity At 1K Hz/ 100mV with IEC 318 coupler		94 ± 3	dB
Operating Power (Nom/Max)		10/30	mW
Total Harmonic Distortion 1 KHz/ Nom.power		Max. 5	%
Buzz & Rattles		1.22V/300~ 3.4 KHz	Sine wave
Weight		1.0 ± 0.2	gr

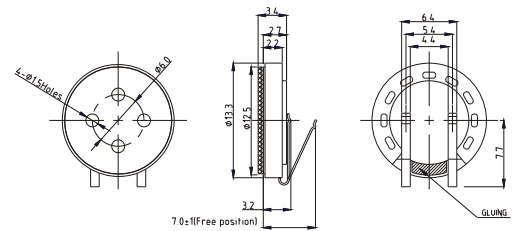
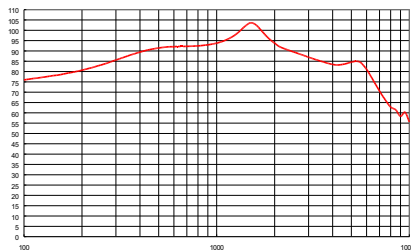

RSR-1327-150P-01



Parameter	Data	Specifications	Unit
Impedance At 1KHz		150 ±15%	Ω
Sensitivity At 1KHz / 100mV (0dB=20 μ Pa)		100±3	dB
Operating Power (Nom/Max)		10/30	mW
Total Harmonic Distortion At 1KHz/ Nom. Power		MAX. 5	%
Buzz & Rattles		1.22V at 300 ~ 3.4KHz	Sine wave
Weight		1.2 ± 0.2	gr

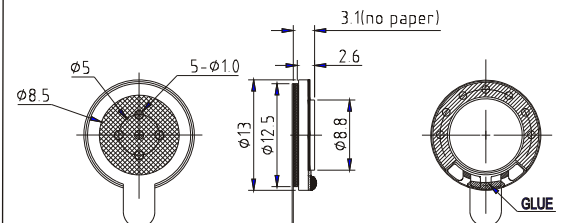
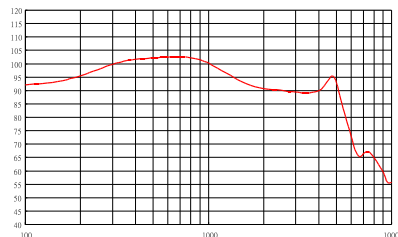

Specifications For Receiver & Speaker

RSR-1335-150L-01



Parameter	Data	Specifications	Unit
Impedance At 1KHz		150 ±15%	Ω
Sensitivity At 1KHz /100mV/0dB=20 μ Pa)		100±3	dB
Operating Power (Nom/Max)		10/30	mW
Total Harmonic Distortion At 1KHz/ Nom. Power		MAX. 5	%
Buzz & Rattles		1.22V at 300 ~ 3.4kHz	Sine wave
Weight		1.2 ± 0.2	gr

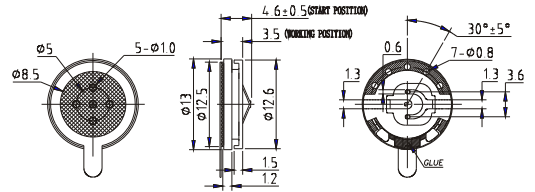
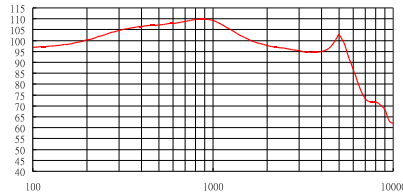

RSR-13525A-032P-01

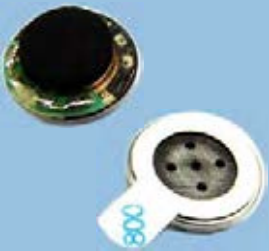

Parameter	Data	Specifications	Unit
Impedance 1 KHz		32 ± 15 %	Ω
Sensitivity At 1K Hz/100mV/0dB=20μPa)		103± 3	dB
Max Operating Power		100	mW
Total Harmonic Distortion 1 KHz/ Nom. power		Max. 5	%
Magnetic Field Intensity At 1KHz 0dB=1A/M (IEA Standard)		Axial : -47 Radial : -76	dB
Buzz & Rattles		1.79V/300~ 3.4 KHz	Sine wave
Weight		1.2 ± 0.2	gr

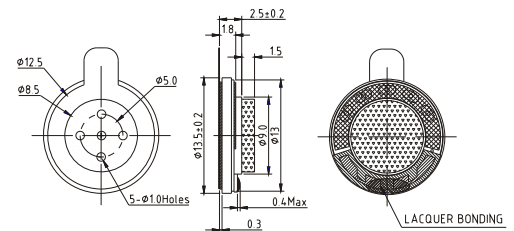
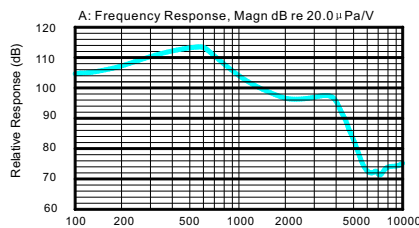

RSR-1530-150P-01

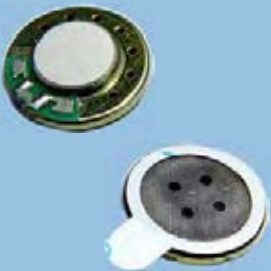

Parameter	Data	Specifications	Unit
Impedance At 1KHz		150 ± 15%	Ω
Sensitivity At 1KHz /100mV/0dB=20 μ Pa)		107 ± 3	dB
Operating Power (Nom/Max)		10/30	mW
Total Harmonic Distortion At 1KHz/ Nom. Power		MAX. 5	%
Buzz & Rattles		1.22V at 300 ~ 3.4kHz	Sine wave
Weight		1.2 ± 0.2	gr

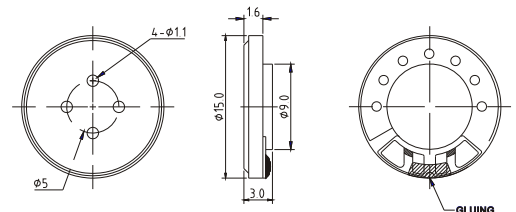
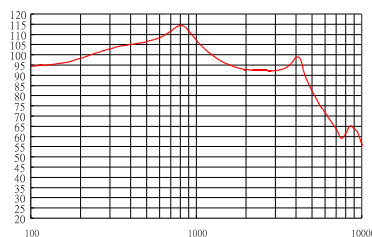

Specifications For Receiver & Speaker

SSR-1027-08W-01

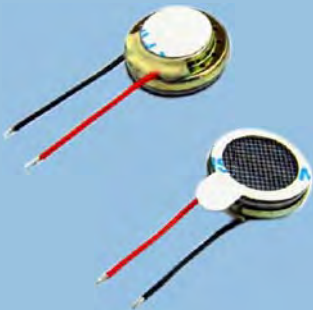

Parameter	Data	Specifications	Unit
Impedance At 1kHz		$8 \pm 20\%$	Ω
Sensitivity/(0dB=20 μ Pa) Avg 0.8, 1, 1.2, 1.5kHz/0.1W.0.1M		82 ± 3	dB
Operating Power (Nom/Max)		0.2/0.3	W
Resonance frequency(Fo)		$1500 \pm 20\%$	Hz
Total Harmonic Distortion At 2kHz/ Nom. Power		MAX. 5	%
Buzz & Rattles		1.3V at Fo ~ 20kHz	Sine wave

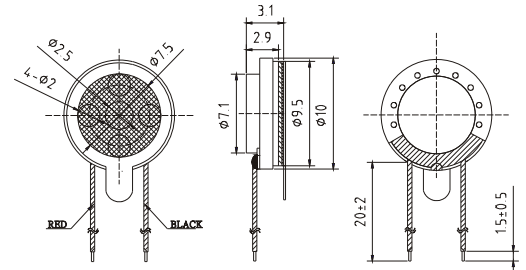
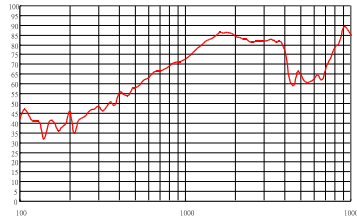

SSR-1326-08W-01

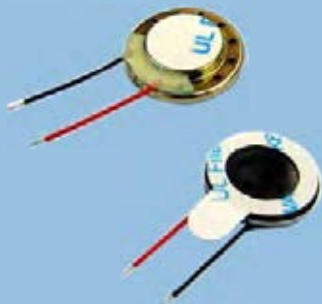

Parameter	Data	Specifications	Unit
Impedance At 1kHz		$8 \pm 20\%$	Ω
Sensitivity/(0dB=20 μ Pa) Avg 0.8, 1, 1.2, 1.5kHz/0.1W.0.1M		79 ± 3	dB
Operating Power (Nom/Max)		0.5/0.8	W
Resonance frequency(Fo)		$1500 \pm 20\%$	Hz
Total Harmonic Distortion At 2kHz/ Nom. Power		MAX. 5	%
Buzz & Rattles		2V at Fo ~ 20kHz	Sine wave

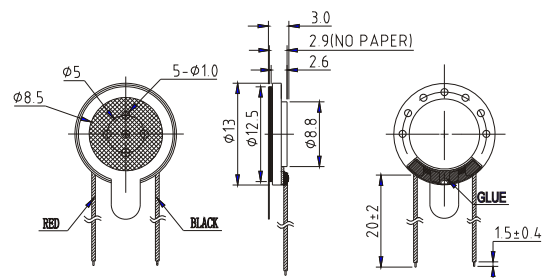
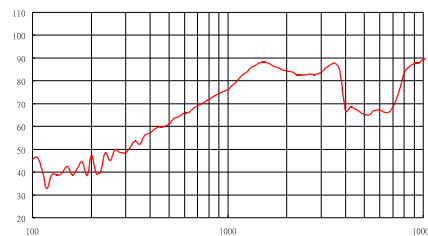

SSR-1530-08W-01

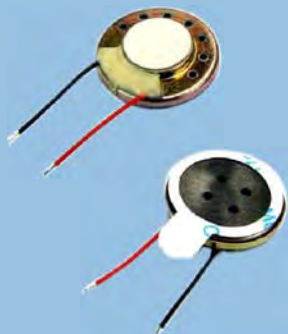

Parameter	Data	Specifications	Unit
Impedance At 1kHz		$8 \pm 20\%$	Ω
Sensitivity/(0dB=20 μ Pa) Avg 0.8, 1, 1.2, 1.5kHz/0.1W.0.1M		84 ± 3	dB
Operating Power (Nom/Max)		0.5/1.0	W
Resonance frequency(Fo)		$850 \pm 20\%$	Hz
Total Harmonic Distortion At 2kHz/ Nom. Power		MAX. 5	%
Buzz & Rattles		2V at Fo ~ 20kHz	Sine wave

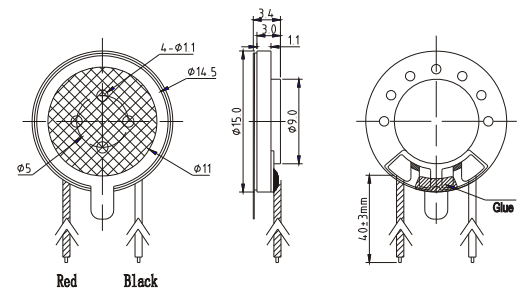
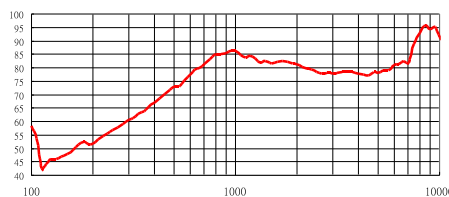

Specifications For Receiver & Speaker

SSR-1532-08P-01



Parameter	Data	Specifications	Unit
Impedance At 1KHz		$8 \pm 15\%$	Ω
Sensitivity/(0dB=20 Pa) Avg 0.8, 1, 1.2, 1.5KHz / 0.1W.0.1M		88 ± 3	dB
Operating Power (Nom/Max)		0.3/0.5	W
Resonance frequency(Fo)		$1100 \pm 20\%$	Hz
Total Harmonic Distortion At 2KHz/ Nom. Power		MAX. 5	%
Buzz & Rattles		1.57V at Fo ~ 20KHz	Sine wave

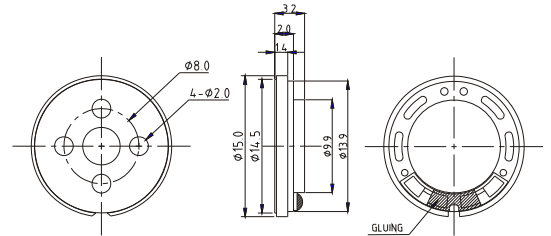
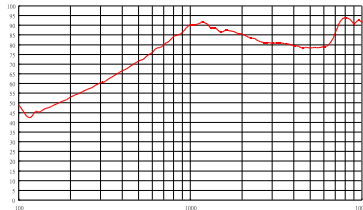

SSR-1735-08P-01

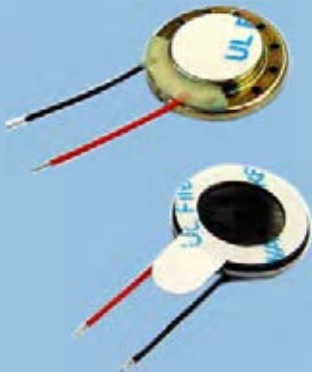

Parameter	Data	Specifications	Unit
Impedance At 1KHz		$8 \pm 15\%$	Ω
Sensitivity/(0dB=20 Pa) Avg 0.8, 1, 1.2, 1.5KHz / 0.1W.0.1M		86 ± 3	dB
Operating Power (Nom/Max)		0.3/0.8	W
Resonance frequency(Fo)		$850 \pm 20\%$	Hz
Total Harmonic Distortion At 2KHz/ Nom. Power		MAX. 1	%
Buzz & Rattles		1.55V / Fo ~ 7kHz	Sine wave

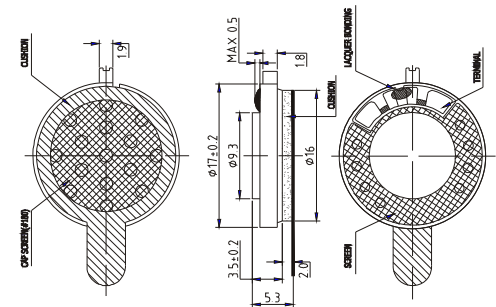
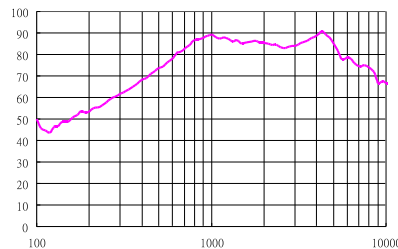

SSO-2435-08P-01



Parameter	Data	Specifications	Unit
Impedance At 1KHz		$8 \pm 20\%$	Ω
Sensitivity/(0dB=20 Pa) Avg 0.8, 1, 1.2, 1.5KHz / 0.1W.0.1M		86 ± 3	dB
Operating Power (Nom/Max)		0.3/0.5	W
Resonance frequency(Fo)		$850 \pm 20\%$	Hz
Total Harmonic Distortion At 2KHz/ Nom. Power		MAX. 5	%
Buzz & Rattles		1.55V at Fo ~ 20kHz	Sine wave

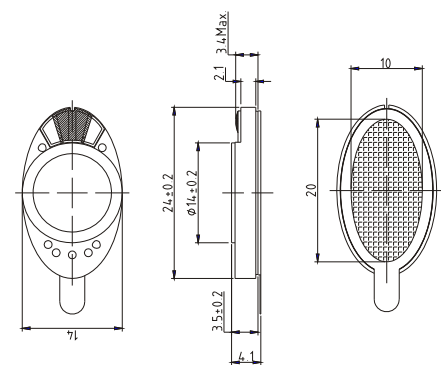
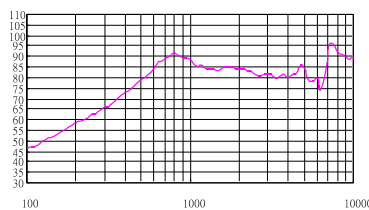

Specifications For Receiver & Speaker

SDR-1533-08W-01(2 in 1)

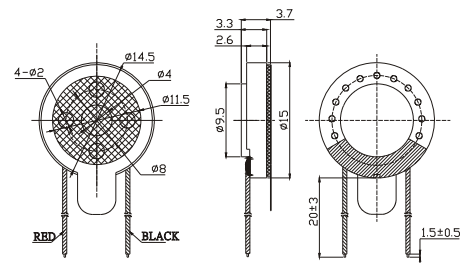
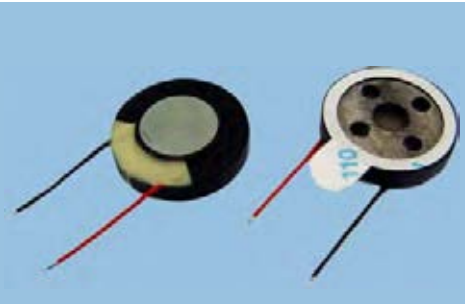

Receiver function

Parameter	Data	Specifications	Unit
Impedance At 1.5KHz		$8 \pm 15\%$	Ω
Sensitivity At 1KHz /100mV/0dB=20 μ Pa		120 ± 3	dB
Operating Power (Nom/Max)		10/30	mW
Total Harmonic Distortion At 1KHz/ Nom. Power		MAX. 5	%
Buzz & Rattles		0.28V at 300 ~ 3.4kHz	Sine wave
Weight		1.1 ± 0.2	gf

Receiver model

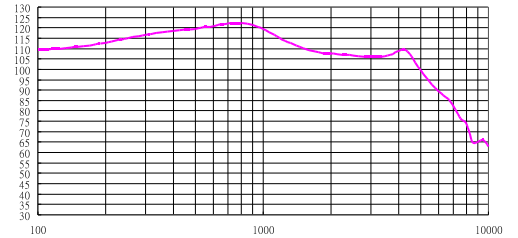

Speaker function

Parameter	Data	Specifications	Unit
Impedance At 1.5KHz		$8 \pm 20\%$	Ω
Sensitivity/(0dB=20 μ Pa) Avg 0.8, 1, 1.2, 1.5KHz /0.1W.0.1M		88 ± 3	dB
Operating Power (Nom/Max)		0.5/0.8	W
Resonance frequency(Fo)		$850 \pm 20\%$	Hz
Total Harmonic Distortion At 1.5KHz/ Nom. Power		MAX. 5	%
Buzz & Rattles		2V at Fo ~ 20kHz	Sine wave

Speaker model

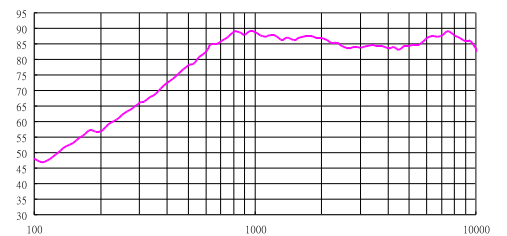

SDR-1538-08032W-01(2 in 1)

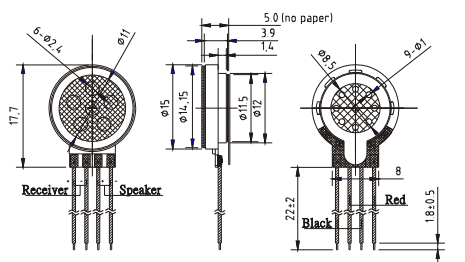
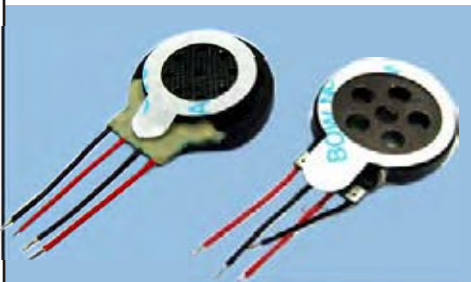

Receiver function

Parameter	Data	Specifications	Unit
Impedance At 1KHz		$32 \pm 15\%$	Ω
Sensitivity At 1KHz /100mV/0dB=20 μ Pa		105 ± 3	dB
Operating Power (Nom/Max)		10/30	mW
Total Harmonic Distortion At 1KHz/ Nom. Power		MAX. 5	%
Buzz & Rattles		0.57V at 300 ~ 3.4kHz	Sine wave
Weight		1.5 ± 0.2	gf

Receiver model

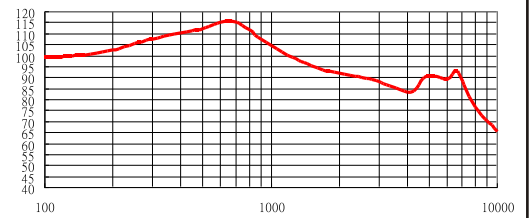

Speaker function

Parameter	Data	Specifications	Unit
Impedance At 1KHz		$8 \pm 15\%$	Ω
Sensitivity/(0dB=20 μ Pa) Avg 0.8, 1, 1.2, 1.5KHz /0.1W.0.1M		84 ± 3	dB
Operating Power (Nom/Max)		0.5/0.8	W
Resonance frequency(Fo)		$1000 \pm 20\%$	Hz
Total Harmonic Distortion At 1.5KHz/ Nom. Power		MAX. 5	%
Buzz & Rattles		2V at Fo ~ 20kHz	Sine wave

Speaker model

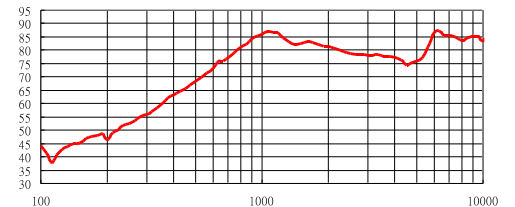

Specifications For Receiver & Speaker

SDR-1634-08P-01(2 in 1)

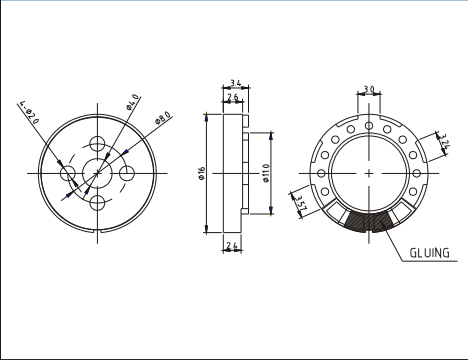
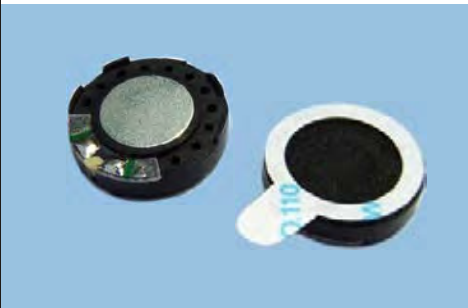

Receiver function

Parameter	Data	Specifications	Unit
Impedance At 1KHz		8 ± 15%	Ω
Sensitivity At 1KHz /100mV/0dB=20 μ Pa)		120 ±3	dB
Operating Power (Nom/Max)		10/30	mW
Total Harmonic Distortion At 1KHz/ Nom. Power		MAX. 5	%
Buzz & Rattles		0.28V at 300 ~ 3.4KHz	Sine wave
Weight		1.1 ± 0.2	gf

Receiver model

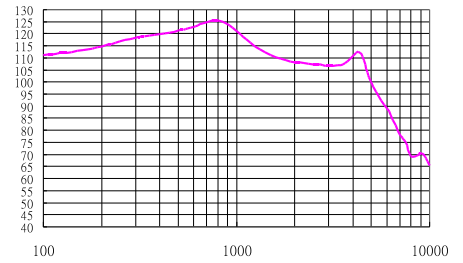

Speaker function

Parameter	Data	Specifications	Unit
Impedance At 1KHz		8 ± 20%	Ω
Sensitivity/(0dB=20 μPa) Avg 0.5, 1, 1.2, 1.5KHz /0.1W/0.1M		90 ± 3	dB
Operating Power (Nom/Max)		0.3/0.5	W
Resonance frequency(Fo)		900 ± 20%	Hz
Total Harmonic Distortion At 1.5KHz/ Nom. Power		MAX. 5	%
Buzz & Rattles		1.55V at Fo ~ 20KHz	Sine wave

Speaker model

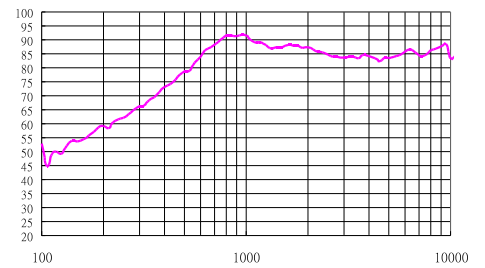

SDR-1635-08W-01(2 in 1)

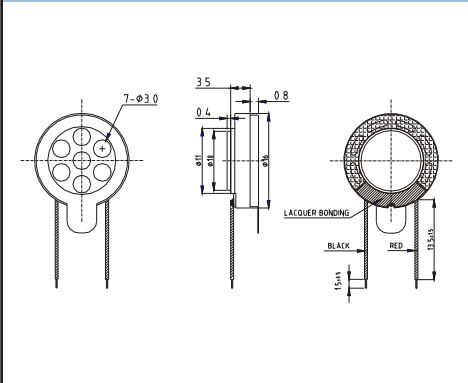
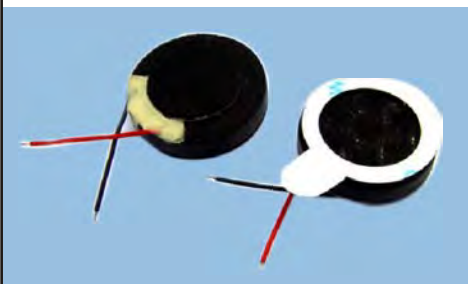

Receiver function

Parameter	Data	Specifications	Unit
Impedance At 1KHz		8 ± 15%	Ω
Sensitivity At 1KHz /100mV/0dB=20 μ Pa)		117 ±3	dB
Operating Power (Nom/Max)		10/30	mW
Total Harmonic Distortion At 1KHz/ Nom. Power		MAX. 5	%
Buzz & Rattles		0.28V at 300 ~ 3.4KHz	Sine wave
Weight		1.1 ± 0.2	gf

Receiver model

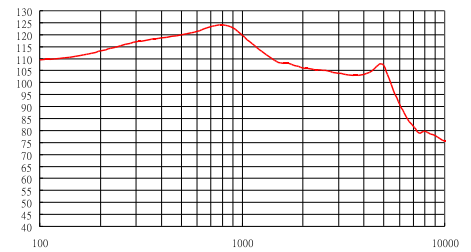

Speaker function

Parameter	Data	Specifications	Unit
Impedance At 1.5KHz		8 ± 15%	Ω
Sensitivity/(0dB=20 μPa) Avg 0.5, 1, 1.2, 1.5KHz /0.1W/0.1M		87 ± 3	dB
Operating Power (Nom/Max)		0.5/0.7	W
Resonance frequency(Fo)		850 ± 20%	Hz
Total Harmonic Distortion At 1.5KHz/ Nom. Power		MAX. 5	%
Buzz & Rattles		2.0V at Fo ~ 20KHz	Sine wave

Speaker model

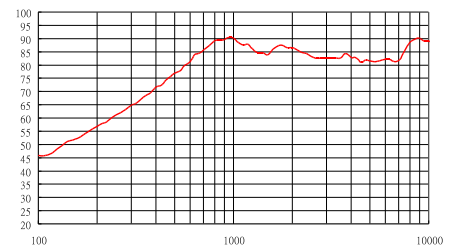



GREEN POWER
GROUP



TAIWAN OFFICE
TACHIMA TECH. CORP.

No. 2-6, Alley 16, Lane 337, Sec. 1, Ta-Tung Rd.
Hsi Chin City, Taipei Hsien, 221, Taiwan, R.O.C.
Tel : +886-2-2648-8800
Fax : +886-2-2647-5566
E-mail : gpgroup@gpgroup.com.tw
[Http://www.tachima.com.tw](http://www.tachima.com.tw)

CHINA OFFICE
TACHIMA TECH. CORP.

3F, No.22, King Ho 1 Rd., King Mei Village, Chang Ping Town
Dong Guan, 523579, China
Tel : +86-769-3993361 +86-769-3993362
Fax: +86-769-3993661
E-mail: china@gpgroup.com.tw

JAPAN OFFICE
INDES JAPAN CO., LTD.

4-25-6 Wakakusa, Utsunomiya, Tochigi 302-0072 JAPAN
Tel : +81-28-643-2040
Fax: +81-28-643-1432
E-mail : indes@topaz.ocn.ne.jp